



Pyle Close, Addlestone, KT15 2FF





A recently improved three bedroom house in central located, well located within a quarter of a mile of the mainline train line station and the town centre.

This modern home has been redecorated and re-carpeted throughout and comprises a large living room with doors out onto a private garden, modern fitted kitchen and downstairs WC. To the first floor, there are two bedrooms and a family bathroom with shower over bath. The top floor boasts the master bedroom with ample storage and an ensuite shower room. There is also an allocated parking space. Offered unfurnished.



Ground Floor



First Floor

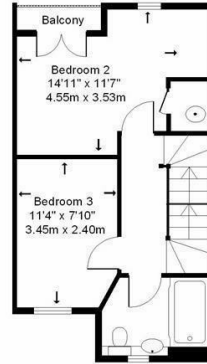

Second Floor



Approximate Gross Internal Floor Area:
101m sq (1,086sq ft)

Whilst every attempt has been made to ensure the accuracy of this floor plan, room sizes and measurements are approximate and accordingly should not be relied upon for carpets and furnishings. These plans are for representation purposes only and no responsibility can be given for errors and omissions.

© Drawing Rooms 2015

Not to scale



EPC Rating: 84 B





Grants Homes 60 Church Street, Weybridge, Surrey, KT13 8DL
T: 01932 841020 E: lettings@grantshomes.co.uk