



89, Wolverhampton Road South, Quinton, Birmingham, B32 2AY

£275,000

- TRADITIONAL SEMI DETACHED HOUSE
 - TWO RECEPTION ROOMS
 - THREE BEDROOMS
- DOWNSTAIRS W.C & FIRST FLOOR W.C & BATHROOM
- DELIGHTFUL, EXTENSIVE REAR GARDEN
- IN NEED OF SOME UPGRADING IN PLACES BUT LOTS OF POTENTIAL
- CONVENIENT FOR BUS ROUTES INTO BIRMINGHAM CITY CENTRE & HARBORNE
 - CLOSE TO SHOPS & AMENITIES
 - NO UPWARD CHAIN

All Buildings Great & Small



RICS
Regulated by RICS

arla naea
propertymark



intertek
ISO 9001:2015



UKAS
MANAGEMENT
SYSTEMS
014

OnTheMarket

rightmove



An opportunity to acquire a well proportioned traditional style three bedroom semi-detached house with delightful extensive rear garden. Whilst the property requires some modernisation and improvement it has the potential to become a fantastic family home.

Enclosed porch, reception hall, cloaks cupboard, dining room, lounge, kitchen, utility/lobby incorporating w.c., landing, three bedrooms, bathroom/w.c., garage, delightful extensive rear garden. Gas boiler serving radiators. Double glazing to windows as detailed.

ACCOMMODATION

ENCLOSED PORCH (FRONT):

Sliding double glazed door, tiled floor finish, front door with leaded light panel opening onto:

RECEPTION HALL (INNER):

Panel radiator, staircase leading off to first floor landing.

CLOAKS CUPBOARD (FRONT):

Leaded light window onto porch, coat hooks, gas meter.

DINING ROOM (FRONT): 3.34m max. (2.98m min.) x 3.80m plus bay (4.49m max. into bay)
Coving to ceiling, panel radiator, multi-panel double glazed window.

LOUNGE (REAR): 3.33m max. (2.99m min.) x 4.82m
Coving to ceiling, panel radiator, wall mounted gas fire, sliding double glazed patio door onto rear garden.

KITCHEN (REAR): 2.87m x 3.50m plus pantry
Panel radiator, strip light to ceiling, base units with cupboards and drawers, worktops, single bowl single drainer stainless steel sink with mixer tap, cooker, four ring gas hob, cooker hood above, tiled splashbacks, wall mounted storage cupboards at high level, cooker hood above hob. Pantry with shelving and single glazed window onto garage.

UTILITY/LOBBY (SIDE):

Wall mounted gas boiler, worktop, single glazed door onto rear garden.

W.C.:

W.C. with low level flush, single glazed window to rear.

Staircase from ground floor reception hall leading off to first floor accommodation:-

LANDING (INNER/SIDE):

Leaded light window to side, doors off.

BEDROOM 1 (REAR): 4.83m max. into bay x 2.99m (3.36m into wardrobe)
Double glazed bay window, panel radiator, fitted wardrobes.

BEDROOM 2 (FRONT): 3.78m plus bay x 2.97m min. (3.34m max.)
Multi-paned double glazed window, panel radiator, fitted

wardrobes.

BEDROOM 3 (FRONT): 2.68m x 1.97m
Multi-panel double glazed window, panel radiator, access to roof space.

BATHROOM (INCORPORATING W.C.):

Comprising:

W.C. (SIDE):

W.C. with push button flush, walls tiled to approximately half wall height, double glazed window to side.

BATHROOM:

Panel radiator, obscure double glazed window, towel rail, pedestal wash hand basin, panel bath with shower attachment, shower curtain rail, cupboard housing hot water cylinder.

Outside:-

REAR GARDEN:

The property enjoys the benefit of a delightful extensive westerly facing rear garden with sunny aspect. A patio area leads onto shaped lawn, borders stocked with a variety of shrubs, plants and trees, garden pond, garden shed to top of garden, outside tap, small log store.

GARAGE (SIDE): 2.19m min. (2.43m max.) x 5.87m
(Agents Note: The garage tapers in width and therefore may not be suitable some cars).
Garage door to front.

COUNCIL TAX BAND C

TENURE:

We are verbally advised the property is freehold. The Agent has not checked the legal documents to verify the freehold status of the property. The buyer is advised to obtain verification from their Solicitor or Surveyor.

SERVICES

The Agents have not tested any apparatus, equipment, fixtures, fittings or services and so cannot verify they are in working order or fit for their purpose. The buyer is advised to obtain verification from their Solicitor or Surveyor.

FIXTURES AND FITTINGS

All items unless specifically referred to in these sales particulars are expressly excluded from the proposed sale. However, fitted carpets, curtains and certain other items may be taken at a valuation to be agreed.

Extra Services & AML

Money Laundering Regulations –

In order to comply with Money Laundering Regulations, all prospective purchasers are required to provide the following - 1. Satisfactory photographic identification. 2. Proof of address/residency. 3. Verification of the source of purchase funds including bank statements for deposits in order to purchase and copy of mortgage agreement in principle from the appropriate lender. In the absence of being able to provide appropriate physical copies of the

above, Scriven & Co reserves the right to obtain electronic verification of identity.

Extra services -

By law, the agent must tell the client if the agent or any connected person intends to earn any commission or any other fees from offering or referring other services to the client or buyer. If the agent or any connected person earns money from any of these services or referrals the agent or the connected person would keep this commission or fee. Part of the payment for these extra services will be paid to the agent as a result of the referral.

Scriven & Co offers the following services and has the following referral arrangements in place:

Scriven & Co routinely refers sellers (and buyers) to Infinity Financial Advice. It is the clients' or buyers' decision whether to choose to deal with Infinity Financial Advice.

Should the client or a buyer decide to use Infinity Financial Advice the client or buyer should know that Scriven & Co receive a payment from Infinity Financial Advice equating on average to a figure in the order of £200 per referral.

Scriven & Co routinely refers sellers (and buyers) to certain firms of solicitors/conveyancers. It is the clients' or buyers' decision whether to choose to deal with any of the referral companies. Should the client or a buyer decide to use any of these companies the client or buyer should know that Scriven & Co receive a payment from these companies equating to a figure in the order of £100-£200 per referral. We are informed that the solicitors/conveyancers are happy to pay this referral fee to ourselves as it significantly reduces the marketing costs that they have to allocate to sourcing new business. The referral fee is NOT added to the conveyancing charges that would ordinarily be quoted.

The agent routinely refers sellers (and buyers) to Warren's removals and storage. It is the clients' or buyers' decision whether to choose to deal with Warren's removals and storage. Should the client or a buyer decide to use Warren's removals and storage the client or a buyer should know that the agent receives a referral fee to the value of £50 from them for recommending a client or buyer to them.

Property Information Links

Useful links for property information:

Find information about a property in England or Wales:

<https://search-property-information.service.gov.uk>

Mobile and broadband checker: If mobile coverage and broadband speed is an important issue we would suggest

checking with: <https://checker.ofcom.org.uk>

Flooding: If you wish to check flooding information in respect of the property, the following may be of assistance: <https://www.gov.uk/request-flooding-history>

Long term flood risk check of an area in England: <https://www.gov.uk/check-long-term-flood-risk>

Service provider information: we would suggest the following:

Gas supply:

<https://www.ofgem.gov.uk/information-consumers/energy-advice-households/finding-your-energy-supplier-or-network-operator>

<https://www.findmysupplier.energy>

Electric supply:

<https://www.energynetworks.org/customers/find-my-network-operator>

<https://www.nationalgrid.co.uk>

Water supplier:

<https://www.ofwat.gov.uk/households/your-water-company>

<https://www.water.org.uk/customers/find-your-supplier>

Consumer code for house builders:

<https://consumercode.co.uk>

Important notices

The Consumer Protection from Unfair Trading Regulations 2008 and the Business Protection from Misleading Marketing Regulations 2008 : Nothing concerning the type of construction or the condition of the structure is to be implied from the photograph (or artists impression) of the property. Items shown in photographs are NOT included unless specifically mentioned within the sales particulars. Certain items may however be available by separate negotiation. The measurements supplied are for general guidance, and as such must be considered as incorrect. A buyer is advised to re-check the measurements themselves before committing themselves to any expense. The Agent has not tested any apparatus, equipment, fixtures, fittings or services, and so does not verify they are in working order, fit for their purpose, or within ownership of the sellers, therefore the buyer must assume the information given is incorrect. Neither has the Agent checked the legal documentation to verify legal status of the property or validity of any guarantee. A buyer must assume the information is incorrect, until it has been verified by their own solicitors. The sales particulars may change in the course of time, and any interested party is advised to make final inspection of the property prior to exchange of contracts. A buyer must check the availability of any property and make an appointment to view before embarking on any journey to see a property. References to the Tenure of a Property are based on information supplied by the Seller. The Agent has not had sight of the title documents. A Buyer is advised to obtain verification from their Solicitor. Any reference to alterations to, or use of any part of the property, is not a statement that any necessary planning, building regulation or other consent has been obtained. A buyer must assume the information is incorrect until it has been verified by their own solicitors.

VAT: All figures quoted are exclusive of VAT where applicable. **Rating Assessments** : Where provided the Agent has made a verbal enquiry with the Local Authority and this information should be verified by interested parties making their own enquiries.

Misrepresentation Act 1967 : These details are prepared as a general guide only, and should not be relied upon as a basis to enter into a legal contract, or to commit expenditure. An interested party should consult their own surveyor, solicitor or other professionals before committing themselves to any expenditure or other legal commitments. If any interested party wishes to rely upon any information from the Agent, then a request should be made and specific written confirmation can be provided. The Agent will not be responsible for any verbal statement made by any member of staff, as only a specific written confirmation should be relied upon. The Agent will not be responsible for any loss other than when specific written confirmation has been requested. (REV02:10/13).







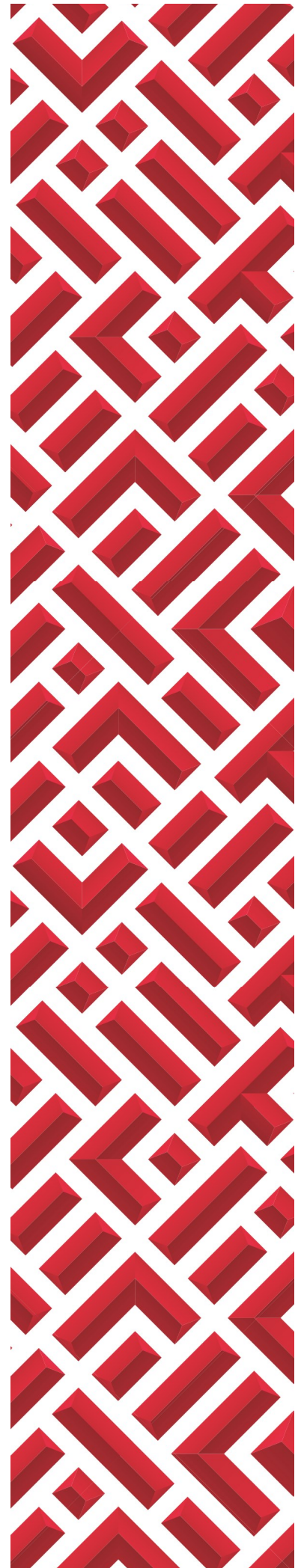

Ground Floor

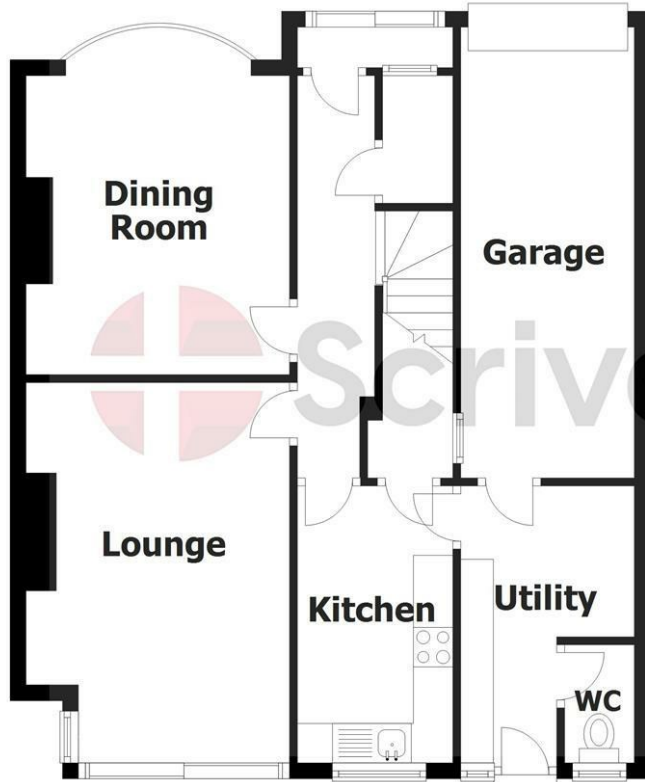

First Floor

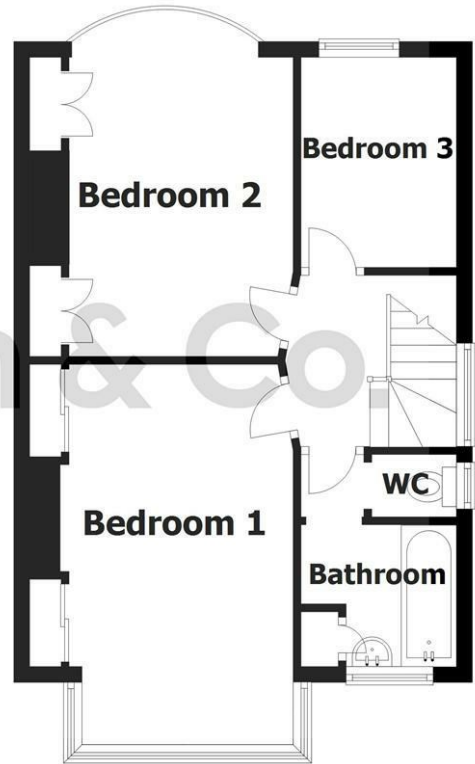

This plan is for layout guidance only and not drawn to scale unless stated. Window and door openings are approximate. Whilst every care is taken in preparation of this plan, please check all dimensions and shapes before making any decisions reliant upon them. Plan produced using PlanUp.



- Estate House, 821 Hagley Road West, Quinton, Birmingham, B32 1AD
- Tel: 0121 422 4011
- E-mail: quinton@scriven.co.uk
- www.scriven.co.uk
- Regulated By RICS

Energy Efficiency Rating		
	Current	Potential
Very energy efficient - lower running costs		
(92 plus) A		
(81-91) B		85
(69-80) C		
(55-68) D	61	
(39-54) E		
(21-38) F		
(1-20) G		
Not energy efficient - higher running costs		
England & Wales	EU Directive 2002/91/EC	

Property Reference: 18616858