



109, Old College Avenue, Oldbury, B68 8BF

Offers In The Region Of £220,000

- ATTRACTIVE SEMI DETACHED HOUSE
- CONVENIENTLY SITUATED FOR ACCESS ONTO THE WOLVERHAMPTON ROAD
 - TWO BEDROOMS
 - LIVING ROOM AND DINING ROOM
- DOWNSTAIRS W.C AND FIRST FLOOR BATHROOM
 - DRIVEWAY PARKING TO SIDE
 - ENCLOSED REAR GARDEN
 - NO UPWARD CHAIN

All Buildings Great & Small



RICS
Regulated by RICS

arla naea
propertymark



intertek
ISO 9001:2015



OnTheMarket rightmove



An attractive two bedroom semi detached house with living room and dining room conveniently situated for access onto the Wolverhampton Road. NO UPWARD CHAIN.

Reception hall, downstairs w.c, kitchen, living room, dining room, two bedrooms, bathroom, enclosed garden, driveway parking. Gas boiler serving radiators, double glazing to windows as specified.

The accommodation is planned on two floors and comprises on the ground floor:-

CANOPY PORCH (FRONT)

RECEPTION HALL (INNER)

Front door with inset obscure glazed double glazed panels, panelled radiator, staircase leading to first floor accommodation.

DOWNSTAIRS W.C (SIDE)

W.C. with low level cistern, pedestal wash-hand basin with tiled splashback, tile finish to floor, panelled radiator, double glazed window to front elevation.

KITCHEN (Front) 1.77m x 3.26m

Furnished with range of units including L shaped laminate work surface with three tier drawer unit beneath, storage cupboard, built in 'Indesit' dishwasher and concealed recess with plumbing for washing machine. Inset one and a half bowl single drainer stainless steel sink with mixer tap and inset 'Hotpoint' four ring gas hob with 'Hotpoint' electric under oven, stainless steel finish, 'Hotpoint' cooker hood over hob unit, two wall cupboards, built in fridge/freezer, further cupboard concealing 'Potterton' gas fired combination boiler, recessed spotlighting to ceiling, tiled floor finish.

LIVING ROOM (Rear) 3.89m max (2.78m min) x 3.84m
Storage cupboard opening off beneath staircase, panelled radiator, double glazed double doors leading through to:

DINING ROOM (Rear) 3.31m x 2.73m

Double glazed windows to three elevations, double glazed double doors to outside, two double glazed roof lights, recessed spotlighting to ceiling, wall-mounted electric panel heater, wall mounted 'Comfyair' air conditioning unit, wood effect laminate finish to floor.

AGENTS NOTE- THE VENDORS HAVE ADVISED THAT THE FORMER CONSERVATORY WAS ADDED CIRCA 2015. THE CONSERVATORY GLASS ROOF WAS CHANGED IN 2020.

First floor accommodation:-

CENTRAL LANDING (INNER/SIDE)

Doors leading to:

BEDROOM ONE (Front) 3.23m x 2.98m plus recess 0.68m x 0.86m

Panelled radiator, two double glazed windows to front elevation, hatchway giving access to roof space. Built in wardrobe with fitted shelf and hanging rail.

BEDROOM TWO (Rear) 3.92m x 2.16m
Panelled radiator, double glazed window to rear.

BATHROOM (Side) 1.68m x 1.89m

Panelled bath with mixer tap and shower attachment, wall mounted mixer shower, W.C. with low level cistern, pedestal wash-hand basin with mixer tap, chrome finish heated towel radiator, walls tiled to half height with bath area fully tiled in complementary ceramics, double glazed window to side elevation, recessed spotlighting to ceiling, extractor fan.

OUTSIDE

ENCLOSED GARDEN

Paved patio area with lawn area to rear, paved pathway to side with pedestrian gate leading from front.

COUNCIL TAX BAND - C

AGENTS NOTE - There is a service charge of approximately £117.72 per annum to cover the maintenance of grassed area and hedging around estate perimeter.

TENURE

We are verbally advised that the property is freehold, however the Agent has not checked the legal documents to verify the freehold status of the property. The buyer is advised to obtain verification from their Solicitor or Surveyor.

SERVICES

The Agents have not tested any apparatus, equipment, fixtures, fittings or services and so cannot verify they are in working order or fit for their purpose. The buyer is advised to obtain verification from their Solicitor or Surveyor.

FIXTURES AND FITTINGS

All items unless specifically referred to in these sales particulars are expressly excluded from the proposed sale. However, fitted carpets, curtains and certain other items may be taken at a valuation to be agreed.

Money Laundering Regulations –

In order to comply with Money Laundering Regulations, all prospective purchasers are required to provide the following - 1. Satisfactory photographic identification. 2. Proof of address/residency. 3. Verification of the source of purchase funds including bank statements for deposits in order to purchase and copy of mortgage agreement in principle from the appropriate lender. In the absence of being able to provide appropriate physical copies of the above, Scriven & Co reserves the right to obtain electronic verification of identity.

Extra services -

By law, the agent must tell the client if the agent or any connected person intends to earn any commission or any other fees from offering or referring other services to the client or buyer. If the agent or any connected person earns money from any of these services or referrals the agent or the connected person would keep this commission or fee. Part of the payment for these extra services will be paid to

the agent as a result of the referral.

Scriven & Co offers the following services and has the following referral arrangements in place:

Scriven & Co routinely refers sellers (and buyers) to Infinity Financial Advice. It is the clients' or buyers' decision whether to choose to deal with Infinity Financial Advice. Should the client or a buyer decide to use Infinity Financial Advice the client or buyer should know that Scriven & Co receive a payment from Infinity Financial Advice equating on average to a figure in the order of £200 per referral.

Scriven & Co routinely refers sellers (and buyers) to certain firms of solicitors/conveyancers. It is the clients' or buyers' decision whether to choose to deal with any of the referral companies. Should the client or a buyer decide to use any of these companies the client or buyer should know that Scriven & Co receive a payment from these companies equating to a figure in the order of £100-£200 per referral. We are informed that the solicitors/conveyancers are happy to pay this referral fee to ourselves as it significantly reduces the marketing costs that they have to allocate to sourcing new business. The referral fee is NOT added to the conveyancing charges that would ordinarily be quoted.

The agent routinely refers sellers (and buyers) to Warren's removals and storage. It is the clients' or buyers' decision whether to choose to deal with Warren's removals and storage. Should the client or a buyer decide to use Warren's removals and storage the client or a buyer should know that the agent receives a referral fee to the value of £50 from them for recommending a client or buyer to them.



Important notices

The Consumer Protection from Unfair Trading Regulations 2008 and the Business Protection from Misleading Marketing Regulations 2008 : Nothing concerning the type of construction or the condition of the structure is to be implied from the photograph (or artists impression) of the property. Items shown in photographs are NOT included unless specifically mentioned within the sales particulars. Certain items may however be available by separate negotiation. The measurements supplied are for general guidance, and as such must be considered as incorrect. A buyer is advised to re-check the measurements themselves before committing themselves to any expense. The Agent has not tested any apparatus, equipment, fixtures, fittings or services, and so does not verify they are in working order, fit for their purpose, or within ownership of the sellers, therefore the buyer must assume the information given is incorrect. Neither has the Agent checked the legal documentation to verify legal status of the property or validity of any guarantee. A buyer must assume the information is incorrect, until it has been verified by their own solicitors. The sales particulars may change in the course of time, and any interested party is advised to make final inspection of the property prior to exchange of contracts. A buyer must check the availability of any property and make an appointment to view before embarking on any journey to see a property. References to the Tenure of a Property are based on information supplied by the Seller. The Agent has not had sight of the title documents. A Buyer is advised to obtain verification from their Solicitor. Any reference to alterations to, or use of any part of the property, is not a statement that any necessary planning, building regulation or other consent has been obtained. A buyer must assume the information is incorrect until it has been verified by their own solicitors.

VAT : All figures quoted are exclusive of VAT where applicable. **Rating Assessments** : Where provided the Agent has made a verbal enquiry with the Local Authority and this information should be verified by interested parties making their own enquiries.

Misrepresentation Act 1967 : These details are prepared as a general guide only, and should not be relied upon as a basis to enter into a legal contract, or to commit expenditure. An interested party should consult their own surveyor, solicitor or other professionals before committing themselves to any expenditure or other legal commitments. If any interested party wishes to rely upon any information from the Agent, then a request should be made and specific written confirmation can be provided. The Agent will not be responsible for any verbal statement made by any member of staff, as only a specific written confirmation should be relied upon. The Agent will not be responsible for any loss other than when specific written confirmation has been requested. (REV02:10/13).

Ground Floor

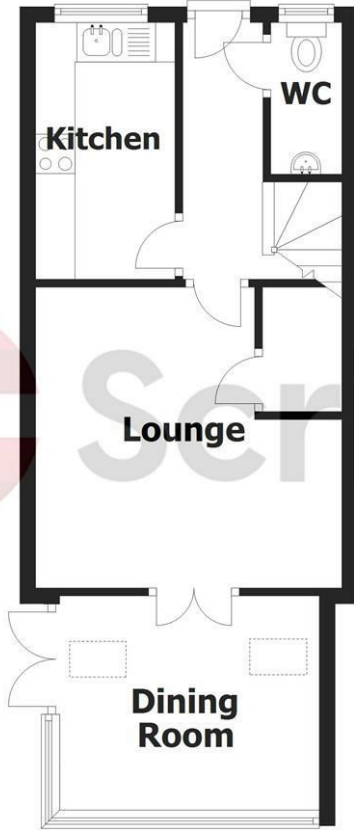

First Floor



This plan is for layout guidance only and not drawn to scale unless stated. Window and door openings are approximate. Whilst every care is taken in preparation of this plan, please check all dimensions and shapes before making any decisions reliant upon them. Plan produced using PlanUp.

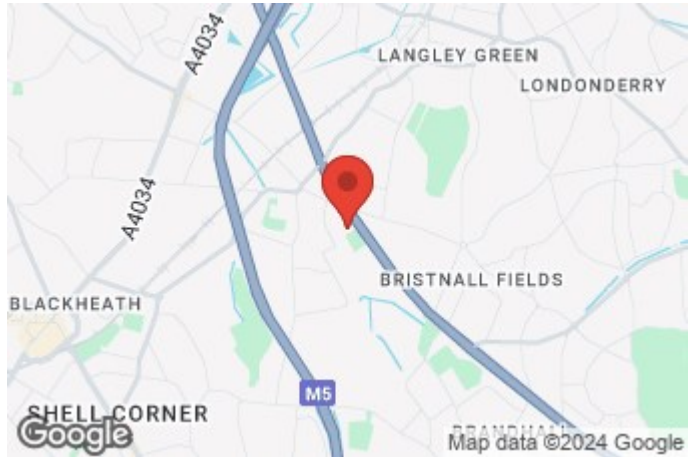

- Estate House, 821 Hagley Road West, Quinton, Birmingham, B32 1AD
- Tel: 0121 422 4011
- E-mail: quinton@scriven.co.uk
- www.scriven.co.uk
- Regulated By RICS

Energy Efficiency Rating		
	Current	Potential
<i>Very energy efficient - lower running costs</i>		
(92 plus) A		91
(81-91) B		
(69-80) C	75	
(55-68) D		
(39-54) E		
(21-38) F		
(1-20) G		
<i>Not energy efficient - higher running costs</i>		
England & Wales	EU Directive 2002/91/EC	