



Slatch House Road, Smethwick, West Midlands, B67 5QD

Offers In The Region Of £235,000

All Buildings Great & Small



RICS
Regulated by RICS

arla naea
propertymark



intertek
ISO 9001:2015



UKAS
MANAGEMENT
SYSTEMS
014

OnTheMarket rightmove



An opportunity to acquire an extended three-bedroom end terrace house with off road parking. The property offers flexible accommodation as it benefits from both first floor bathroom and additional ground floor wet room.

Accommodation: entrance hall, kitchen/breakfast room, utility, lobby, living room, dining room/potential ground floor bedroom, ground floor shower/wet room, landing, three bedrooms, bathroom, gas boiler serving radiators, double glazing to windows as specified, rear garden.

ENCLOSED HALL: (Inner)

Panel radiator, staircase off to first floor landing with handrails, door opening onto :

LIVING ROOM: (Front) 4.26m max 3.88m to chimney breast x 3.64m

Panel radiator, double glazed window to front. Sliding door onto dining room/potential ground floor bedroom. Door opening onto :

UTILITY: (Inner) 2.0m x 3.0m

Panel radiator, strip light to ceiling, work surface area with space below for washing machine and condenser dryer, wall mounted storage cupboard at high level. Opening onto :

KITCHEN/BREAKFAST ROOM: (Rear) 2.28m x 3.20m

Double glazed sliding patio door onto rear garden, strip light to ceiling, wall mounted heater, panel radiator, kitchen fitted with a range of base units with cupboards and drawers, complementary worktops, single bowl single drainer sink with mixer tap, plumbing for washing machine, space for cooker.

LOBBY AREA: (Side) 1.18m x 2.16m

Sliding doors onto shower room/wet room and dining room/potential ground floor bedroom.

SHOWER ROOM/WET ROOM: (Rear) 2.17m x 1.87m

Panel radiator, obscure double glazed window, w.c. shower area with electric shower, wash hand basin, tiling to shower area. Door from lobby area onto garden.

DINING ROOM/POTENTIAL GROUND FLOOR

BEDROOM: 3.09m x 3.03m plus recess understairs
Double glazed window, panel radiator.

Stair case from ground floor reception hall leading off to:

FIRST FLOOR LANDING: (Inner/Side)

Obscure double glazed window to side. Doors radiating off.

BEDROOM ONE: (Front) 2.60m 2.21m plus door recess x 3.63m

Double glazed bay window, panel radiator, access to roof space.

BEDROOM TWO: (Rear) 3.04m x 2.71m plus recess

Double glazed window, panel radiator.

BEDROOM THREE: (Front) 2.67m x 2.54m (maximum measurements including bulk head of staircase). 2.67m (1.17m) x 2.54m (1.63m).

Double glazed window, panel radiator, storage cupboard over bulk head of staircase.

BATHROOM: (Rear) 2.41m x 2.11m max including store cupboard, obscure double glazed window, panel radiator, w.c, panel bath with electric shower over, wash hand basin, two wall tiled.

REAR GARDEN:

Patio area with steps down to low maintenance rear garden, fencing, garden shed. Outside tap. Pedestrian gate gives access to front.

COUNCIL TAX BAND B

TENURE:

We are verbally advised the property is freehold. The Agent has not checked the legal documents to verify the freehold status of the property. The buyer is advised to obtain verification from their Solicitor or Surveyor.

SERVICES:

The Agents have not tested any apparatus, equipment, fixtures, fittings or services and so cannot verify they are in working order or fit for their purpose. The buyer is advised to obtain verification from their Solicitor or Surveyor.

FIXTURES AND FITTINGS:

All items unless specifically referred to in these sales particulars are expressly excluded from the proposed sale. Carpets as fitted are included in the sale, curtains and certain other items may be taken at a valuation to be agreed.

VIEWING:

Strictly by prior appointment via agents.

MONEY LAUNDERING REGULATIONS:

In order to comply with Money Laundering Regulations, all prospective purchasers are required to provide the following - 1. Satisfactory photographic identification. 2. Proof of address/residency. 3. Verification of the source of purchase funds including bank statements for deposits in order to purchase and copy of mortgage agreement in principle from the appropriate lender. In the absence of being able to provide appropriate physical copies of the above, Scriven & Co reserves the right to obtain electronic verification of identity.

EXTRA SERVICES:

By law, the agent must tell the client if the agent or any connected person intends to earn any commission or any other fees from offering or referring other services to the client or buyer. If the agent or any connected person earns money from any of these services or referrals the agent or the connected person would keep this commission or fee. Part of the payment for these extra services will be paid to the agent as a result of the referral. Scriven & Co offers the following services and has the following referral arrangements in place:

Scriven & Co routinely refers sellers (and buyers) to Infinity Financial Advice. It is the clients' or buyers' decision

whether to choose to deal with Infinity Financial Advice. Should the client or a buyer decide to use Infinity Financial Advice the client or buyer should know that Scriven & Co receive a payment from Infinity Financial Advice equating on average to a figure in the order of £200 per referral.

Scriven & Co routinely refers sellers (and buyers) to certain firms of solicitors/conveyancers. It is the clients' or buyers' decision whether to choose to deal with any of the referral companies. Should the client or a buyer decide to use any of these companies the client or buyer should know that Scriven & Co receive a payment from these companies equating to a figure in the order of £100-£200 per referral. We are informed that the solicitors/conveyancers are happy to pay this referral fee to ourselves as it significantly reduces the marketing costs that they have to allocate to sourcing new business. The referral fee is NOT added to the conveyancing charges that would ordinarily be quoted.

The agent routinely refers sellers (and buyers) to Warren's removals and storage it is the clients' or buyers' decision whether to choose to deal with Warren's removals and storage. Should the client or a buyer decide to use Warren's removals and storage the client or a buyer should know that the agent receives a referral fee to the value of £50 from them for recommending a client or buyer to them.



Important notices

The Consumer Protection from Unfair Trading Regulations 2008 and the Business Protection from Misleading Marketing Regulations 2008 : Nothing concerning the type of construction or the condition of the structure is to be implied from the photograph (or artists impression) of the property. Items shown in photographs are NOT included unless specifically mentioned within the sales particulars. Certain items may however be available by separate negotiation. The measurements supplied are for general guidance, and as such must be considered as incorrect. A buyer is advised to re-check the measurements themselves before committing themselves to any expense. The Agent has not tested any apparatus, equipment, fixtures, fittings or services, and so does not verify they are in working order, fit for their purpose, or within ownership of the sellers, therefore the buyer must assume the information given is incorrect. Neither has the Agent checked the legal documentation to verify legal status of the property or validity of any guarantee. A buyer must assume the information is incorrect, until it has been verified by their own solicitors. The sales particulars may change in the course of time, and any interested party is advised to make final inspection of the property prior to exchange of contracts. A buyer must check the availability of any property and make an appointment to view before embarking on any journey to see a property. References to the Tenure of a Property are based on information supplied by the Seller. The Agent has not had sight of the title documents. A Buyer is advised to obtain verification from their Solicitor. Any reference to alterations to, or use of any part of the property, is not a statement that any necessary planning, building regulation or other consent has been obtained. A buyer must assume the information is incorrect until it has been verified by their own solicitors.

VAT : All figures quoted are exclusive of VAT where applicable. **Rating Assessments** : Where provided the Agent has made a verbal enquiry with the Local Authority and this information should be verified by interested parties making their own enquiries.

Misrepresentation Act 1967 : These details are prepared as a general guide only, and should not be relied upon as a basis to enter into a legal contract, or to commit expenditure. An interested party should consult their own surveyor, solicitor or other professionals before committing themselves to any expenditure or other legal commitments. If any interested party wishes to rely upon any information from the Agent, then a request should be made and specific written confirmation can be provided. The Agent will not be responsible for any verbal statement made by any member of staff, as only a specific written confirmation should be relied upon. The Agent will not be responsible for any loss other than when specific written confirmation has been requested. (REV02:10/13).

Ground Floor



First Floor

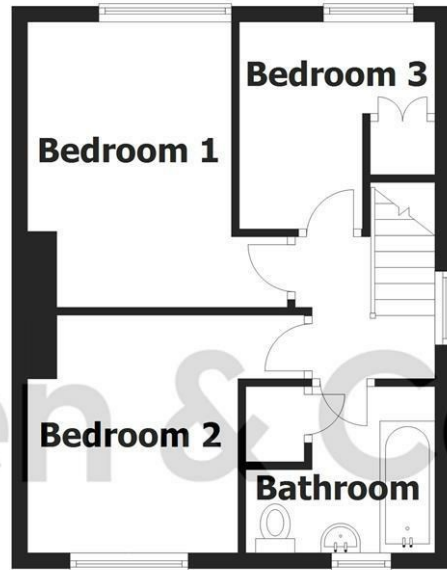

This plan is for layout guidance only and not drawn to scale unless stated. Window and door openings are approximate. Whilst every care is taken in preparation of this plan, please check all dimensions and shapes before making any decisions reliant upon them. Plan produced using PlanUp.

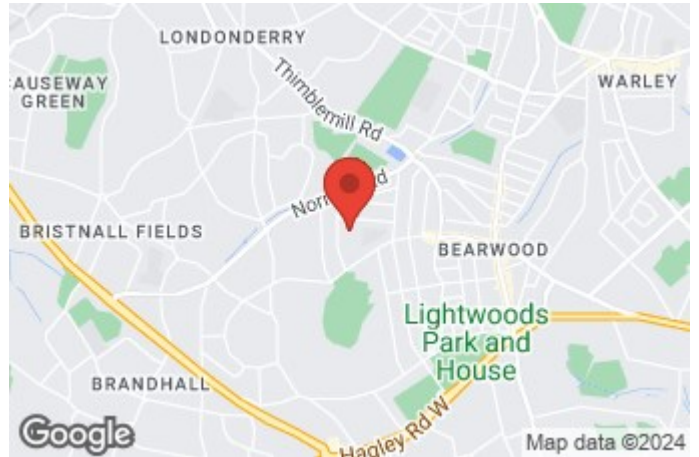

- Estate House, 821 Hagley Road West, Quinton, Birmingham, B32 1AD
- Tel: 0121 422 4011
- E-mail: quinton@scriven.co.uk
- www.scriven.co.uk
- Regulated By RICS

Energy Efficiency Rating		
	Current	Potential
<i>Very energy efficient - lower running costs</i>		
(92 plus) A		87
(81-91) B		
(69-80) C	69	
(55-68) D		
(39-54) E		
(21-38) F		
(1-20) G		
<i>Not energy efficient - higher running costs</i>		
England & Wales		EU Directive 2002/91/EC

Property Reference: 17942628