



1 St. Michaels Terrace



1 St. Michaels Terrace

Plymouth, PL1 4QG

An end of terrace family home lightly renovated with modernisation potential, external benefits include rear garden, parking and garage. Within walking distance of Stoke Village, parks and schools.

- Chain Free - Refurbishment Project
- Two/Three bedrooms
- Generous Living Space
- Garden, Parking & Garage
- Freehold
- Versatile Accommodation Set Over Three Floors
- Bright South Facing Living Room with Balcony
- Great Location
- Council Tax Band E

Guide Price £270,000

Situated in the sought-after location of Stoke within easy walking distance of Devonport Parks and the extensive range of local amenities of Stoke Village along with a bustling community. Local facilities within easy reach include Central Park, The Life Centre, City Centre and the University. Excellent nearby schools include Devonport High School for girls and Devonport High School for boys. The Dartmoor National Park is easily accessible and provides excellent activities for the lovers of the great outdoors, along with local beaches and coastal paths to explore. Plymouth itself has a full and varied range of shopping, educational and sporting facilities. There is a mainline train service to London Paddington and to Penzance in Cornwall. Brittany Ferries operates seasonal services from Plymouth to France and northern Spain.

A chain free 1960's townhouse, set over three floors the flexible accommodation comprises entrance hall giving access to integral garage, downstairs cloak room, study/third bedroom and utility room to the ground floor, stairs rise to the first floor with a fitted kitchen, bright spacious south facing living room with balcony and a further staircase to, two double bedrooms and a family bathroom. The property although requiring updating in areas has been well maintained with the roof being re-felted and insulated in 2021. External benefits include an enclosed rear garden and off-road driveway parking with adjacent garage.

Mains Electric, Gas, Water & Drainage.

Based on latest data available at Ofcom, Superfast broadband and mobile coverage from EE, Vodafone, Three & O2 are available at the property.





IMPORTANT: Stags gives notice that: 1. These particulars are a general guide to the description of the property and are not to be relied upon for any purpose. 2. These particulars do not constitute part of an offer or contract. 3. We have not carried out a structural survey and the services, appliances and fittings have not been tested or assessed. Purchasers must satisfy themselves. 4. All photographs, measurements, floorplans and distances referred to are given as a guide only. 5. It should not be assumed that the property has all necessary planning, building regulation or other consents. 6. Whilst we have tried to describe the property as accurately as possible, if there is anything you have particular concerns over or sensitivities to, or would like further information about, please ask prior to arranging a viewing.

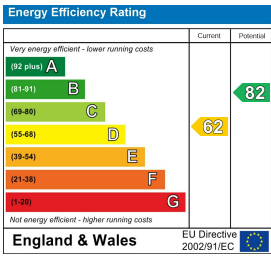

Plymhouse, 3 Longbridge Road, Plymouth, PL6 8LT

plymouth@stags.co.uk
01752 223933

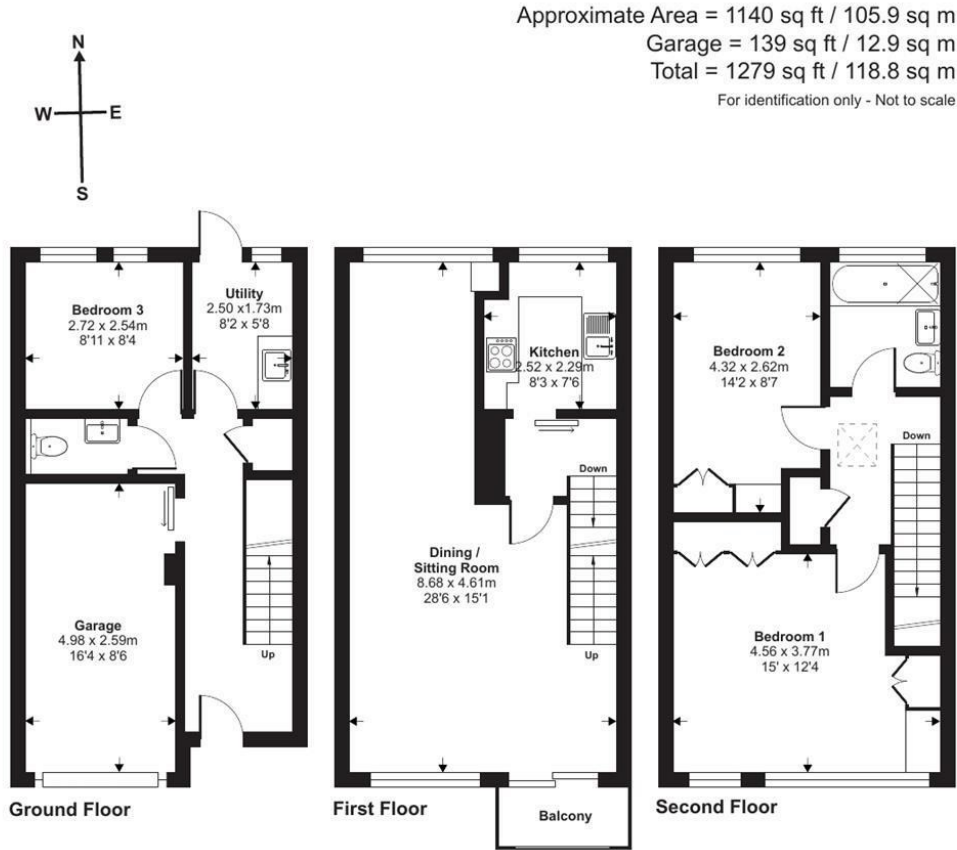

Floor plan produced in accordance with RICS Property Measurement 2nd Edition, Incorporating International Property Measurement Standards (IPMS2 Residential). © nichcom 2025. Produced for Stags. REF: 1295986



@StagsProperty

Cornwall | Devon | Somerset | Dorset | London