

JERICO HOUSE, JERICO LANE

St. Erth Praze, Hayle, TR27 6ED

Price: £1,500,000 - Guide



A unique detached property of real quality, sitting within its own private grounds and gardens of just under 5 acres, this stunning home must really be viewed to be appreciated. Offering 5 large bedrooms with main en-suite and 2 further bathrooms, large kitchen, dining room, formal lounge and 2 conservatories opening out onto the gardens, large utility room plus a detached garage and workshop with self-contained lodge above. A private driveway leads up into the grounds that offer 2 large fields, formal gardens and orchard along with large pond, with a perimeter of around 1 mile. There are possibly further development opportunities subject to the relevant planning consents being granted. Located along a rural lane but having easy and close access to Hayle (approx 1.5 miles) and all that growing town has to offer including a stunning beach and some very popular and well thought of restaurants and shops including a large Asda. Viewing this amazing property is highly recommended by Cross Estates - Viewing by appointment only. EPC – D, Council Tax - F, Tenure - Freehold



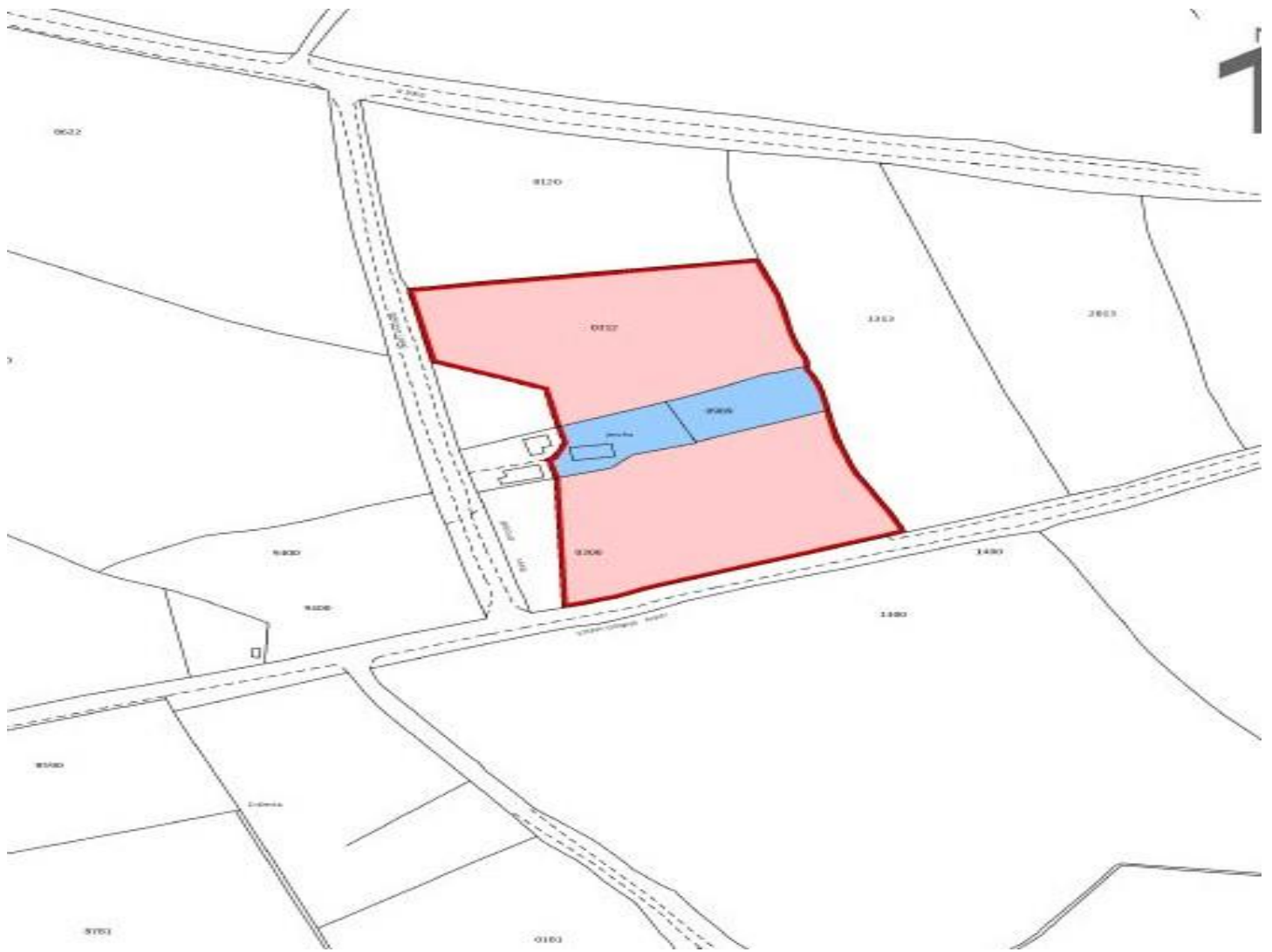

JERICO HOUSE, JERICO LANE, St. Erth Praze, Hayle, TR27 6ED

Large wood door leading into

ENTRANCE HALLWAY

Tiled flooring, wood framed double glazed door to the opens to the hall. Storage cupboard with boiler inset, door to:

UTILITY ROOM 10' 7" x 7' 2" (3.23m x 2.18m)

Dual aspect windows to rear and side, range of eye and base level units with worktop surface over, stainless steel sink unit and drainer with taps over, integrated fridge / freezer, plumbing for washing machine and dryer, tiled floor, power points

KITCHEN 16' 5" x 10' 6" (5m x 3.20m)

Large kitchen with an extensive range of eye and base level units with ample oak worktop surfaces over, Belfast sink unit with routed drainer, space for large 6 ring range style electric cooker with inset trivets either side, extractor hood and fan over, integrated dishwasher, space for American style fridge / freezer,

window to the front, tiled flooring, ample power points, opening into conservatory and into dining room

CONSERVATORY 12' 0" x 9' 5" (3.66m x 2.87m)

Tiled flooring, glazing to 3 sides and door opening out to the rear gardens and grounds, radiator, power points

DINING ROOM 14' 6" x 9' 7" (4.42m x 2.92m)

Tiled flooring, double glazed window to the rear, radiator, power points, door to

STUDY 13' 2" x 6' 6" (4.01m x 1.98m)

Tiled floor, double glazed window to the front cupboard and storage under stairs, power points, radiator, recess shelving

INNER HALLWAY

Tiled flooring, radiator, stairs to first floor, electric box, vestibule and door to the rear

CLOAKROOM

Enclosed WC, wash hand basin, tiled walls

RECEPTION ROOM / LOUNGE 16' 5" x 12' 3" (5m x 3.73m)

Lovely large room with double glazed window with deep sill to the rear, 2 radiators, large granite fireplace, recess with shelving, TV point, power points, opening to

CONSERVATORY 8' 9" x 7' 10" (2.67m x 2.39m)

Glazing to 3 sides, radiator, power points

FIRST FLOOR

Half turn staircase, double glazed window to the front, radiator, door to

FAMILY BATHROOM

Part tiled walls and tiled flooring, double glazed window to the front, close coupled WC, roll top claw footed double ended bath with with central taps, heated towel rail, wall mounted wash hand basin

BEDROOM TWO 14' 4" x 9' 11" (4.37m x 3.02m)

Double glazed window to the front with window seat, power points, radiator

BEDROOM THREE

Double glazed window to the front, power points, radiator, built in wardrobes housing hanging space and shelving

BEDROOM ONE 14' 5" x 11' 7" (4.39m x 3.53m)

Double glazed window to the front and further window to the side, power points, TV point, radiator, door to

EN-SUITE

Large en-suite with large walk in shower cubicle with mains connected shower inset with glazed shower screen, tiled flooring, individual oval ceramic vessel sink units, close coupled WC, heated towel rail, double glazed window to the front

2ND FLOOR

Landing, doors to

BEDROOM FOUR 15' 1" x 11' 9" (4.6m x 3.58m)

2 double glazed windows to the side, radiator, built in wardrobe housing hanging space and shelving

WETROOM

Tiled flooring, pedestal wash hand basin, close coupled WC, large shower with mains connected shower inset, heated towel rail, tiled walls

BEDROOM FIVE 13' 7" x 11' 9" (4.14m x 3.58m)

2 double glazed windows to the side, power points, radiator, built in storage cupboard

THE LODGE

Stable door into

KITCHENETTE 7' 5" x 8' 7" (2.26m x 2.62m)

Stainless steel sink unit and drainer, space for fridge, kitchen units, power points, stairs leading to first floor, door to

SHOWER ROOM

Double glazed window to the side, walk in shower cubicle with electric shower inset, pedestal wash hand basin, close coupled WC, heated towel rail





LOUNGE / BEDROOM 21' 6" x 12' 0" (6.55m x 3.66m)

Vaulted ceiling with large Velux window and further windows to front and rear, wood flooring, power points, TV point

GARAGE 21' 5" x 18' 8" (6.53m x 5.69m)

To the side of the property where the large formal parking area is, there is access into the large garage and workshop with power and light connected and timber extension to the rear 5.31m x 2.97m (17'5 x 9'9) with doors opening out to the rear. Above the garage with a separate entrance is The Lodge

OUTSIDE

The property is approached via the private, mature hedge lined driveway and into the formal parking for several cars in front of the garage. The property is set within the centre of extensive grounds just under 5 acres including mature formal gardens and orchard with large well established pond. The front garden is mainly laid to lawn with well tended and extensive planted borders with mature trees. There is a lovely South facing rear garden and patio space ideal for entertaining and enjoying the

tranquil setting and fine rural views over the properties land to the bordering fields and hills. There is a large field to the front which is a continuation of the rear gardens and to the rear another large field, bordered by hedging and possible access onto the road. The land is flexible and versatile with a number of possible uses either equestrian, market garden or smallholding and subject to planning possible glamping / camping or maybe some future development



JERICO HOUSE, JERICO LANE, St. Erth Praze, Hayle, TR27 6ED

Jericho Lane, St. Erth Praze, Hayle, TR27



Approximate Area = 2297 sq ft / 213.3 sq m
 Limited Use Area(s) = 234 sq ft / 21.7 sq m
 Annexe / Garage = 749 sq ft / 69.5 sq m (includes workshop)
 Total = 3280 sq ft / 304.7 sq m

For identification only - Not to scale

Denotes restricted head height

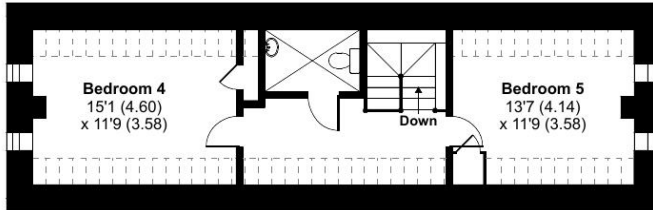

SECOND FLOOR

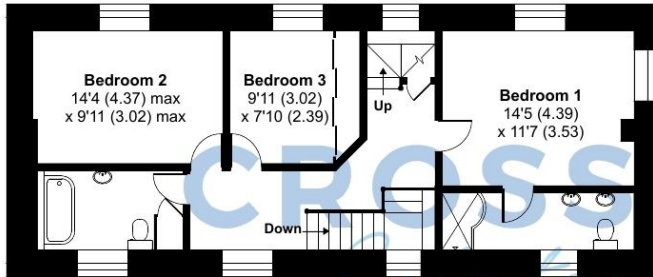

FIRST FLOOR

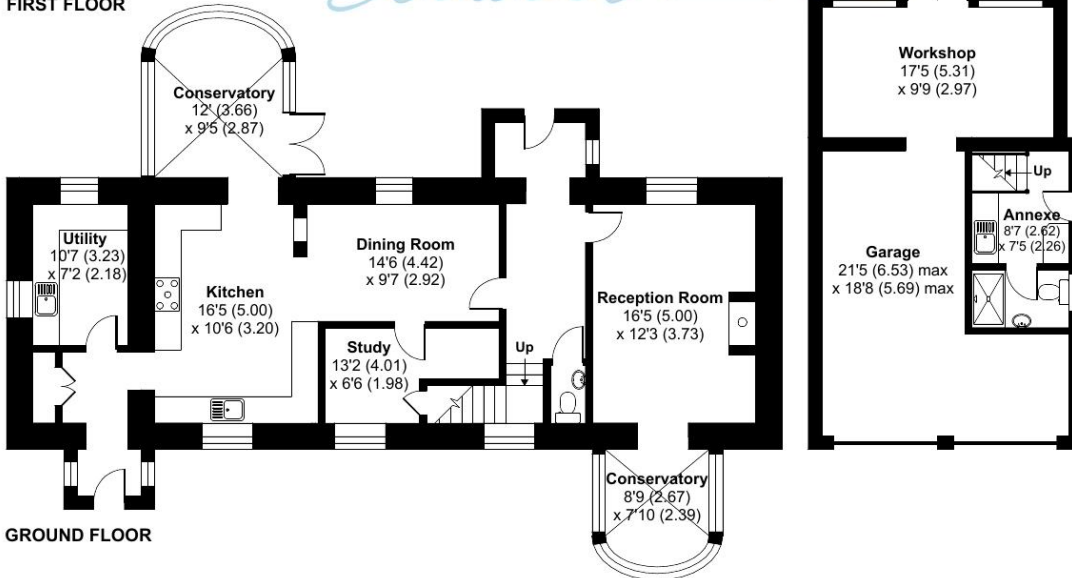
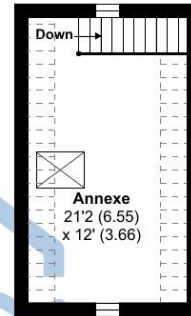

GROUND FLOOR



Floor plan produced in accordance with RICS Property Measurement Standards incorporating International Property Measurement Standards (IPMS2 Residential). © nchecon 2023. Produced for Cross Estates Limited. REF: 998420

The Property Misdescriptions Act 1991: Whilst we endeavour to ensure the accuracy of property details produced and displayed, we have not tested any apparatus, equipment, fixture and fittings or services and so cannot verify that they are in working order or fit for the purpose. Neither have we had sight of the legal documents to verify the Freehold or Leasehold status of any property. A Buyer is advised to obtain verification from their Solicitor and/or Surveyor. A Buyer must check the availability of any property and make an appointment to view before embarking on any journey to see a property. Items shown in photographs are not included; they must be available by separate negotiation.

The Data Protection Act 1998: Please note that all personal information provided by customers wishing to receive information and/or services from the estate agent will be processed by the estate agent, the TEAM Association Consortium Company of which it is a member and TEAM Association Limited for the purpose of providing services associated with the business of an estate agent and for the additional purposes set out in the privacy policy (copies available on request) but specifically excluding mailings or promotions by a third party. If you do not wish your personal information to be used for any of these purposes, please notify your estate agent.



