



Peppercorn Cottage



**STAGS**



# Peppercorn Cottage

Silverton, Exeter, Devon, EX5 4JB

Thorverton (3.1 miles), Exeter (8 miles), Crediton (9.2 miles)

A splendid period cottage located at the end of a quiet lane in this very popular village with a wonderful garden to the rear and adjoining paddock extending to 5 acres including a lake.

- 5 bedroom detached period cottage
- Lovely private garden to the rear
- Adjoining paddock/meadow extending to 5 acres with lake
- Double garage and ample off road parking
- Short walk into the village centre
- Cottage style kitchen
- On the market for the first time in many years
- Freehold
- EPC: E
- Council Tax Band: F

Guide Price £900,000

Set in the Silverton Conservation area, Peppercorn Cottage is a charming, unlisted period home, originally thought to have been two cottages, now a spacious five-bedroom detached property at the end of a quiet lane—just a short walk from the heart of a highly sought-after village. The entrance hall leads to a study, utility room, and W.C., with access to the garden. On the opposite side, a cosy sitting room features front and rear windows, a wood burner, and exposed stone fireplace. The adjoining dining room includes a fireplace recess and connects to the rear hall, which has garden access and leads to a generous kitchen/breakfast room with fitted units, an electric range, wood burner, and garden views. A rear storage room with W.C. completes the ground floor. Upstairs are five bedrooms, a family bathroom, and a separate shower room with W.C. A great feature of the upstairs is the beautiful stained glass window and steampunk bannisters. The cottage's standout feature is its extensive outdoor space. A private, mature garden lies just behind the house, with a patio, terraced lawn, several seating areas, and a BBQ zone overlooking the neighbouring meadow—ideal for relaxing or entertaining.









IMPORTANT: Stags gives notice that: 1. These particulars are a general guide to the description of the property and are not to be relied upon for any purpose. 2. These particulars do not constitute part of an offer or contract. 3. We have not carried out a structural survey and the services, appliances and fittings have not been tested or assessed. Purchasers must satisfy themselves. 4. All photographs, measurements, floorplans and distances referred to are given as a guide only. 5. It should not be assumed that the property has all necessary planning, building regulation or other consents. 6. Whilst we have tried to describe the property as accurately as possible, if there is anything you have particular concerns over or sensitivities to, or would like further information about, please ask prior to arranging a viewing.



Energy Efficiency Rating		
	Current	Potential
Very energy efficient - lower running costs		
(92 plus) A		
(81-91) B		
(69-80) C		
(55-68) D		
(49-54) E		
(41-48) F		
(31-40) G		
Not energy efficient - higher running costs		
1-20		
England & Wales		EU Directive 2002/91/EC

21/22 Southernhay West,  
Exeter, Devon, EX1 1PR

exeter@stags.co.uk  
01392 255202

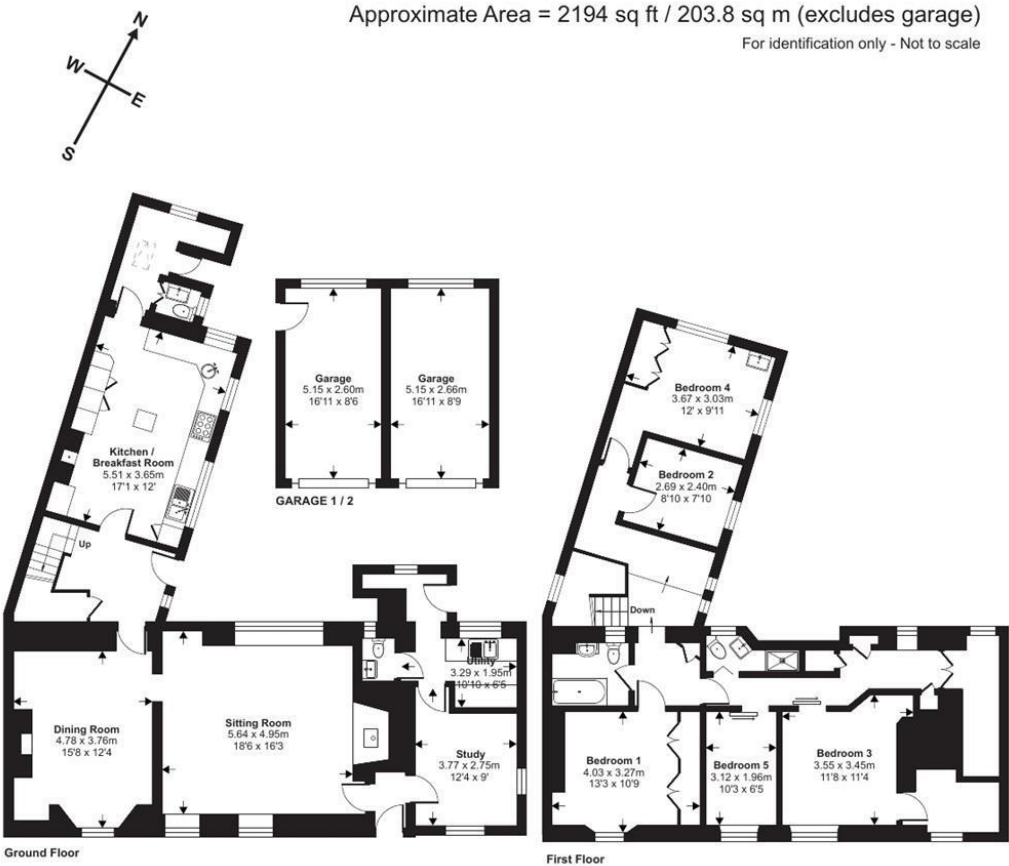

Floor plan produced in accordance with RICS Property Measurement 2nd Edition, Incorporating International Property Measurement Standards (IPMS2 Residential). © nidecom 2025. Produced for Stags. REF: 1272028



@StagsProperty

Cornwall | Devon | Somerset | Dorset | London