



Curtis House Morecambe Street London

£275,000
LEASEHOLD

Leonard Leese are pleased to market this charming one bed apartment situated in the heart of SE17. Set on the 1st floor within a purpose built block, this one bedroom property consists a large reception room, a separate kitchen and a lovely double bedroom.

The property is ideally located just moments from Elephant and Castle for an exceptional range of transport links while Walworth Road is also nearby for a selection of shops, bars and restaurants.

Call the sales department to reserve a viewing 0207 015 1360.



Morecambe Street, London, SE17

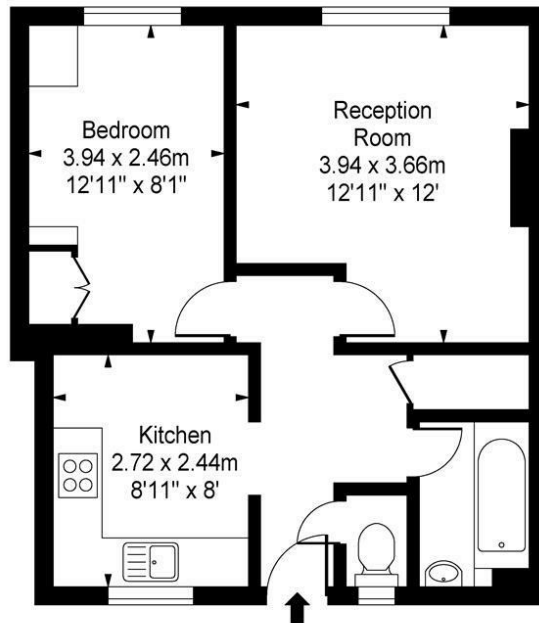

Second Floor

Approx Gross Internal Area 456 Sq Ft - 42.36 Sq M

This floor plan should be used as a general outline for guidance only and does not constitute in whole or in part an offer or contract. Any intending purchaser or lessee should satisfy themselves by inspection, searches, enquiries and full survey as to the correctness of each statement. Any areas, measurements or distances quoted are approximate and should not be used to value a property or be the basis of any sale or let.



Energy Efficiency Rating		
	Current	Potential
Very energy efficient - lower running costs		
(92 plus) A		
(81-91) B		
(69-80) C		
(55-68) D		
(39-54) E		
(21-38) F		
(1-20) G		
Not energy efficient - higher running costs		
England & Wales	EU Directive 2002/91/EC	

Agents Note: Whilst every care has been taken to prepare these particulars, they are for guidance purposes only. All measurements are approximate and are for general guidance purposes only and whilst every care has been taken to ensure their accuracy, they should not be relied upon and potential buyers/tenants are advised to recheck the measurements

Borough Lettings
 230 Borough High Street
 London
 SE1 1JX

020 7015 1360
 enquiries@leonardleese.com
 www.leonardleese.com

