



## Flat 8, Block N Peabody Estate

£300,000

LEASEHOLD

Leonard Leese are pleased to market this smart one-bedroom apartment on the third floor of this attractive purpose-built Edwardian block, in Central Camberwell.

The property comprises a spacious reception room including double-glazed sash windows which allows plenty of natural light. A well presented modern kitchen, a modern bathroom and a good sized double bedroom. Property provides wood flooring throughout.

Call the Sales Department to reserve a viewing 0207 0151 360.



- Purpose Built - Edwardian Block • One Bedroom Apartment • Third Floor • Great Location • GR - £400 Per Year • Please Contact Us On Whatsapp - 07418371565





## Peabody Estate, SE

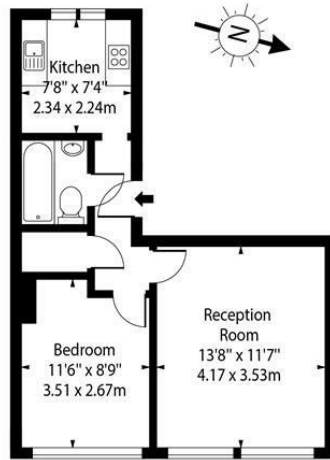

Third Floor

Approx Gross Internal Area 401 Sq Ft - 37.25 Sq M

This floor plan should be used as a general outline for guidance only. Any intending purchaser or lessee should satisfy themselves by inspection, searches, enquiries and full survey as to the correctness of each statement. Any areas, measurements or distances quoted are approximate and should not be used to value a property or be the basis of any sale or let.



Energy Efficiency Rating		
	Current	Potential
Very energy efficient - lower running costs		
(92 plus) A		
(81-91) B		
(69-80) C	72	
(55-68) D		
(39-54) E		
(21-38) F		
(1-20) G		
Not energy efficient - higher running costs		
England & Wales		EU Directive 2002/91/EC

Agents Note: Whilst every care has been taken to prepare these particulars, they are for guidance purposes only. All measurements are approximate and are for general guidance purposes only and whilst every care has been taken to ensure their accuracy, they should not be relied upon and potential buyers/tenants are advised to recheck the measurements

Borough Sales  
230 Borough High Street  
London  
SE1 1JX

020 7015 1360  
enquiries@leonardleese.com  
www.leonardleese.com

