



## Newington Causeway

**£420,000**  
**LEASEHOLD**

Two bedroom apartment in Metro Central Heights SE1, set on the 4th floor, comprising two double bedrooms, two bathrooms (one en-suite), an open-plan kitchen/living area and an abundance of natural light. The development offers 24hr concierge and free access to the on-site gym and swimming pool.

Call the sales department to reserve a viewing or for more information on 0207 015 1360.



Metro Central Heights,  
Newington Causeway, SE1

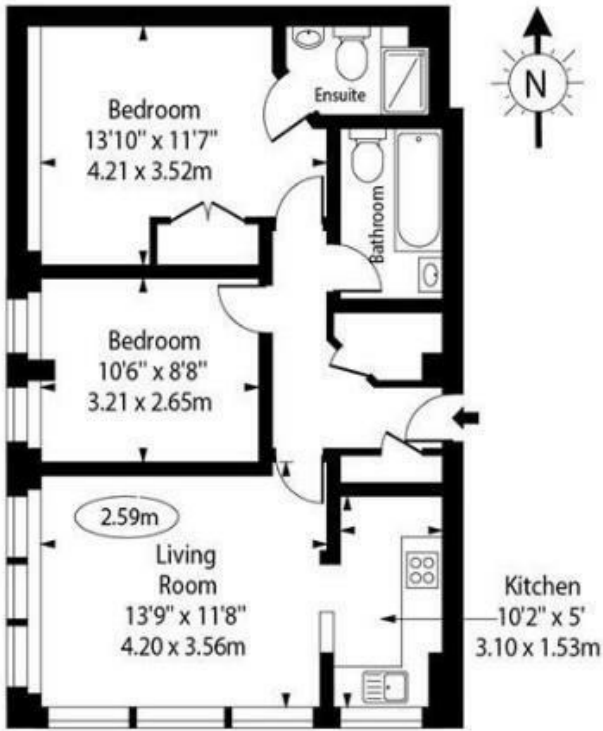

Fourth Floor

Approx Gross Internal Area 650 Sq Ft - 60.40 Sq M



Energy Efficiency Rating		
	Current	Potential
Very energy efficient - lower running costs		
(92 plus) A		
(81-91) B		
(69-80) C	72	78
(55-68) D		
(39-54) E		
(21-38) F		
(1-20) G		
Not energy efficient - higher running costs		
England & Wales		EU Directive 2002/91/EC

Agents Note: Whilst every care has been taken to prepare these particulars, they are for guidance purposes only. All measurements are approximate and are for general guidance purposes only and whilst every care has been taken to ensure their accuracy, they should not be relied upon and potential buyers/tenants are advised to recheck the measurements

**Borough Lettings**  
230 Borough High Street  
London  
SE1 1JX

020 7015 1360  
enquiries@leonardleese.com  
www.leonardleese.com

