



Bryan Bishop
and partners

New Place
Welwyn, AL6 9QA

New Place

Welwyn, AL6 9QA

Summary

Bryan Bishop and Partners are delighted to bring to the market this spacious four bedroom, two bathroom Georgian style family home in a lovely quiet cul-de-sac just a few minutes walk from the centre of the ever popular Welwyn village. This modern detached property exhibits traditional build quality and materials throughout, and benefits from a large open plan L shaped lounge/dining room, a stunning conservatory and a substantial double garage/workshop. Additional practicality for those with mobility restrictions is provided by a personal lift that gives full access to the upper floor from the corner of the lounge.



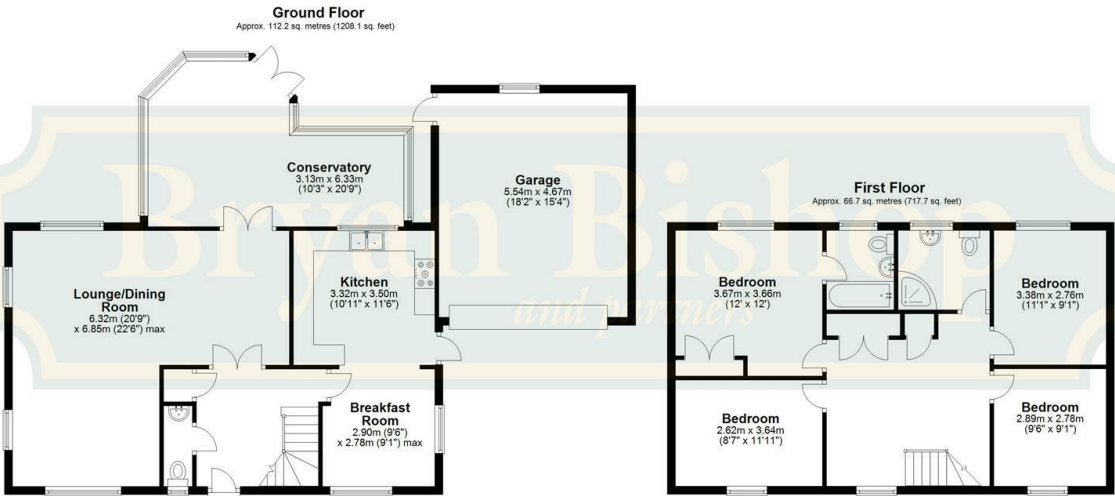

Total area: approx. 178.9 sq. metres (1925.8 sq. feet)

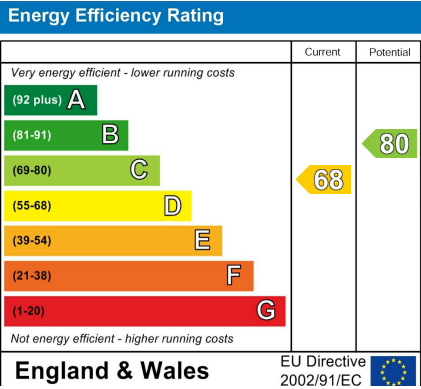



Bryan Bishop
and partners

6a High Street | Welwyn | AL6 9EG | 01438 718877 | info@bryanbishop.co.uk | www.bryanbishop.co.uk Find us on

