



- DETACHED BUNGALOW SITUATED TOWARDS THE END OF A CUL DE SAC
- CLOSE TO THE COOMBE VALLEY NATURE RESERVE
- ENJOYING RURAL VIEWS
- LOUNGE DINING ROOM
- KITCHEN BREAKFAST ROOM WITH PATIO DOORS LEADING TO GARDEN
- THREE BEDROOMS, FAMILY BATHROOM
- FRONT AND REAR GARDENS
- GARAGE IN NEARBY BLOCK

Lake Avenue, Teignmouth, TQ14 9LL Guide Price £270,000

A detached bungalow situated on a quiet walkway towards the end of a residential cul de sac on the edge of the Coombe Valley nature reserve. the bungalow enjoys rural views with accommodation briefly comprising; lounge dining room, kitchen breakfast room, three bedrooms, family bathroom, front and rear gardens, garage in nearby block.



## Property Description

Obscure glazed entrance door into...

### ENTRANCE HALLWAY

Radiator, hatch and access to loft space. Door to store cupboard. Obscure glazed door with corresponding side screen into the...

### LOUNGE/DINING ROOM

uPVC double glazed window overlooking the front aspect and approach with views over neighbouring properties, across the Coombe Valley nature reserve towards Haldon moor. Dado rail. Two radiators. Feature fireplace with tiled mantle and hearth with inset coal effect gas fire.

### KITCHEN/BREAKFAST ROOM

Cupboard and drawer base units under laminate work surfaces, one and a half bowl stainless steel drainer sink unit with mixer tap over, tiled splash backs, plumbing for washing machine, plumbing for dishwasher, integrated brushed chrome electric oven and four ring gas hob with chimney style extractor over, corresponding eye level units, larder style unit with space for upright fridge freezer, uPVC double glazed window overlooking the rear gardens. Radiator. Breakfast area with two uPVC double glazed windows to side aspect, radiator, uPVC double glazed French patio doors with outlook and access onto the rear gardens. Far reaching rural views.



### BEDROOM ONE

uPVC double glazed window overlooking the rear aspect and gardens. Radiator. Louvre doors to a built in wardrobe with hanging rail and fitted shelving.

### BEDROOM TWO

uPVC double glazed window to side aspect. Radiator.

### BEDROOM THREE

uPVC double glazed window to side and with views across the Coombe Valley nature reserve. Radiator.

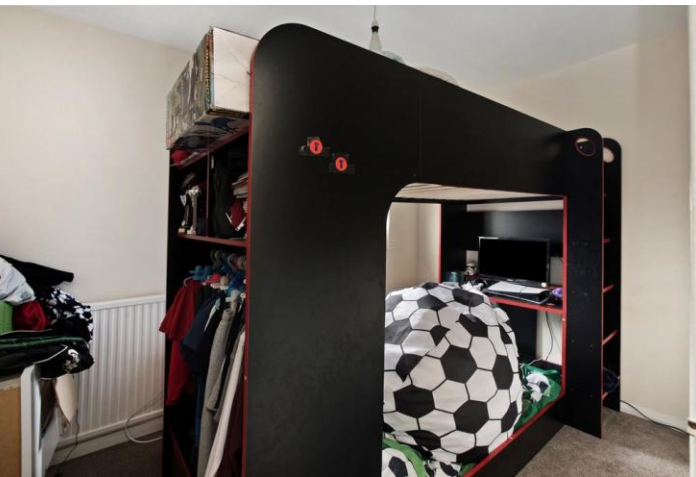

### BATHROOM

Bath with fitted Triton shower over, part tiled walls, obscure uPVC double glazed window, WC, pedestal wash hand basin, radiator.

### OUTSIDE

The property is approached over a paved pathway leading to the main entrance. There are front and side gardens, predominantly laid to lawn with mature flower bed borders. A pathway continues along the side of the property where there is well stocked raised retained mature gardens. Outside water tap. To the rear, also accessed from the kitchen breakfast room, is a crazy paved patio/seating area. The gardens are tiered with the upper being lawned and the lower tiers are stocked with a variety of shrubs, trees and evergreens. Decked seating area with pergola offering a high degree of privacy and seclusion and enjoying appealing and far reaching rural views. Garden shed. The rear garden is enclosed so suitable for those with pets and/or small children. Access to **UNDER HOUSE STORAGE AREA**.

### GARAGE

Situated in a nearby block.

MATERIAL INFORMATION - Subject to legal verification

Freehold

Council Tax Band C

---



Ground Floor  
75.6 sq.m. (813 sq.ft.) approx.

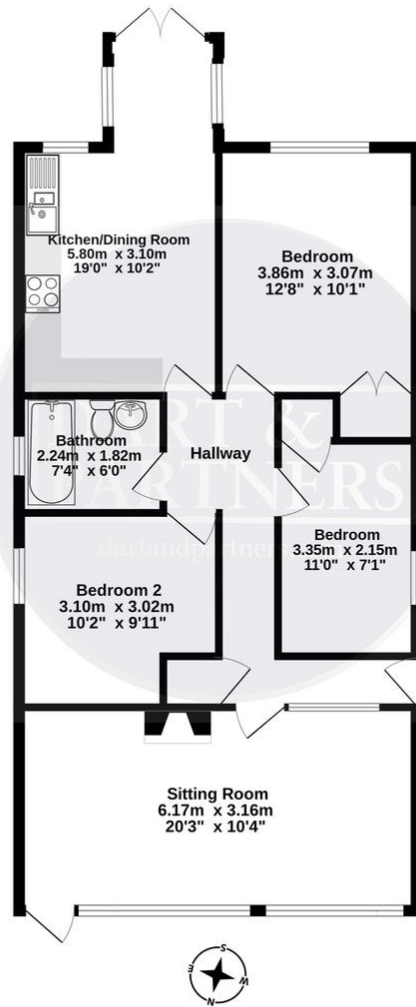

TOTAL FLOOR AREA : 75.6 sq.m. (813 sq.ft.) approx.

Whilst every attempt has been made to ensure the accuracy of the floorplan contained here, measurements of doors, windows, rooms and any other items are approximate and no responsibility is taken for any error, omission or mis-statement. This plan is for illustrative purposes only and should be used as such by any prospective purchaser. The services, systems and appliances shown have not been tested and no guarantee as to their operability or efficiency can be given.  
Made with Metropix ©2024

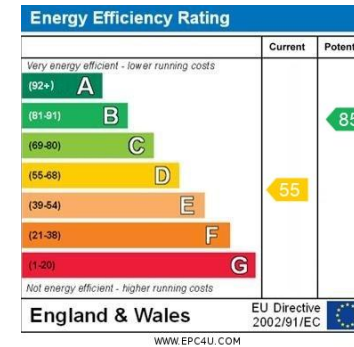

Teignmouth, 12 The Triangle,  
Teignmouth, Devon, TQ14 8AT

www.dartandpartners.com  
01626 772507  
property@dartandpartners.com

Agents Note: Whilst every care has been taken to prepare these sales particulars, they are for guidance purposes only. All measurements are approximate and for general guidance purposes only and whilst every care has been taken to ensure their accuracy, they should not be relied upon and potential buyers are advised to recheck the measurements