

Alcock Crest

Warminster, BA12 8NE

COOPER
AND
TANNER



£110,000 Leasehold

🛏 1 🛋 1 🚿 1 EPC C

A one bedroom flat that would be perfect for an investor or first time buyer with utility and store room for extra space and within walking distance of local amenities. As you enter the property the kitchen is ahead of you which has a range of wall and base units. The living room is of a good size with a balcony. The bedroom is double in size and is served by the family bathroom. To the side of the flat the property also benefits from a utility room and extra store cupboard.

Within the complex there is an enclosed garden which is shared between the flats with washing lines. There is also on the ground floor a separate store cupboard for the flat. There is also an allocated parking space with the flat.

Alcock Crest, Warminster, BA12

Approximate Area = 473 sq ft / 43.9 sq m

Outbuilding = 62 sq ft / 5.7 sq m

Total = 535 sq ft / 49.7 sq m

For identification only - Not to scale

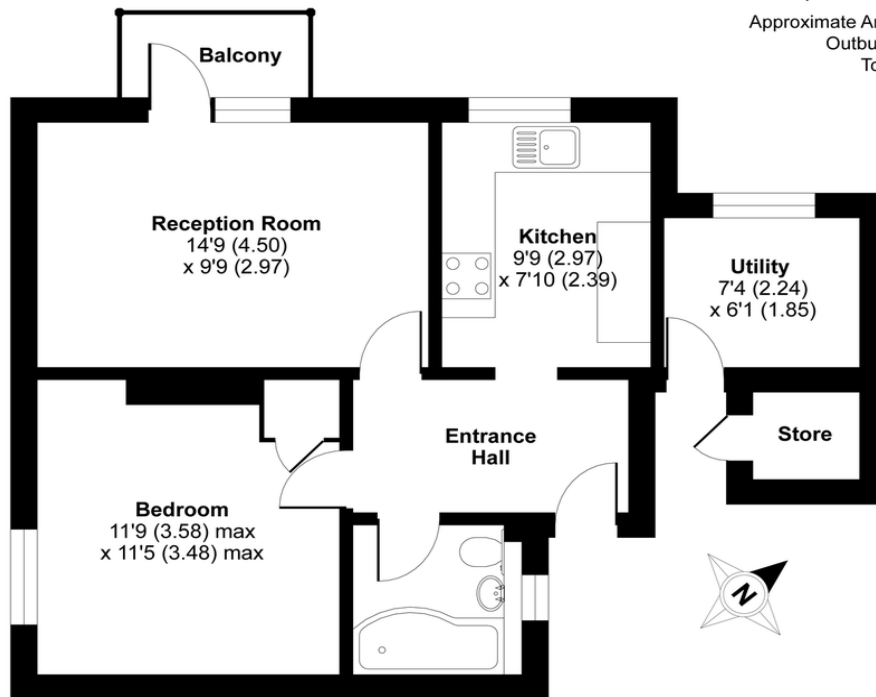

FIRST FLOOR



Floor plan produced in accordance with RICS Property Measurement Standards incorporating International Property Measurement Standards (IPMS2 Residential). © n/checom 2021. Produced for Cooper and Tanner. REF: 728030



Features

- One Bedroom Flat
- Kitchen
- Living Room
- Bedroom
- Bathroom
- Balcony
- Utility and Store Room
- Allocated Parking
- Close to Local Amenities
- No Onward Chain

Local Information

- Council Tax Band A
- Tenure Leasehold
- EPC Rating C

WARMINSTER OFFICE

Telephone 01985 215579

48/50 Market Place, Warminster, Wiltshire, BA12 9AN

warminster@cooperandtanner.co.uk

COOPER
AND
TANNER

Important Notice: These particulars are set out as a general outline only for the guidance of intended purchasers and do not constitute, nor constitute part of, an offer or contract. All descriptions, dimensions, reference to condition and necessary permissions for use and occupation, warranties and other details are given without responsibility and any intending purchasers should not rely on them as statements or representations of fact but must satisfy themselves by inspection or otherwise as to the correctness of each of them.

