



AN EXTENDED AND WELL-APPOINTED FOUR BEDROOM, TWO BATHROOM HOME

Elm Drive, North Harrow, HA2 7BZ

ROBSONS

Elm Drive, North Harrow, HA2 7BZ

**ENTRANCE HALLWAY • LOUNGE • KITCHEN
/DINING/LIVING ROOM • UTILITY ROOM •
FOUR BEDROOMS WITH ONE ENSUITE •
FAMILY BATHROOM • UNDERFLOOR
HEATING • REAR GARDEN • OFF-STREET
PARKING**

Description

An extended four-bedroom, two-bathroom semi-detached home providing on-trend contemporary living, with modern interiors, an attractive rear garden, and off-street parking. Perfect for those seeking convenience, the property is located a short walk from both North Harrow and West Harrow Underground Stations (Metropolitan Line), as well as local amenities, and a choice of schools.

The ground floor comprises an entrance porch and hallway, a front aspect lounge, a large kitchen/dining/living room that is flooded with natural light, a utility room, and a double bedroom with an en-suite. To the first floor there are two further double bedrooms, a single bedroom, and a four-piece family bathroom.





An attractive rear garden provides plenty of outdoor space, with bi-folding doors from the kitchen / diner opening out to the decking area. Off-street parking is available via your own driveway, at the front of the property.

Location

Elm Drive is located off The Ridgeway, a short walk from North Harrow and Rayners Lane High Streets, with Pinner also close by. For commuters, nearby underground stations provide regular links into London via the Metropolitan Line, with local bus routes easily accessible.

The area is well served by primary and secondary schooling, including Vaughn and Longfield Primary Schools.

Additional Information

Tenure: Freehold

Local Authority: London Borough of Harrow

Council Tax Band: E

Energy Efficiency Rating: C

For additional information, please refer to www.robsonswb.com or call us on: 020 8866 8083.



Approximate Gross Internal Area
 Ground Floor = 104.0 sq m / 1,119 sq ft
 First Floor = 46.1 sq m / 496 sq ft
 Shed = 5.5 sq m / 59 sq ft
 Total = 155.6 sq m / 1,674 sq ft

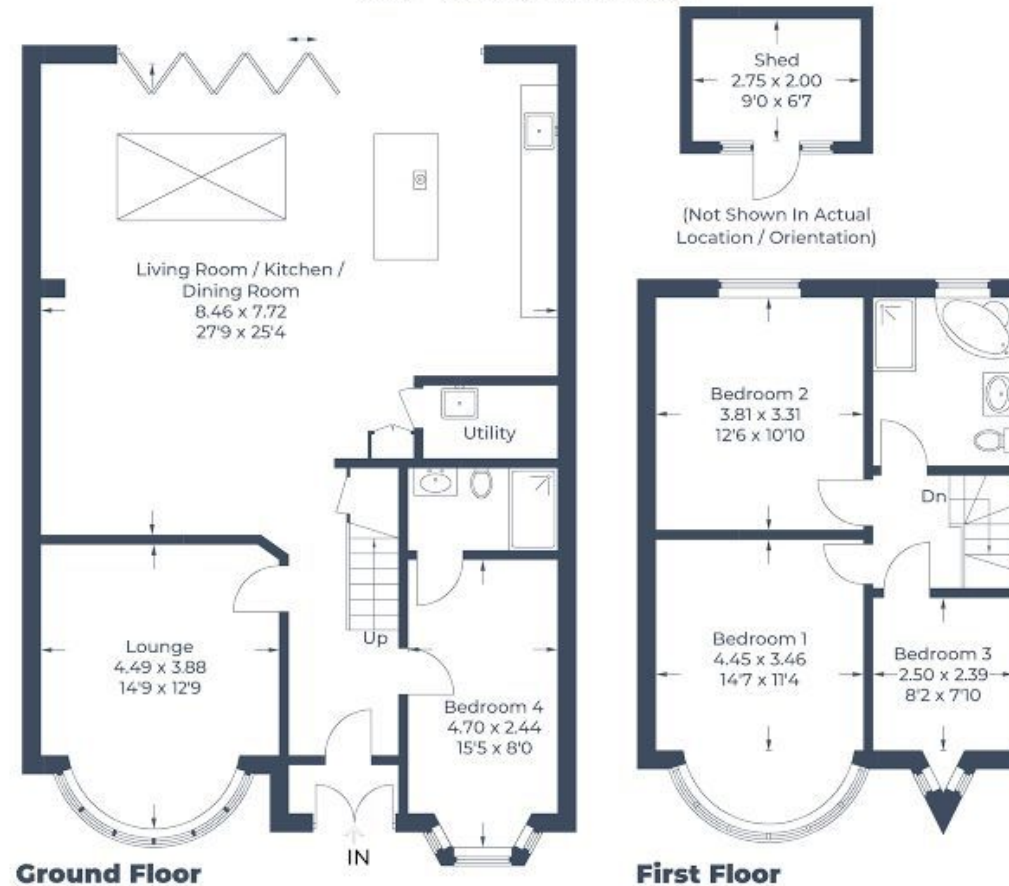

Illustration for identification purposes only,
 measurements are approximate, not to scale.
 © CJ Property Marketing Produced for Robsons

ROBSONS

1 High Street, Pinner HA5 5PJ
 Tel: 020 8866 8083 Email: pinner@robsonsweb.com
www.robsonsweb.com

SCAN TO VISIT



OUR WEBSITE

Important notice: Robsons, their clients and any joint agents give notice that 1: They are not authorised to make or give any representations or warranties in relation to the property either here or elsewhere, either on their own behalf or on behalf of their client or otherwise. They assume no responsibility for any statement that may be made in these particulars. These particulars do not form part of any offer or contract and must not be relied upon as statements or representations of fact. 2: Any areas, measurements or distances are approximate. Plot sizes and dimensions are taken from Promap and are approximate. The text, photographs and plans are for guidance only and are not necessarily comprehensive. It should not be assumed that the property has all necessary planning, building regulation or other consents and Robsons have not tested any services, equipment or facilities. Purchasers must satisfy themselves by inspection or otherwise.