

House - End Terrace (EPC Rating: C)

7 IVY CLOSE, BILTON, CV22 7YS

Per Calendar Month

£1,150 Per

**HOWKINS &
HARRISON**



3 Bedroom House - End Terrace located in Bilton

A modern 3 bedroom end terraced property built to a high specification, conveniently situated in the heart of Bilton Village with its range of local stores, public houses, schools for all ages and church.

Accommodation in brief comprises, entrance hall, WC, fitted kitchen/dining with built in appliances, lounge. Master bedroom with en-suite shower room, two further bedrooms and family bathroom.

The property also benefits from double glazing, gas fired radiator heating, an enclosed rear garden and off road parking for 2 vehicles. Available End of June 2025.

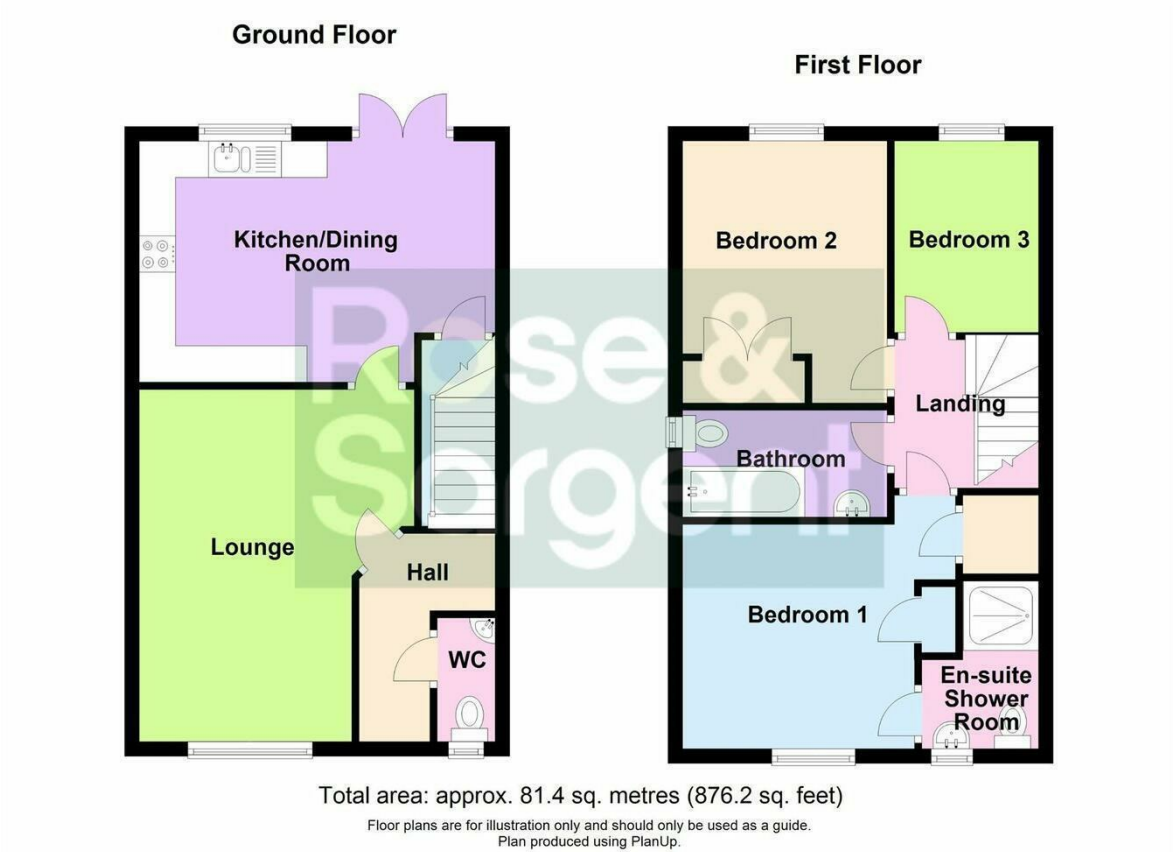

Council Tax Band
D
Energy Performance Graph

Call us on
01788 564666
<https://howkinsandharrison.co.uk/>

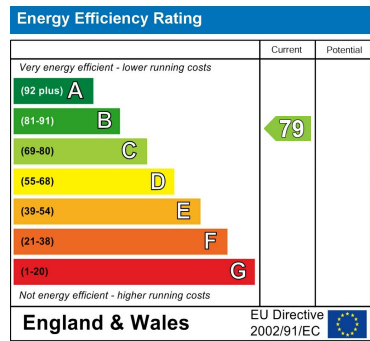

Agents Note: Whilst every care has been taken to prepare these particulars, they are for guidance purposes only. All measurements are approximate and are for general guidance purposes only and whilst every care has been taken to ensure their accuracy, they should not be relied upon and potential buyers are advised to recheck the measurements.