

# MILL MEADOWS

Viola  
HOMES

THE COVE | 2 bedroom detached bungalow



## HOUSE STYLE FEATURES



Open plan  
lounge diner



Integrated oven,  
hob and extractor



Separate kitchen with  
storage cupboard



Hallway with  
storage cupboard



Two parking  
spaces



Landscaped  
front garden



10 year NHBC  
warranty

## Ground floor

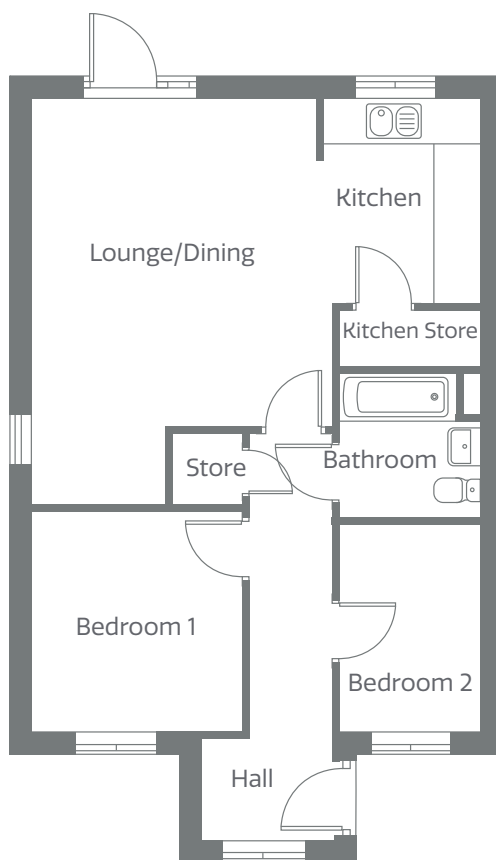

### Lounge/Dining

4.130m x 5.880m (13' 6.5" x 19' 3.5")

### Kitchen

2.250m x 2.970m (7' 4.5" x 9' 9")

### Kitchen Store

2.032m x 0.800m (6' 8" x 2' 7.5")

### Store

1.000m x 1.010m (3' 3.5" x 3' 4")

### Hall

1.200m x 5.890m (3' 11" x 19' 4")

### Bedroom 1

3.042m x 3.200m (10' 0" x 10' 6")

### Bedroom 2

2.042m x 3.000m (6' 8.5" x 9' 10")

### Bathroom

2.032m x 2.100m (6' 8" x 6' 10.5")

**CONSUMER  
CODE FOR  
HOME BUILDERS**

[www.consumercode.co.uk](http://www.consumercode.co.uk)



*Viola*  
**HOMES**

**For more  
information visit**

[violahomes.co.uk](http://violahomes.co.uk)

**T:** 0345 060 5555

**E:** [sales@violahomes.co.uk](mailto:sales@violahomes.co.uk)

Viola Homes is a trademark of Beyond Housing Limited (registered as a Community Benefit Society. Registration number 7814).

Please note floorplans and dimensions are taken from architectural drawings and are for guidance only. Dimensions stated are within a tolerance of plus or minus 50mm and these measurements should not be used for the purchase of carpets or furniture. Overall dimensions are usually stated and there may be projections into these. Computer generated images are not to scale. External finishes, landscaping and configuration is illustrative only and may vary from plot to plot. We operate a policy of continuous improvement and individual features such as kitchen and bathroom layouts, doors, windows, garages and elevation treatments may vary from time to time. To confirm specific details please ask our sales consultant. Consequently these particulars should be treated as general guidance only and do not constitute a contract, part of a contract or a warranty.