

11 Watersedge Anchor Close, Shoreham by Sea, West Sussex, BN43

£1,375 Per Calendar Month

Fourth Floor

Approx. 60.6 sq. metres (652.1 sq. feet)

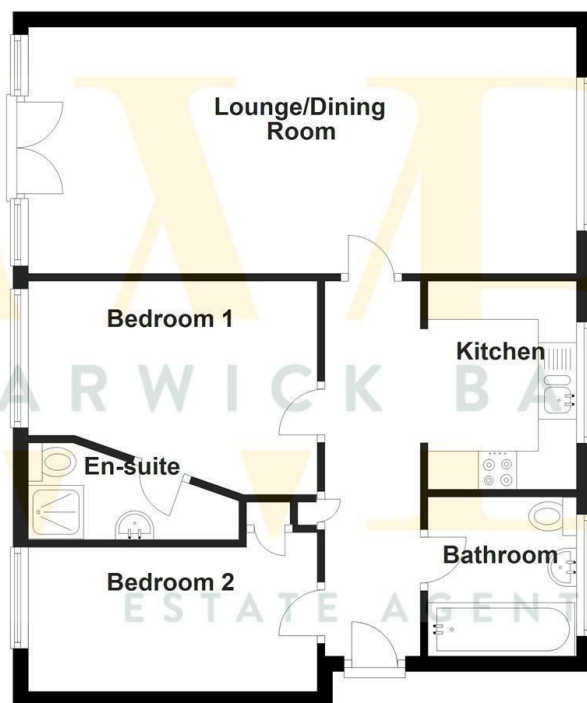

Total area: approx. 60.6 sq. metres (652.1 sq. feet)

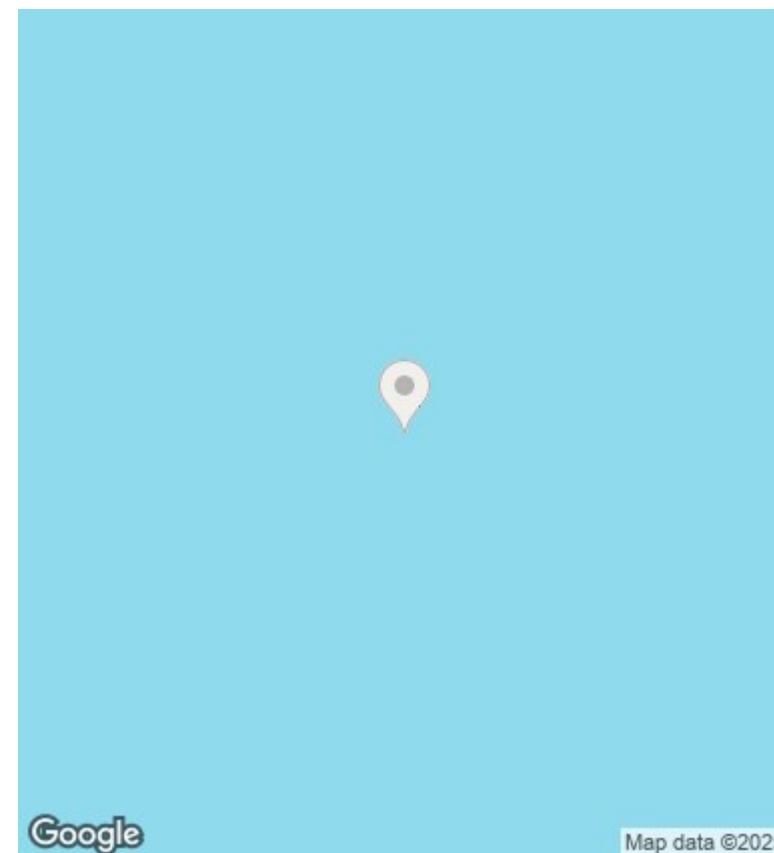

Directions

Viewings

Viewings by arrangement only. Call 01273454234 to make an appointment.

Council Tax Band

C

EPC Rating:

C

Energy Efficiency Rating		
	Current	Potential
Very energy efficient - lower running costs		
(92 plus) A		
(81-91) B		
(69-80) C	79	80
(55-68) D		
(39-54) E		
(21-38) F		
(1-20) G		
Not energy efficient - higher running costs		
England & Wales		EU Directive 2002/91/EC