



**15 Turner Street, Lees, Oldham, OL4 3JH**  
**£149,950**

END TERRACE | NEWLY RE-FURBISHED | TWO BEDROOMS | IDEAL FIRST PURCHASE | NO CHAIN |

The house on Turner Street comprises of a vestibule, lounge, kitchen diner, two bedrooms and bathroom & Wc. The outside provides an attractive, enclosed courtyard to rear. Located close to local amenities and public transport.



## ACCOMMODATION

### GROUND FLOOR

#### VESTIBULE

#### LOUNGE

13'11 x 14 (4.24m x 4.27m)



#### KITCHEN DINER

13'11 x 11'5 (4.24m x 3.48m)



Single drainer, stainless steel, sink unit. Electric hob, oven, extractor, fridge and freezer. A range of wall and base units with worktops.

### FIRST FLOOR

#### BEDROOM ONE

13'11 x 14 (4.24m x 4.27m)



To the front.

#### BEDROOM TWO

7'6 x 11'6 (2.29m x 3.51m)



To rear.

#### BATHROOM & WC

5'10 x 5'4 (1.78m x 1.63m)



Three piece white suite, shower over the bath and shower screen.

#### LANDING

## EXTERNALLY



Attractive rear courtyard.

### SERVICES -

All main services are installed.

### IMPORTANT NOTICE -

No checks have been made of any services (water, electricity, gas and drainage) heating appliances or any other electrical or mechanical equipment in this property.

### DISCLAIMER -

Wild & Griffiths themselves and the vendors/lessors of this property give notice that these particulars have been prepared in good faith having regard to the property misdescriptions act (1991). Measurements are intended for descriptive purposes only and are believed to be correct but any intending purchasers should not rely on them as statements or representations of fact. Any intending purchaser must satisfy themselves by inspection or otherwise as to the information provided and condition of the property and no warranty is given by the vendor, their agents or any other person in their employment. The property is offered subject to contract and still being available at the time of enquiry and no responsibility can be accepted for any loss or expenses incurred in viewing.

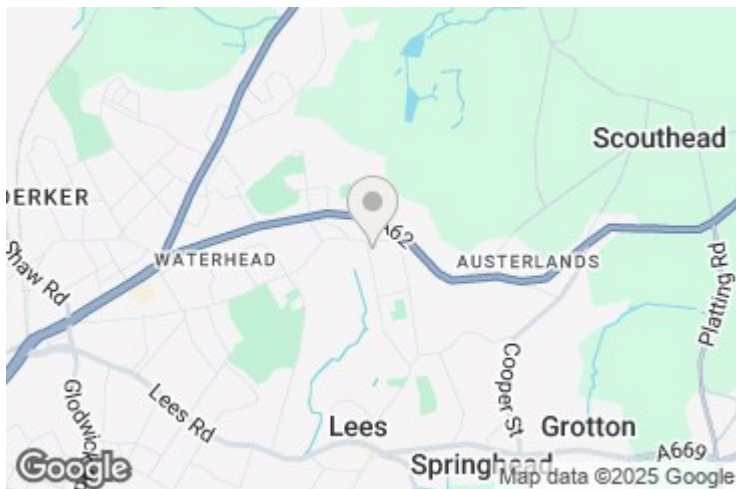



**Ground Floor**

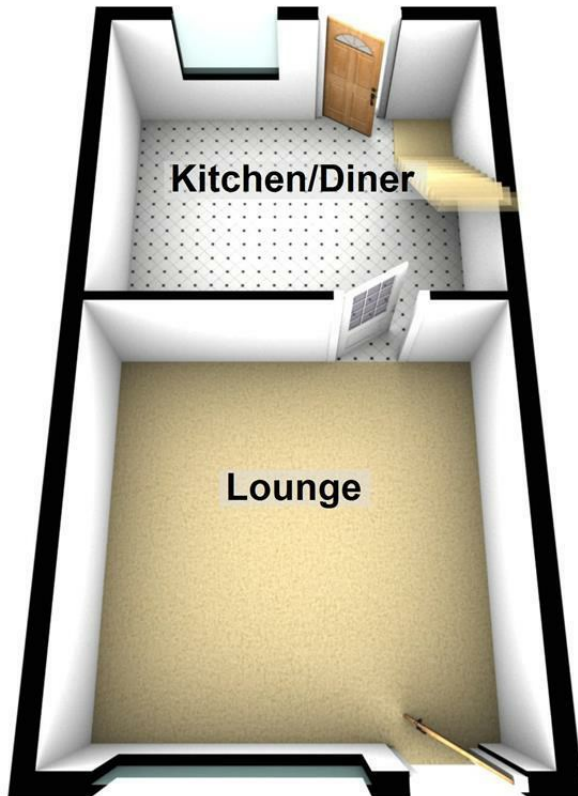

**First Floor**

