



1 Walnut Avenue, Greenacres, Oldham, OL4 2EQ
£155,000

END TERRACE | CORNER PLOT | TWO BEDROOMS | NO CHAIN | FREEHOLD | IDEAL FIRST PURCHASE |

The house on Walnut Avenue comprises of a porch, hall, lounge, kitchen, utility room, two bedrooms, shower room and landing. There are garden areas to three sides. Viewing comes highly recommended.

ACCOMMODATION

GROUND FLOOR

PORCH

HALL

LOUNGE

13'1 x 12'2 (3.99m x 3.71m)



KITCHEN

10'3 x 11 (3.12m x 3.35m)



Single drainer, stainless steel, sink unit. Gas hob and electric oven. A range of wall and base units with worktops and splash back tiling.

UTILITY ROOM

5'9 x 11'3 (1.75m x 3.43m)



FIRST FLOOR

BEDROOM ONE

16'6 x 10'8 (5.03m x 3.25m)



To the front.

BEDROOM TWO

7'6 x 10'3 (2.29m x 3.12m)



To the rear.

SHOWER ROOM

6'10 x 5'10 (2.08m x 1.78m)



Shower cubicle, two piece white suite, fully tiled.

LANDING

EXTERNALLY



Gardens to three sides with a patio area.

SERVICES -

All main services are installed.

IMPORTANT NOTICE -

No checks have been made of any services (water, electricity, gas and drainage) heating appliances or any other electrical or mechanical equipment in this property.

DISCLAIMER -

Wild & Griffiths themselves and the vendors/lessors of this property give notice that these particulars have been prepared in good faith having regard to the property misdescriptions act (1991). Measurements are intended for descriptive purposes only and are believed to be correct but any intending purchasers should not rely on them as statements or representations of fact. Any intending purchaser must satisfy themselves by inspection or otherwise as to the information provided and condition of the property and no warranty is given by the vendor, their agents or any other person in their employment. The property is offered subject to contract and still being available at the time of enquiry and no responsibility can be accepted for any loss or expenses incurred in viewing.

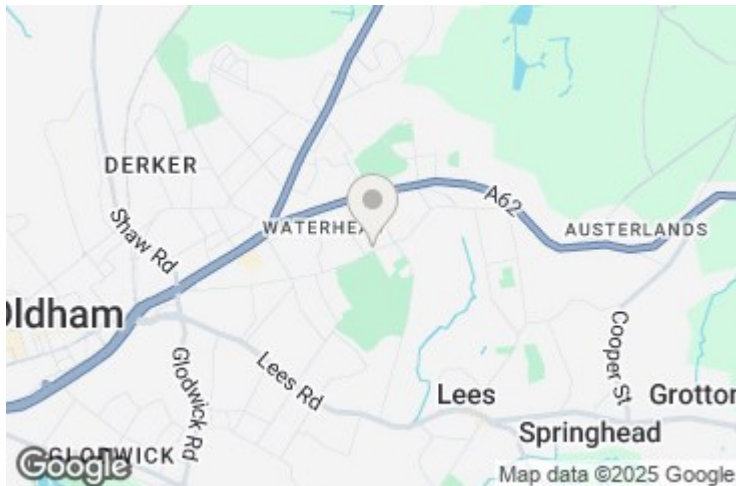

Ground Floor

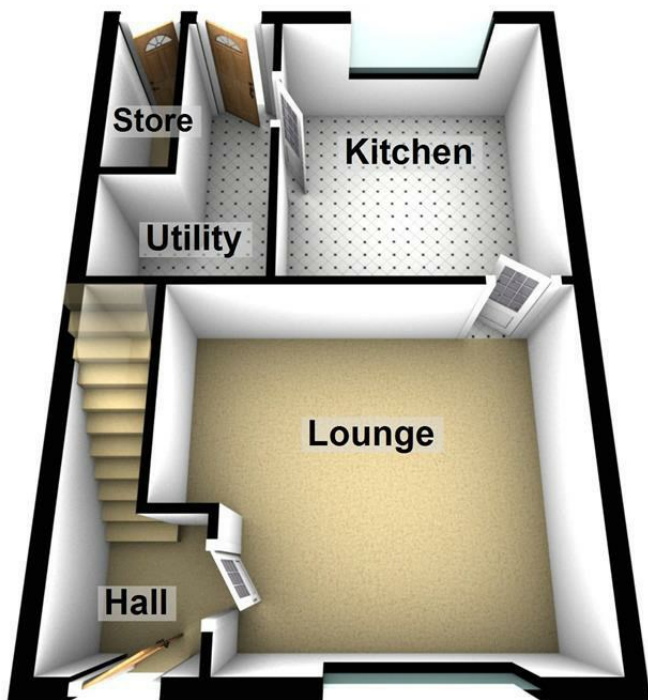

First Floor

