

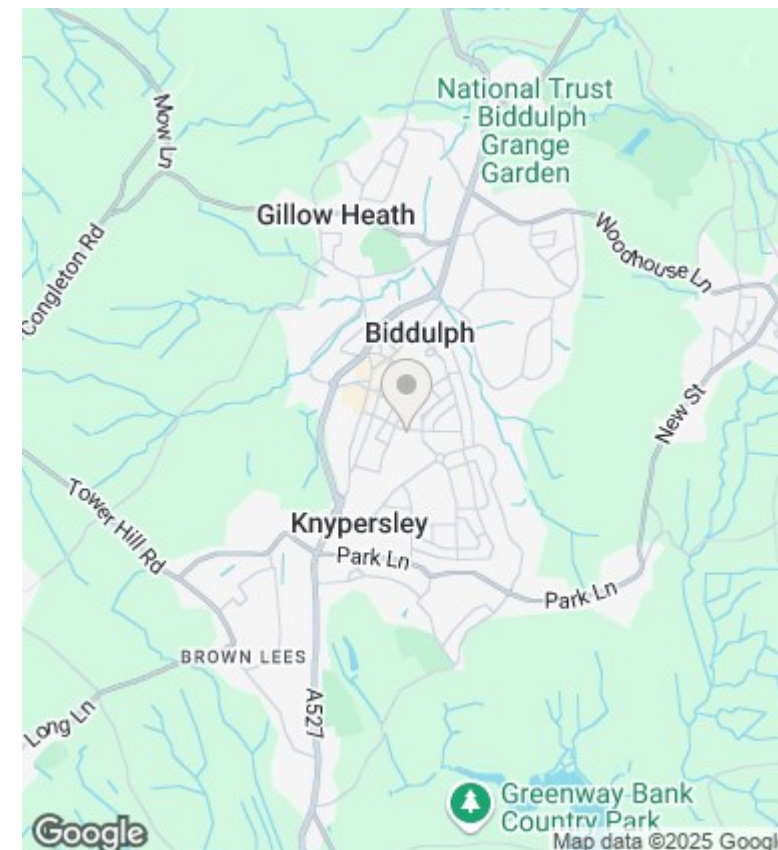

57 Well Street, Biddulph, Stoke-On-Trent, Staffordshire, ST8

Asking Price £273,000

- Three Bed Detached Family Home
- Views On The Horizon Over Biddulph Moor
- Covered Canopy With Inset Display Lighting To The Front
- Double Timber Gates Providing Privacy And Security
- Fully Double Glazed And Gas Central Heated
- Well Located For Local Schools And Amenities Of Biddulph Town Centre
- Master Bedroom Having En-suite And Juliet Balcony
- Dining Kitchen With Shaker Style Units
- No Upward Chain

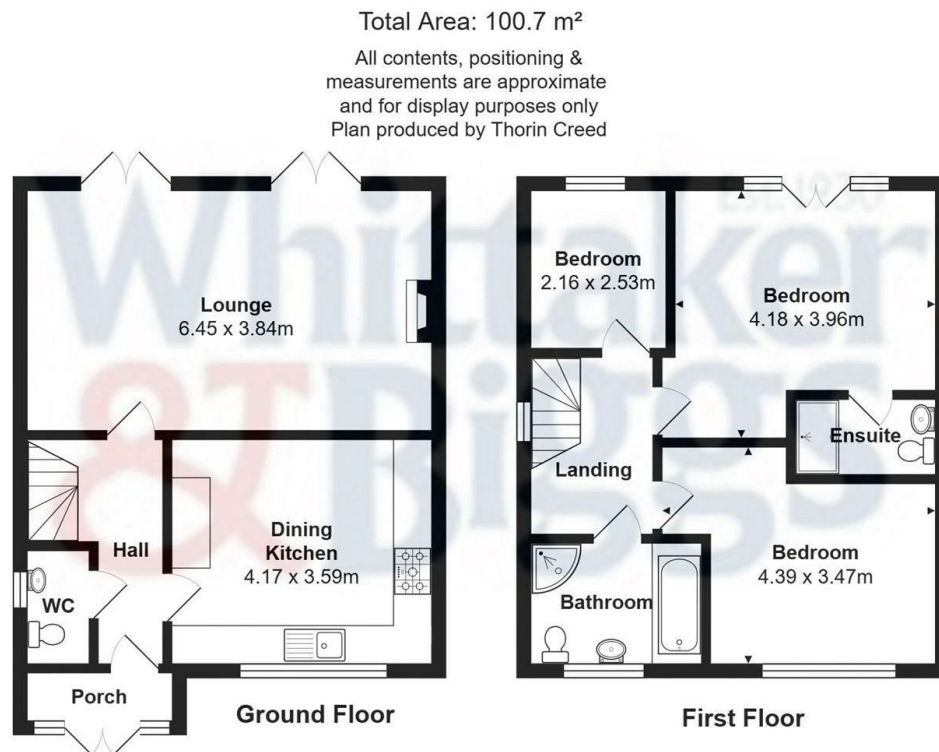

Directions

Viewings

Viewings by arrangement only. Call 01782 522117 to make an appointment.

Council Tax Band

C

EPC Rating:

Energy Efficiency Rating		
	Current	Potential
Very energy efficient - lower running costs		
(92 plus) A		
(81-91) B		
(69-80) C		
(55-68) D		
(39-54) E		
(21-38) F		
(1-20) G		
Not energy efficient - higher running costs		
England & Wales	EU Directive 2002/91/EC	