



## 2 Hambleton Place, Knypersley, Stoke-On-Trent, Staffordshire,

Asking Price £273,000

- **\*\*New Price \*\*** Extended Three-Bed Detached Home
- Three Bedrooms Including Two Doubles
- Elevated Plot Within A Cul-De-Sac
- No Upward Chain
- Two Reception Rooms Plus Dining Kitchen And Separate Study
- Modern Refurbished Bathroom
- Garden To The Front And Rear Garden Enjoying A Good Degree Of Privacy
- Potential To Extend The Dining Kitchen
- Suitable For Families
- Ample Off-Road Parking And Detached Garage



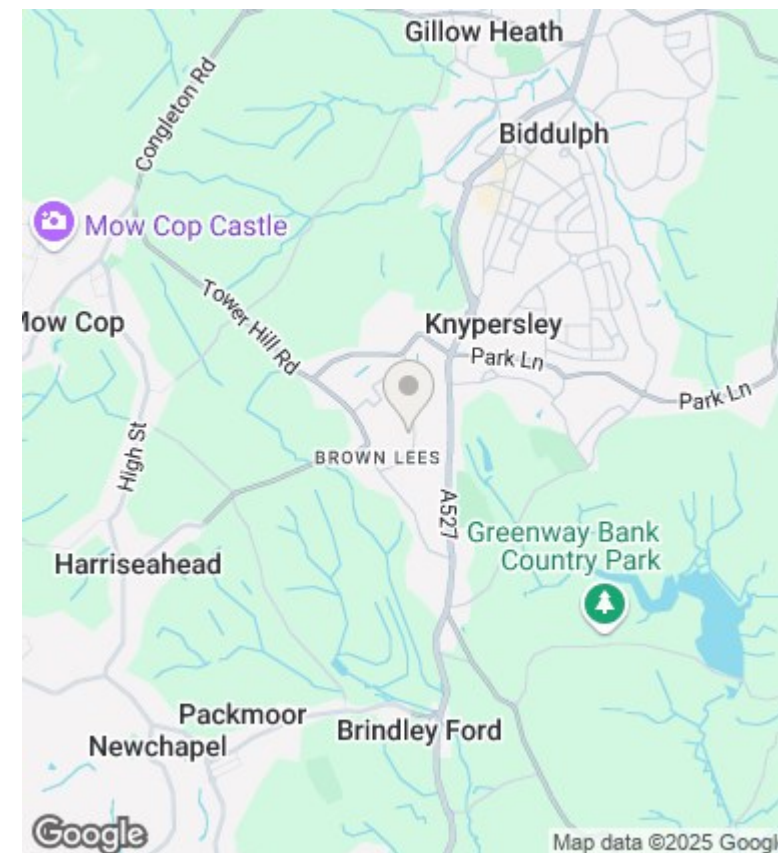
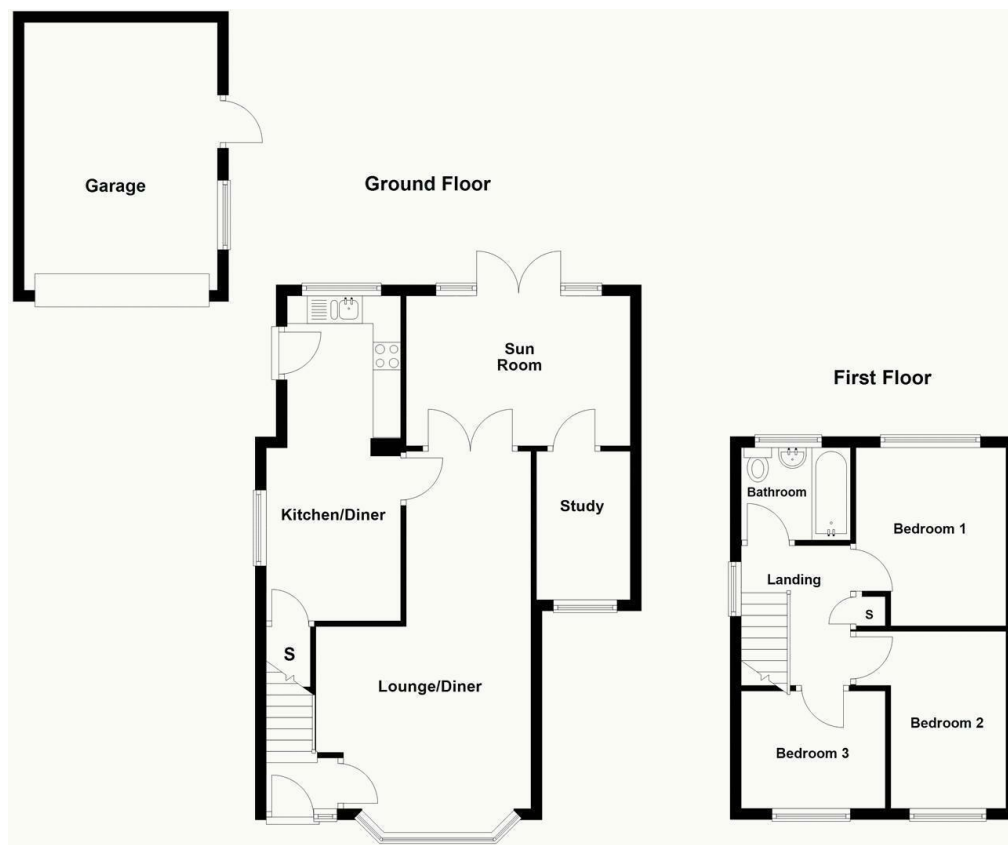

## Directions

## Viewings

Viewings by arrangement only. Call 01782 522117 to make an appointment.

## Council Tax Band

C

## EPC Rating:

Energy Efficiency Rating		
	Current	Potential
Very energy efficient - lower running costs		
(92 plus) <b>A</b>		
(81-91) <b>B</b>		
(69-80) <b>C</b>		
(55-68) <b>D</b>		
(39-54) <b>E</b>		
(21-38) <b>F</b>		
(1-20) <b>G</b>		
Not energy efficient - higher running costs		
<b>England &amp; Wales</b>	EU Directive 2002/91/EC	