



Westfields, Stoke-On-Trent, ST10 3ED.
Offers in the Region Of £190,000

Whittaker Est. 1930
& Biggs

Westfields, Stoke-On-Trent, ST10 3ED.

This three bedroom semi-detached home is nestled within a quiet cul de sac location and is well presented throughout. The property has front and rear gardens, driveway to the side and detached brick constructed garage.

The breakfast kitchen is an impressive 16ft, with a good range of fitted units, the living room has a solid fuel stove and the bathroom is well equipped. You're welcomed into the property via the entrance hallway, with the living room off. A feature stone effect fireplace incorporates a solid fuel stove and is the focal point to the room. The breakfast kitchen has an integral fridge, cupboard/plumbing for a washing machine, dryer, four ring gas hob, electric grill/oven and useful understairs storage.

To the first floor are three bedrooms and the family bathroom. The bathroom incorporates panel bath with electric shower over, WC, pedestal wash hand basin and an airing cupboard housing the immersion heated tank.

Externally to the frontage is a hedged boundary, lawn and to the side a tarmacadam driveway with access to the detached garage. The garage has up and over door, power and light connected. The rear garden is laid to lawn, patio and has fenced and hedged boundary.

Offered for sale with NO CHAIN, a viewing is highly recommended to appreciate this home position, located, condition and further potential.

Situation

Ideally situated in the rural village of Caudon Low. The village offers fantastic walks, with the open countryside on the doorstep and is within easy commuting distance of Leek town centre, Macclesfield and Ashbourne.



Entrance Hallway

UPVC double glazed door to the front elevation, staircase to the first floor.

Living Room 13' 0" x 13' 2" (3.95m x 4.02m)

UPVC double glazed bay window to the front elevation, multi fuel stove set on stone hearth, surround and mantle.

Kitchen/Diner 9' 7" x 16' 6" (2.91m x 5.04m)

Range of fitted units to the base and eye level, UPVC double glazed window to the rear elevation, one and half bowl sink unit with drainer and mixer tap over, Creda four ring gas hob, electric oven/grill, space for dryer, plumbing for washing machine, integral fridge, extractor fan, tiled splashbacks, radiator, understairs storage cupboard, UPVC double glazed door to the rear elevation.

First Floor

Landing

UPVC double glazed window to the side elevation, loft access.

Bathroom 6' 0" x 7' 1" (1.84m x 2.16m)

Panelled bath with traditional style mixer tap incorporating telephone shower attachment with electric shower over and shower screen wash hand basin, lower level WC, radiator, fully tiled, UPVC double glazed window to the rear elevation, airing cupboard housing immersion heated tank.

Bedroom One 10' 11" x 8' 0" (3.33m x 2.44m)

UPVC double glazed window to the front elevation, radiator.

Bedroom Three 7' 3" x 8' 2" (2.21m x 2.50m)

UPVC double glazed window to the front elevation, radiator.

Bedroom Two 11' 0" x 9' 1" (3.36m x 2.77m)

UPVC double glazed window to the rear elevation, radiator.

Externally

To the side is tarmacadam driveway, lawned to the front, well stocked borders. To the rear is Indian stone patio area, area laid to lawn, well stocked borders, greenhouse, hedged and fenced boundaries, LPG bottle connector for hob.

Garage 9' 4" x 17' 5" (2.84m x 5.30m)

Brick constructed, up and over door, power and light connected, window to the rear elevation.



Note:
Council Tax Band: B

EPC Rating:

Tenure: believed to be Freehold



GROUND FLOOR

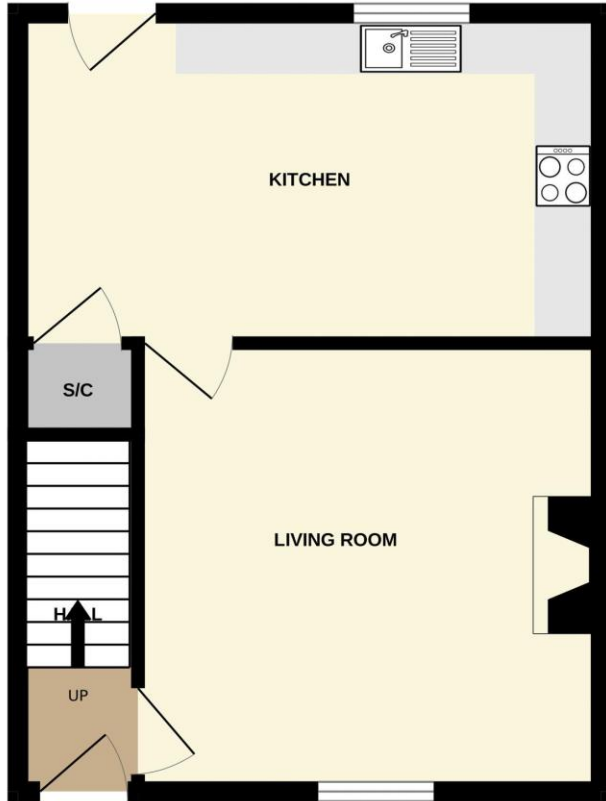

FIRST FLOOR

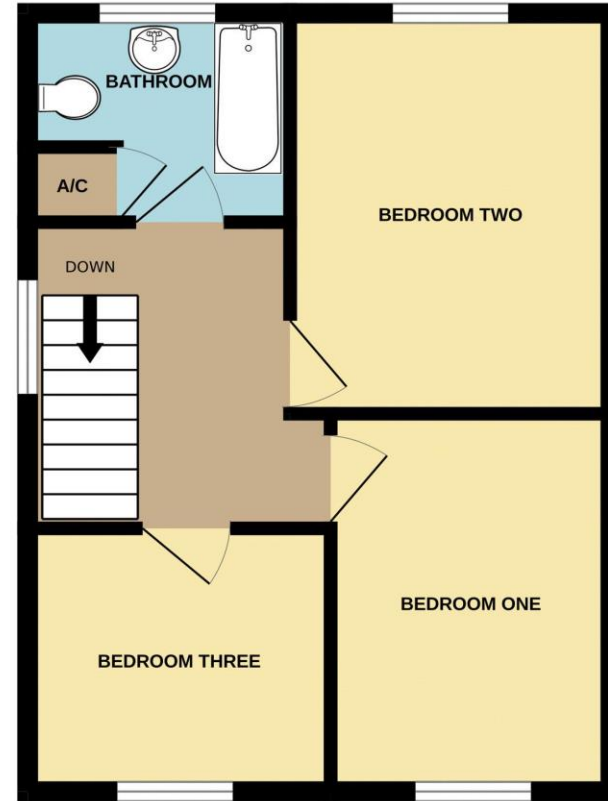

Whilst every attempt has been made to ensure the accuracy of the floorplan contained here, measurements of doors, windows, rooms and any other items are approximate and no responsibility is taken for any error, omission or mis-statement. This plan is for illustrative purposes only and should be used as such by any prospective purchaser. The services, systems and appliances shown have not been tested and no guarantee as to their operability or efficiency can be given.
Made with Metropix ©2023



Directions

IMPORTANT: Whittaker & Biggs for themselves and for the vendors or lessors of this property whose agents they give notice that the particulars are produced in good faith and are set out as a general guide only and do not constitute any part of a contract and no person in the employment of Whittaker & Biggs estate agents has any authority to make or give any representation or warranty in relation to this property. The agent has not tested any apparatus, equipment, fittings or services and so cannot guarantee they are in working order, or fit for their purpose. The agent would also like to point out that the majority of the photographs used on their brochures and window displays are taken with non standard lenses.

45-49 Derby Street
Leek
Staffordshire
ST136HU
T: 01538 372006
E: leek@whittakerandbiggs.co.uk

www.whittakerandbiggs.co.uk

Est. 1930
**Whittaker
& Biggs**