

|., 5a Chells Hill, Church Lawton, Stoke-On-Trent, Asking Price £535,000

- Prestigious Four Double Bedroom Detached Residence
- Separate Utility & Cloakroom
- Two Further Bedrooms & Family Bathroom
- Beautiful Semi-Rural Village Of Church Lawton
- Open Plan Living, Dining & Kitchen With Integral Appliances
- Master Suite With En-suite & Dressing Area- Occupying Its Own Floor
- Driveway Providing Ample Parking For Vehicles
- Spacious Lounge With Feature Window
- Second Bedroom With En- Suite Facilities
- Planning Permission Granted For A Detached Garage

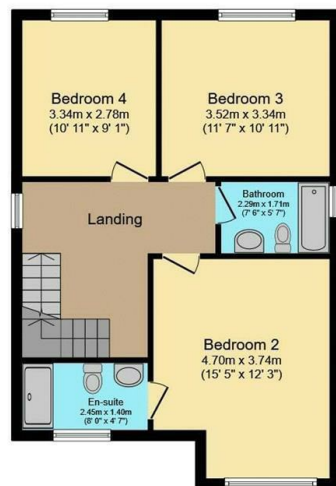

Ground Floor



First Floor

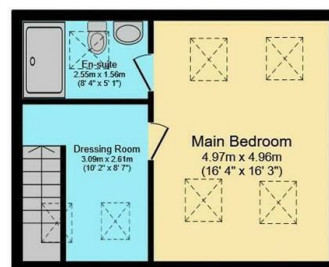

Second Floor

Total floor area 158.1 sq.m. (1,702 sq.ft.) approx

This floor plan is for illustrative purposes only. It is not drawn to scale. Any measurements, floor areas (including any total floor area), openings and orientation are approximate. No details are guaranteed, they cannot be relied upon for any purpose and they do not form part of any agreement. No liability is taken for any error, omission or misstatement. A party must rely upon its own inspection(s). Powered by www.focalagent.com

Directions

Viewings

Viewings by arrangement only. Call 01260 273241 to make an appointment.

Council Tax Band

F

EPC Rating:

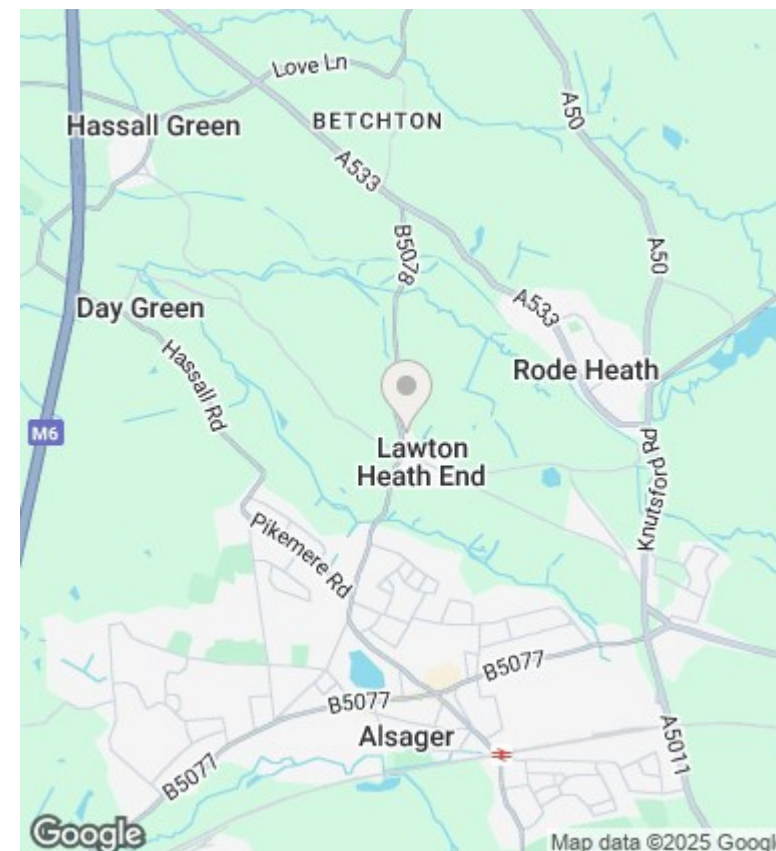

Energy Efficiency Rating		
	Current	Potential
Very energy efficient - lower running costs		
(92-plus) A		
(81-91) B		
(69-80) C		
(55-68) D		
(39-54) E		
(21-38) F		
(1-20) G		
Not energy efficient - higher running costs		
England & Wales	EU Directive 2002/91/EC	