



## 14 Tudor Way, Congleton, Cheshire, CW12 4AS

Offers In Excess Of £550,000

- Beautifully Presented Extended Four Bedroom Detached Residence
- High Specification Fixture & Fittings Throughout
- Bedroom Four Currently Utilised As an Office/ Study
- Magnificent Gardens, Patio Area & Delightful Summer House
- Spacious Lounge With Views of The Gardens & Separate Formal Dining Room
- Separate Utility Room & On-Trend Cloakroom
- On- Trend Family Bathroom
- Superb Size Open Plan Living/ Dining & Kitchen With Bi-Fold Doors Onto The Gardens
- Master Bedroom With Bespoke Cabinetry & En-suite Bathroom Facilities
- Integral Garage & Private Driveway



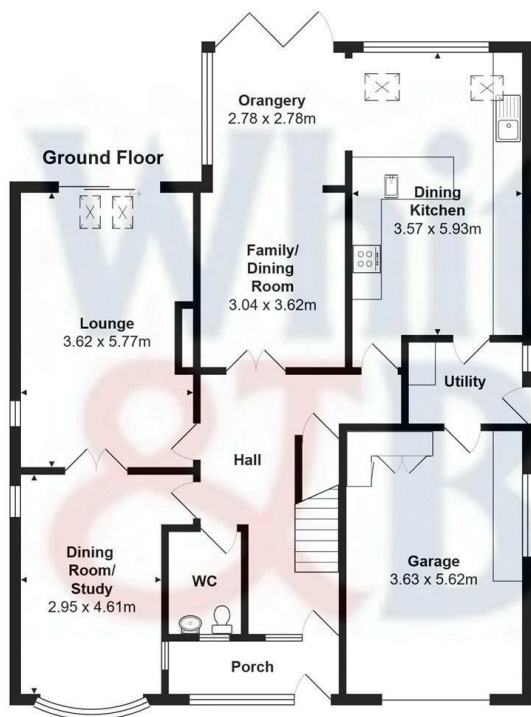

Total Area: 213.3 m<sup>2</sup>  
 All contents, positioning & measurements are approximate and for display purposes only  
 Plan produced by Thorin Creed

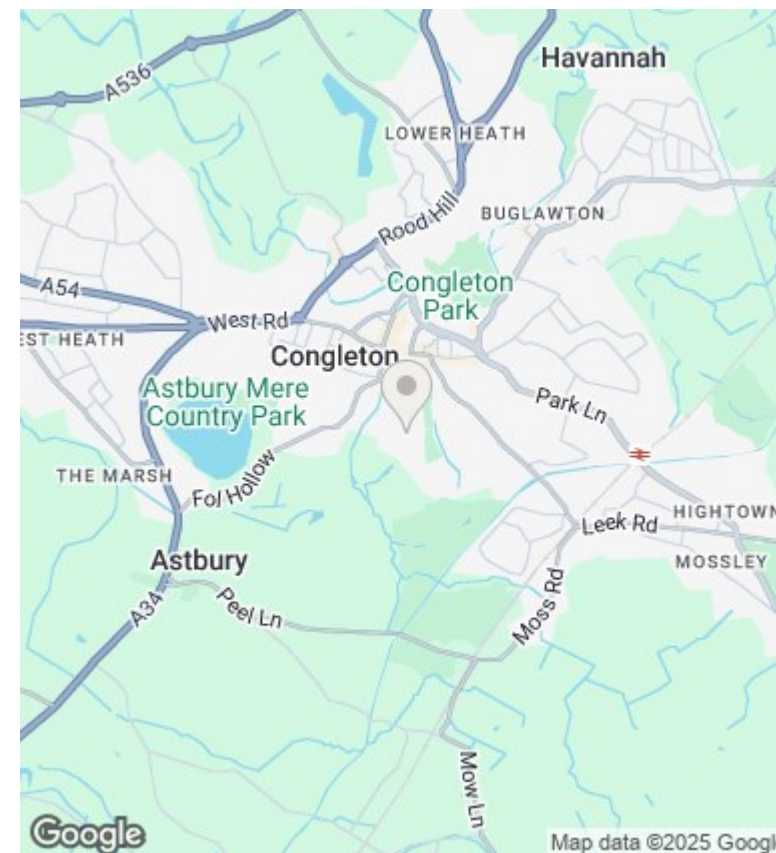

## Directions

## Viewings

Viewings by arrangement only. Call 01260 273241 to make an appointment.

## Council Tax Band

F

## EPC Rating:

Energy Efficiency Rating		
	Current	Potential
Very energy efficient - lower running costs		
(92 plus) <b>A</b>		
(81-91) <b>B</b>		
(69-80) <b>C</b>		
(55-68) <b>D</b>		
(39-54) <b>E</b>		
(21-38) <b>F</b>		
(1-20) <b>G</b>		
Not energy efficient - higher running costs		
<b>England &amp; Wales</b>	EU Directive 2002/91/EC	