



Davenant Road

London, N19

Asking Price £500,000

A two bedroom garden flat located moments away from Whittington Park and just a short walk to Archway Underground Station. The property comprises a private entrance, modern kitchen and bathroom, hardwood floors throughout, a sunny decked garden and bay-fronted reception room.

CHESTERTONS



Davenant Road

London, N19

- Two bedroom apartment
- Private entrance
- Decked garden
- Excellent location
- Share of freehold



The property is conveniently located on one of Archway's sought after roads, close to local shops and amenities and within easy access of Camden, King's Cross, The City & West End.

Tenure: Share of Freehold with a lease of 107 years remaining

Service Charge: £575 per annum

Ground Rent: £10 per annum

Local Authority: London Borough Of Camden

Council Tax Band: C

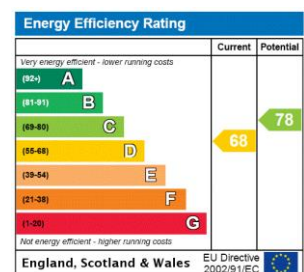

Chestertons Camden & Kentish Town Sales

99-101 Parkway

Camden

London

NW1 7PP

camden@chestertons.co.uk

020 7267 2053

chestertons.co.uk

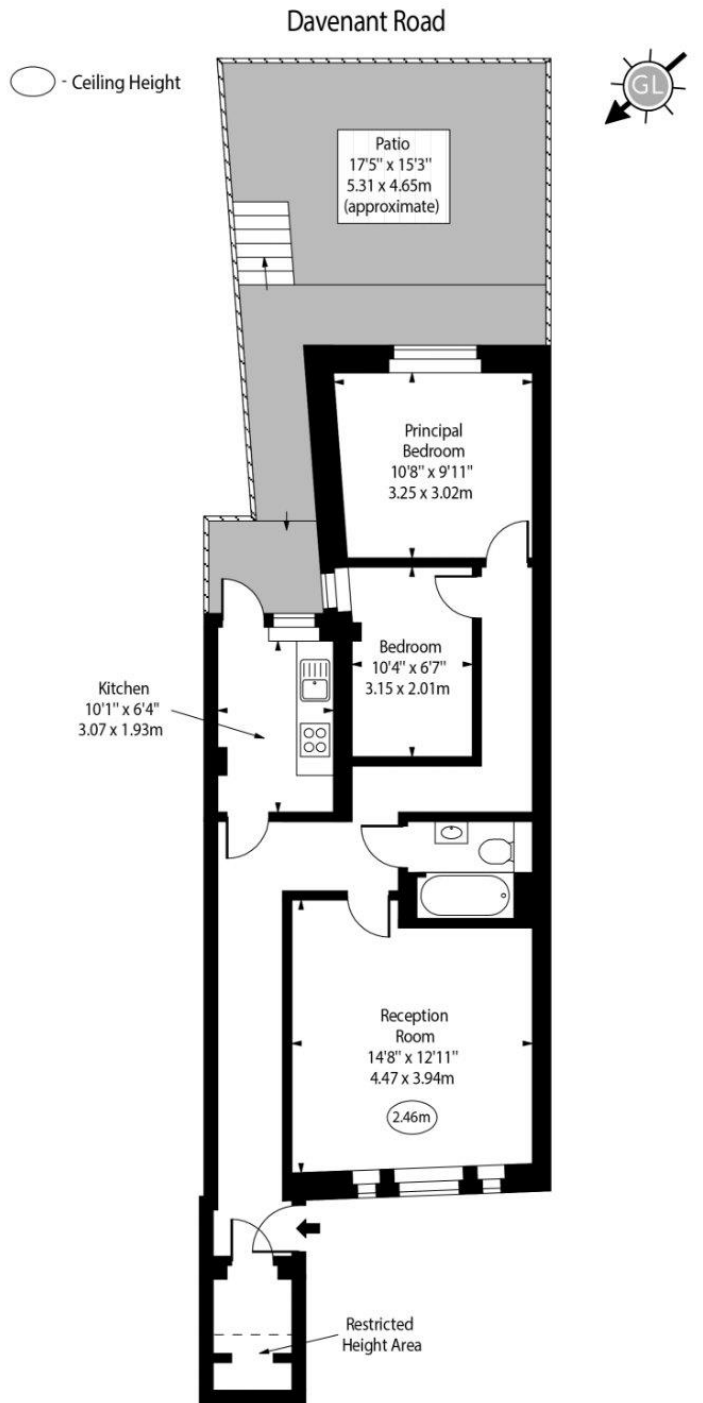

Lower Ground Floor

Gross Internal Area - 685 Sq Ft - 63.64 Sq M

Approx Gross Internal Area 672 Sq Ft - 62.43 Sq M

Approx. Floor Area Including Restricted Heights 685 Sq Ft - 63.64 Sq M

For Illustration Purposes Only - Not To Scale
www.goldlens.co.uk
Ref. No. 027323K