



Barker Drive

London, NW1

Asking Price £425,000

A spacious two double bedroom second floor flat set within a private development situated in close proximity to Kings Cross. The property boasts a spacious double bedroom, sunny reception room and modern bathroom. Further benefits include off-street parking and a very long lease. Being sold chain-free.



Barker Drive

London, NW1

- Two bedrooms
- Chain-free
- Close to Kings Cross
- Well presented
- Off-street parking



Barker Drive is situated in the Elm Village development which is very well located to take advantage of the excellent amenities of neighbouring Kings Cross and Camden Town.

Tenure: Leasehold with 997 years remaining.

Service Charge: £3120 Approx. per annum

Ground Rent: £50 Approx. per annum.

Local Authority: London Borough Of Camden

Council Tax Band: D

Energy Efficiency Rating		
	Current	Potential
Very energy efficient - lower running costs		
(92-100) A		
(81-91) B		
(69-80) C	74	80
(55-68) D		
(39-54) E		
(21-38) F		
(1-20) G		
Not energy efficient - higher running costs		
England, Scotland & Wales		EU Directive 2002/91/EC

Chestertons Camden & Kentish Town Sales

99-101 Parkway

Camden

London

NW1 7PP

camden@chestertons.co.uk

020 7267 2053

chestertons.co.uk

Barker Drive NW1 0JZ

Approx. Gross Internal Area = 49.7 sq m / 534 sq ft

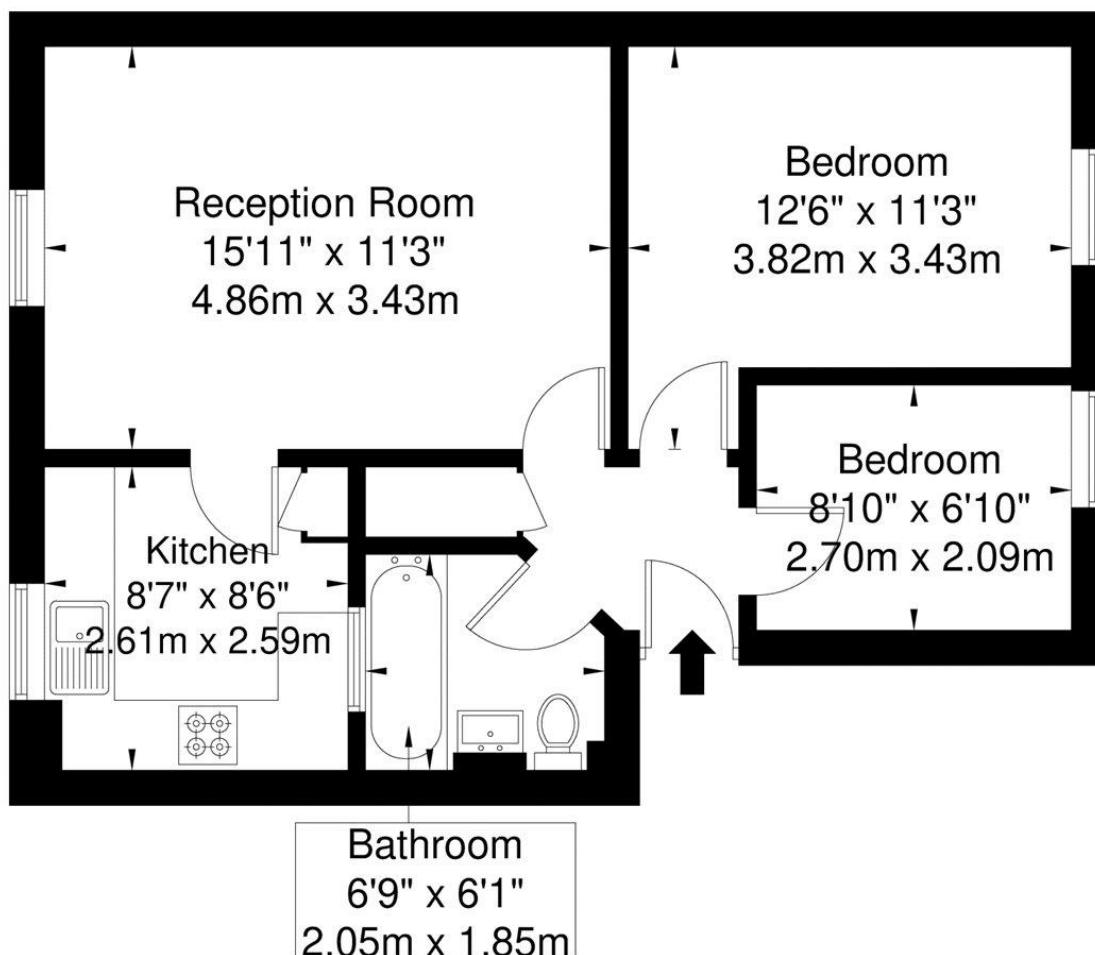

Second Floor

Ref

Copyright THE **BLÉU** PLAN

Disclaimer : Floor plan measurements are approximate and are for illustrative purposes only
While we do not doubt the floor plan accuracy and completeness, you or your advisors should
conduct a careful, independent investigation of the property in respect of monetary valuation

