



The Poplars

Montpelier Grove, NW5

Asking Price £625,000

This three bedroom apartment is located on one of Kentish Towns most sought after roads. The accommodation comprises of a bright and airy open plan reception with modern fully fitted kitchen, two double bedrooms, a further single bedroom/study room and a modern family bathroom. The property has been well finished with a neutral décor and wooden floors throughout and further benefits from the use of a communal garden. Being sold chain-free.



The Poplars

Montpelier Grove, NW5

- Excellent Location
- Two Double Bedrooms
- Modern Finish
- Communal Garden
- Study



Montpelier Grove is located moments from Kentish Town Road with its amenities, shops and restaurants, some of North London's best pubs and the station (Thameslink, Northern Line) with direct links all over London and beyond. Independent feeling Tufnell Park, village like Dartmouth Park and the open spaces of Hampstead Heath are all nearby and world famous Camden Town is within easy reach.

Tenure: Share of Freehold
Service Charge: £600 per annum
Ground Rent: £10
Local Authority: London Borough Of Camden
Council Tax Band: D

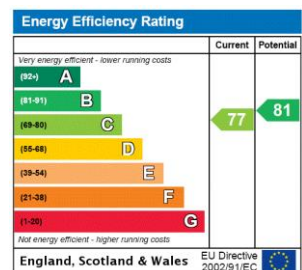

Chestertons Camden & Kentish Town Sales

99-101 Parkway
 Camden
 London
 NW1 7PP
 camden@chestertons.co.uk
 020 7267 2053
 chestertons.co.uk

The Poplars, Montpelier Grove, NW5

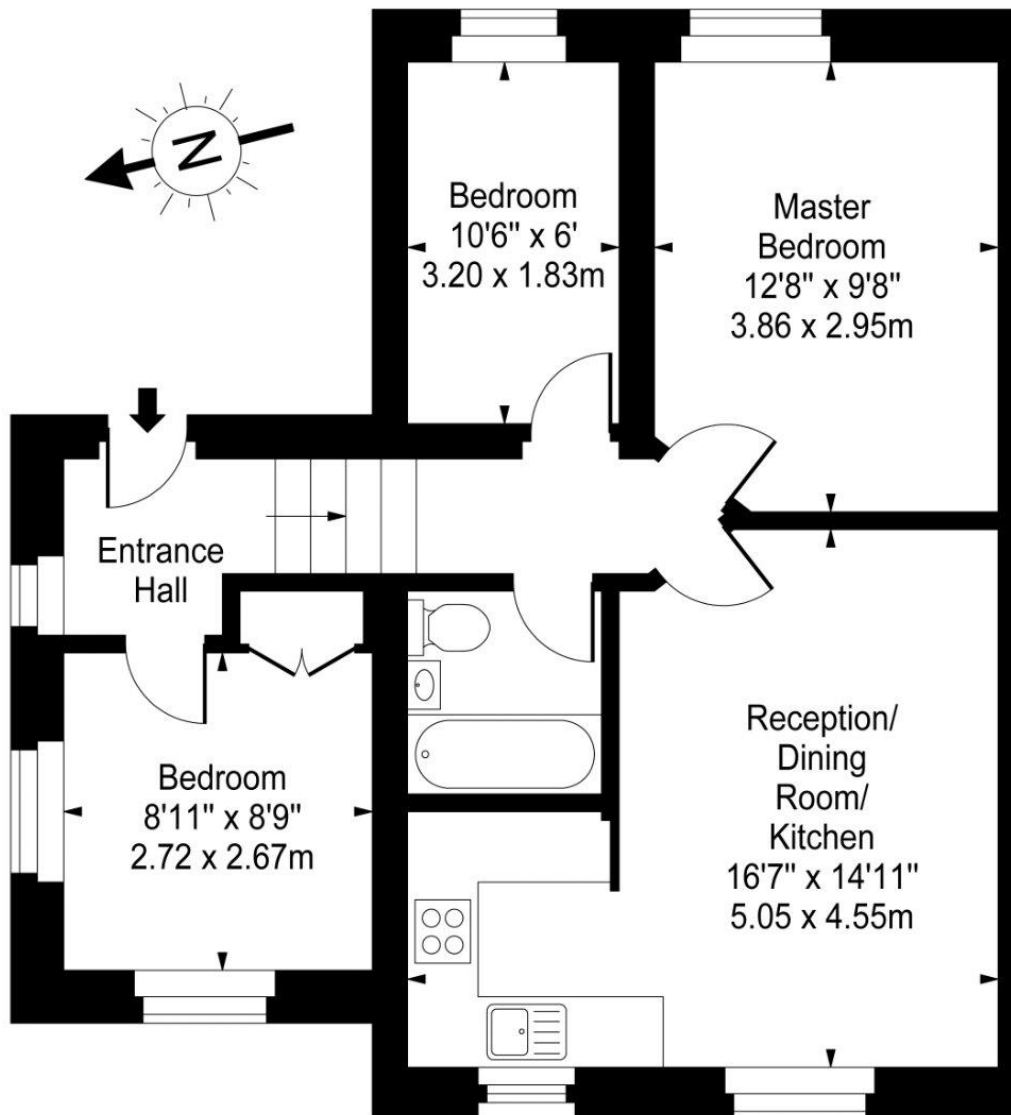

Ground Floor

Approx Gross Internal Area **620 Sq Ft - 57.60 Sq M**

For Illustration Purposes Only - Not To Scale

www.goldlens.co.uk

Ref. No. 006704K

