



# Park View House

Goldington Street, NW1

Asking Price £650,000

A wonderful three bedroom apartment located on the ninth floor of a well-regarded art deco block boasting fabulous views over the local area. The apartment features a bright and spacious reception room, separate kitchen, two double bedrooms, a well-proportioned third bedroom, bathroom and w/c. Additionally, there are 2 private balconies to the front and rear along with lift access.

**CHESTERTONS**



# Park View House

## Goldington Street, NW1

- Three Bedrooms
- Ninth Floor
- Exceptional Views
- 2 Balconies
- Excellent Location



Park View House is a well maintained purpose built block, gated with communal gardens. It is exceptionally well situated with amazing facilities, retail and experience destinations on your doorstep. It is moments from St Pancras International and the wider developments of Granary Square whilst in close proximity to Camden Town, West End and the City.

**Tenure:** Leasehold with 102 years remaining.

**Service Charge:** £4000 per annum.

**Ground Rent:** TBC

**Local Authority:** London Borough Of Camden

**Council Tax Band:** D

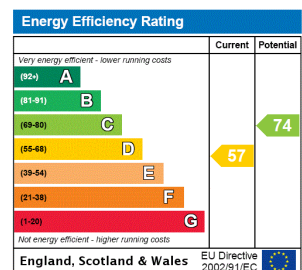

### Chestertons Camden & Kentish Town Sales

99-101 Parkway

Camden

London

NW1 7PP

camden@chestertons.co.uk

020 7267 2053

chestertons.co.uk

Park View House,  
Goldington Street



○ - Ceiling Height

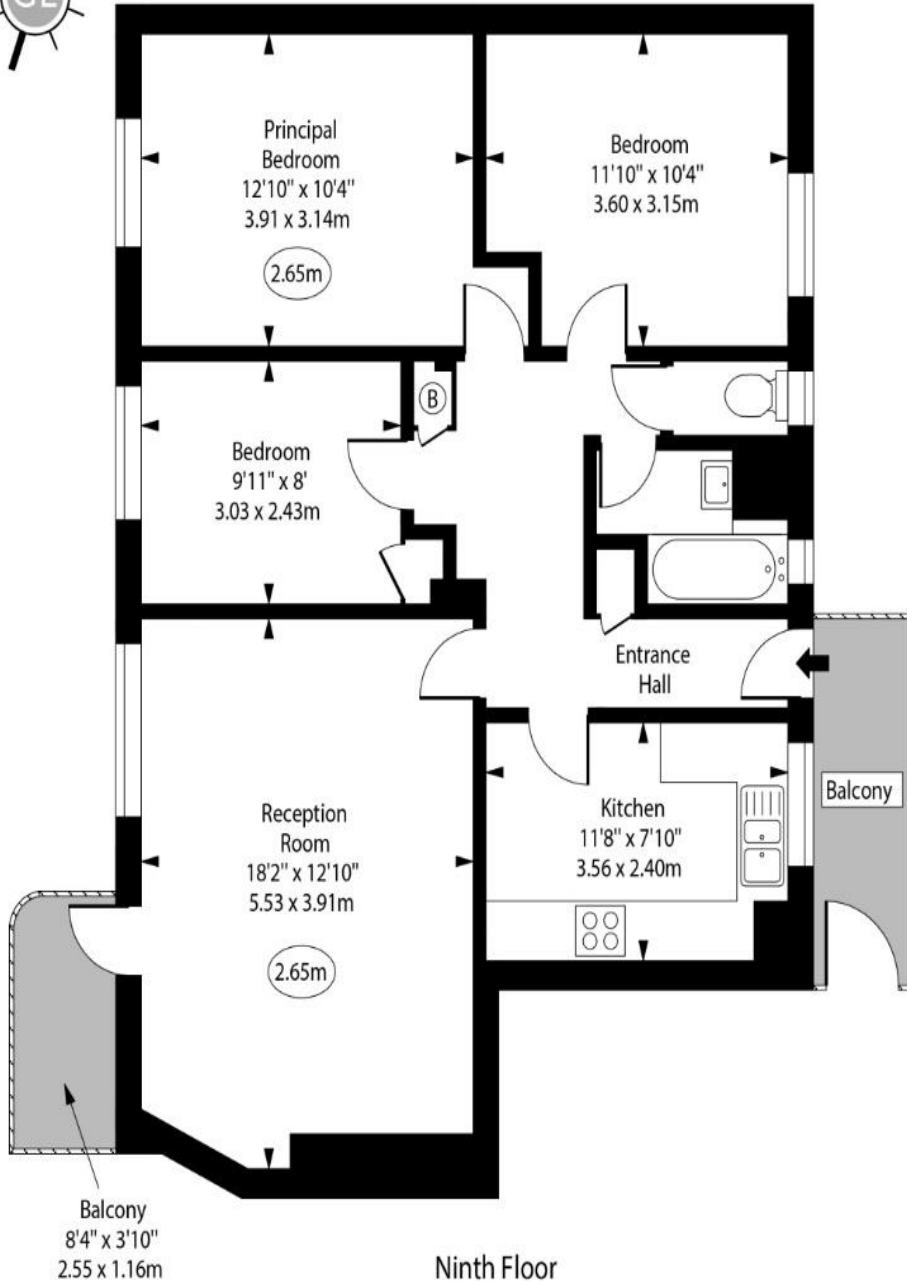

Gross Internal Area - 838 Sq Ft - 77.85 Sq M

Approx Gross Internal Area 838 Sq Ft - 77.85 Sq M

For Illustration Purposes Only - Not To Scale

[www.goldlens.co.uk](http://www.goldlens.co.uk)

Ref. No. 024242J

