



Milton Road

London, N6

Asking Price £459,950

A charming dual aspect apartment set over the first floor of a period conversion located in the popular Miltons area of Highgate. The property comprises; a spacious open plan kitchen and reception room, bright double bedroom and a modern bathroom.



Milton Road

London, N6

- Well presented
- Bright and airy
- Good entertaining space



Well located for the many amenities and transport links (Northern line) of Highgate (0.5 miles) and Archway (0.7 miles) as well the lovely green spaces of Highgate Woods, the Parkland Walk and Coolhurst Tennis and Squash club, which are both within close proximity.

Tenure: Leasehold with 961 years remaining.
Service Charge: £1526 per annum.
Ground Rent: £125 per annum.
Local Authority: Haringey
Council Tax Band: D

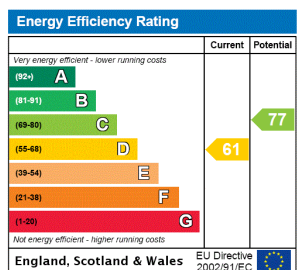

Chestertons Camden & Kentish Town Sales

99-101 Parkway
 Camden
 London
 NW1 7PP
 camden@chestertons.co.uk
 020 7267 2053
 chestertons.co.uk

Milton Road



○ - Ceiling Height

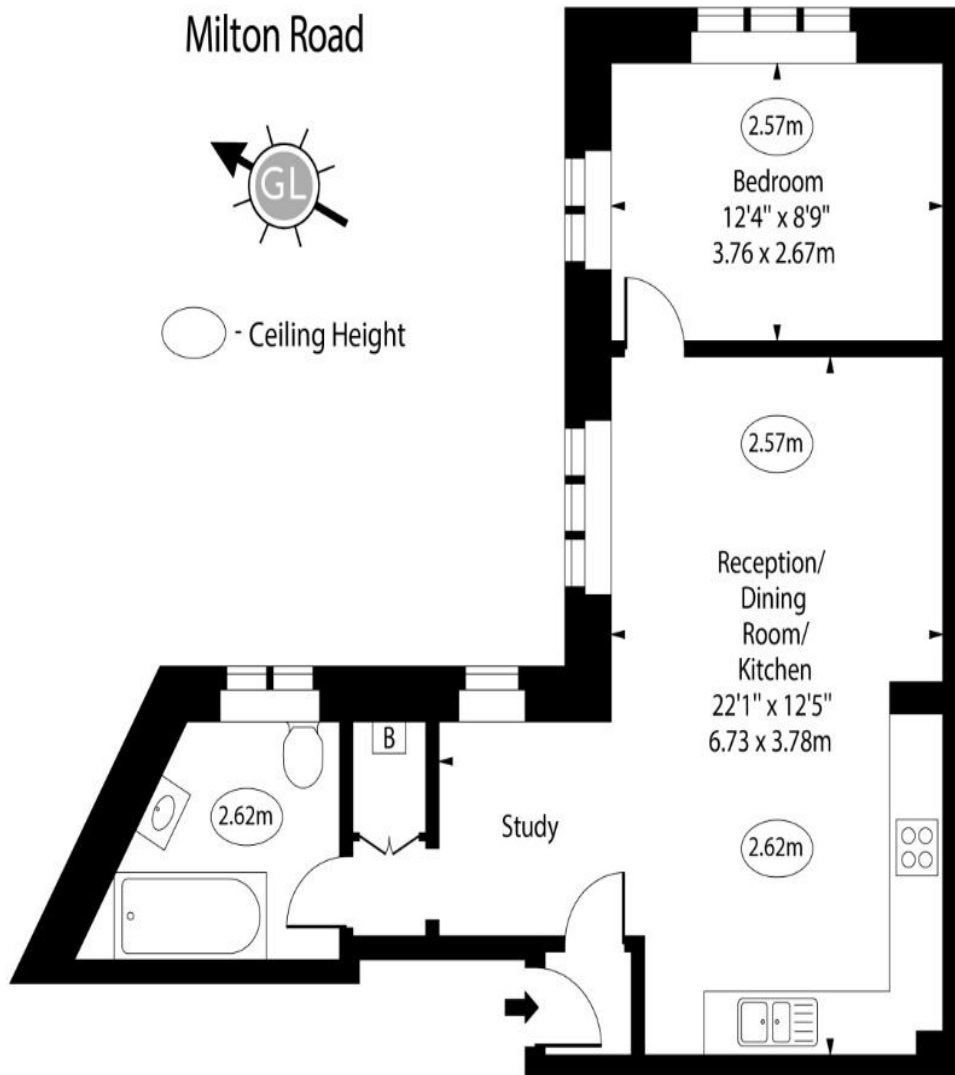

First Floor

Gross Internal Area - 528 Sq Ft - 49.05 Sq M

Approx Gross Internal Area 528 Sq Ft - 49.05 Sq M

For Illustration Purposes Only - Not To Scale

www.goldlens.co.uk

Ref. No. 022995M

