



Gosfield Street

London, W1W

Asking Price £950,000

Charming and elegant Fitzrovia two bedroom apartment found within this period mansion block on a quiet street and only a short distance from Marylebone High Street and the hustle and bustle of Oxford Street.



Gosfield Street

London, W1W

- Situated on the doorstep of some of the best local coffee shops and eateries, and moments from Regents Park.
- Second floor apartment with excellent ceiling height.
- Transport links include Great Portland Street and Oxford Circus stations.
- The brand new Cross Rail link at Bond Street station is also close by.



Charming and elegant Fitzrovia two bedroom apartment found within this period mansion block on a quiet street and just a short walk to Oxford Street. This lovely apartment also benefits from being only few doors away from trendy caf  s, restaurants and gastro pubs, as well as local amenities of Fitzrovia, along with strolling distance from Regents Park. Great Portland Street, Goodge Street and Oxford Circus underground stations are also close by so is the Marylebone, Soho, Covent Garden, Bloomsbury and Mayfair areas.

Tenure: Leasehold 971 years 11 months

Service Charge:  3000

Ground Rent: A peppercorn

Local Authority: City Of Westminster

Council Tax Band: F

Chestertons Covent Garden Sales

196 Shaftesbury Avenue

London

WC2H 8JF

coventgarden@chestertons.co.uk

020 3040 8300

chestertons.co.uk

Gosfield Street

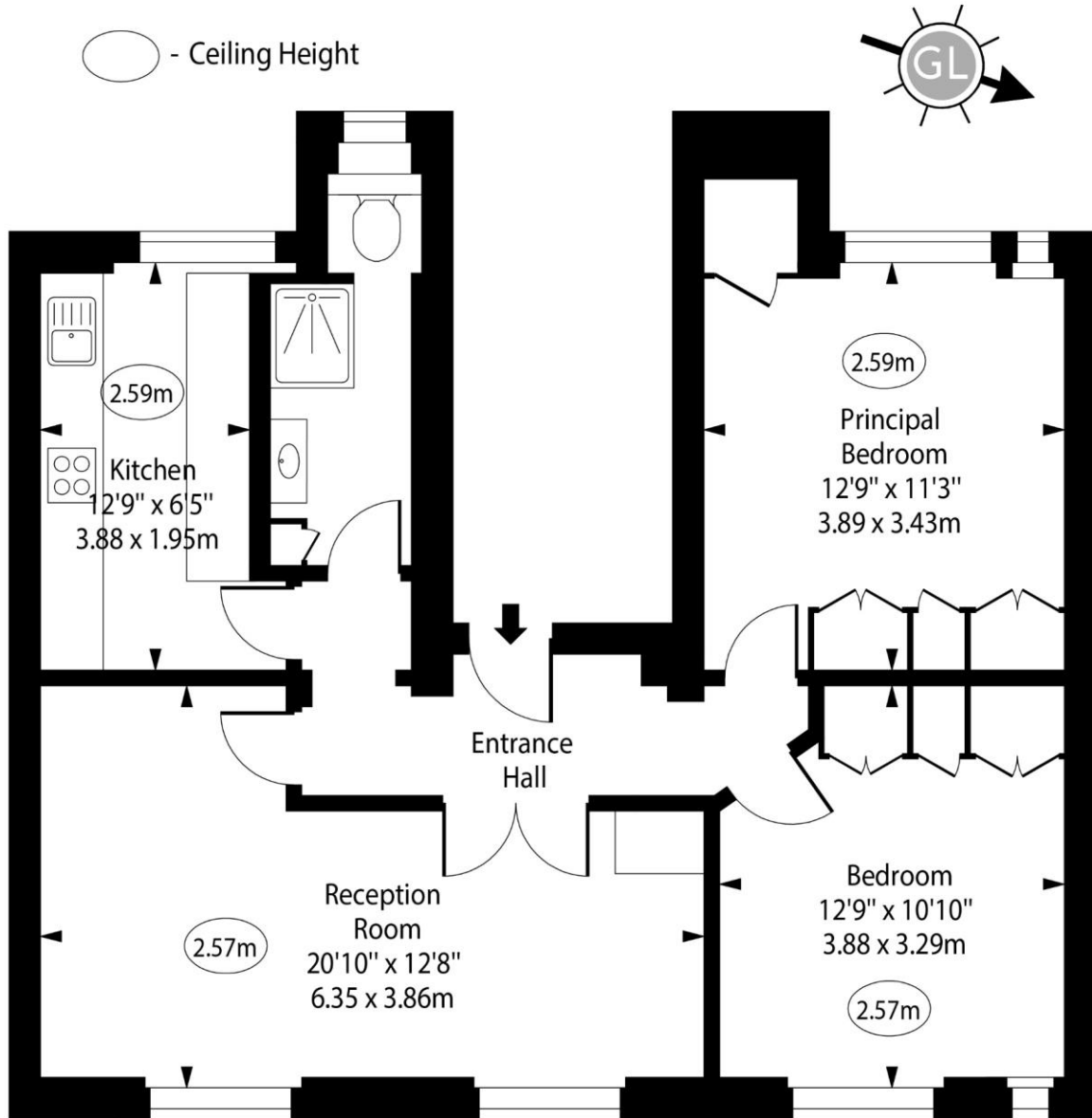

Second Floor

Approx Gross Internal Area 730 Sq Ft - 67.82 Sq M

For Illustration Purposes Only - Not To Scale

www.goldlens.co.uk

Ref. No. 022042R

