



Ridgmount Gardens

London, WC1E

Guide Price £625,000

An attractive two bedroom property forming part of a beautiful Victorian mansion with a porter and access to a private residents' gardens in Bloomsbury. Moments from Goodge Street underground station you are on the cusp of all the amenities nearby.



Ridgmount Gardens

London, WC1E

- Excellent transport links from Goodge Street, Euston Square and Kings Cross stations.
- Excellent ceiling height throughout, adding a sense of proportion and space.



An attractive two bedroom property forming part of a beautiful Victorian mansion with a porter and access to a private residents' gardens in Bloomsbury. Moments from Goudge Street underground station you are on the cusp of all the amenities nearby.

Tenure: Leasehold 129 years 4 months
Service Charge: £4840 including sinking funds (£2,200)
Ground Rent: £0^{plus Stamp duty 6% (1/1/2024)}
Local Authority: London Borough Of Camden
Council Tax Band: E

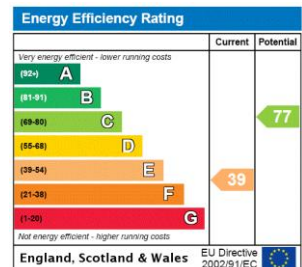

Chestertons Covent Garden Sales

196 Shaftesbury Avenue
 London
 WC2H 8JF
 coventgarden@chestertons.co.uk
 020 3040 8300
 chestertons.co.uk

Ridgmount Gardens

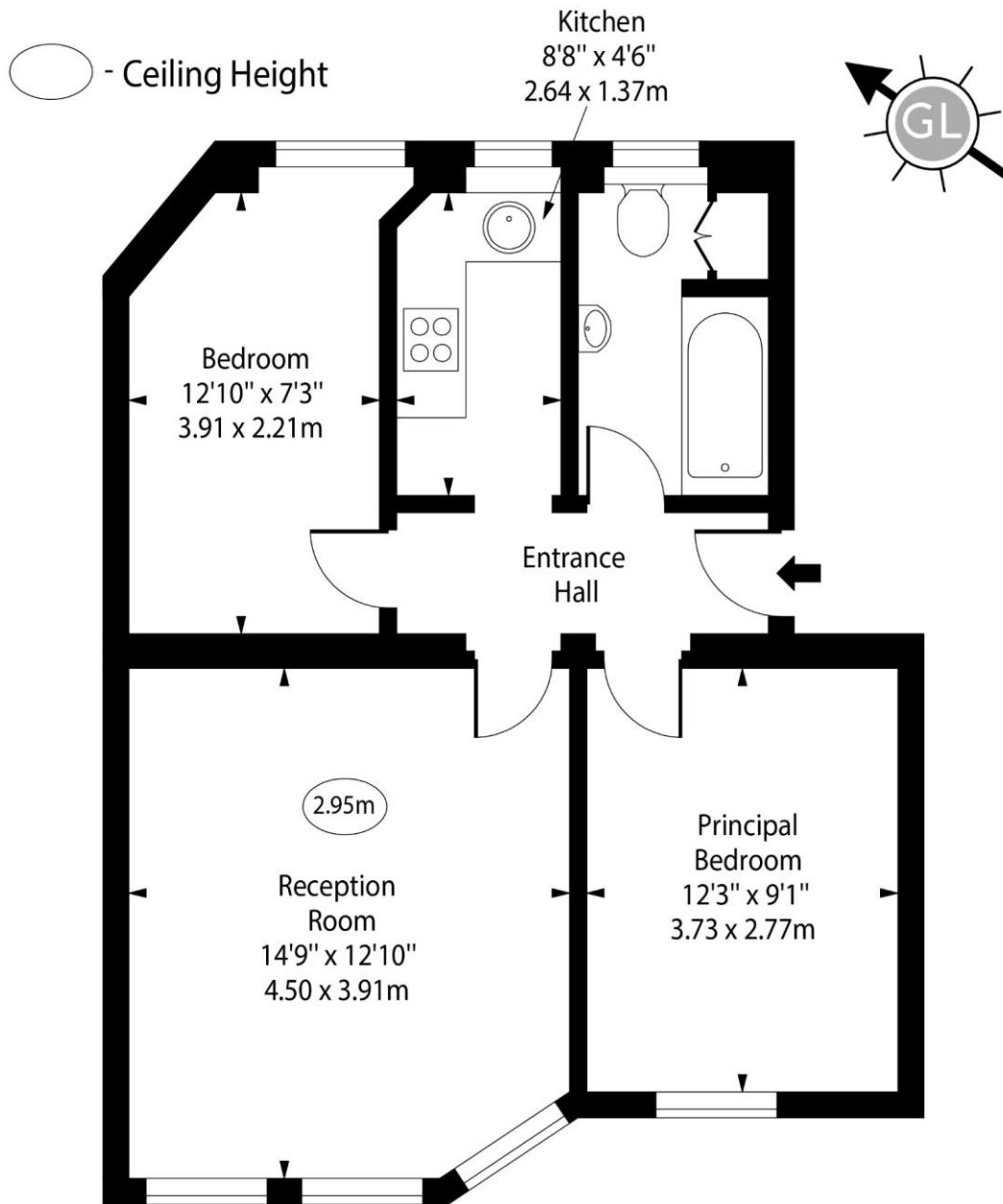

Lower Ground Floor

Approx Gross Internal Area 561 Sq Ft - 52.12 Sq M

For Illustration Purposes Only - Not To Scale

www.goldlens.co.uk

Ref. No. 020805E

