



Tower Street

London, WC2H

Asking Price £1,000,000

Manhattan style apartment forming part of a converted warehouse building in the Seven Dials district of Covent Garden. This bright high ceilinged flat has 2 bedrooms and is ideally located for all the amenities the neighbourhood has to offer.



Tower Street

London, WC2H

- Covent Garden, Leicester Square & Tottenham Court Road stations are all close by.
- Seven Dials neighbourhood is an oasis of cobbled streets, designer shops , boutique restaurants and cafes.
- Lift access.



Two bedroom apartment in Tower Street, a tucked away small road, connecting Monmouth and Earlham Street, in a uniquely quiet spot, on the edge of the bustling Seven Dials village, located between Covent Garden and Soho in the heart of the West End. The property comprises a spacious reception room with high ceilings, sash windows and exposed brick work with a separate kitchen.

Tenure: Leasehold 98 years 2 months

Service Charge: £3,641 in 2022

Ground Rent: £400

Local Authority: London Borough of Camden

Council Tax Band: G

Chestertons Covent Garden Sales

196 Shaftesbury Avenue

London

WC2H 8JF

sales.coventgarden.enquiries@chestertons.co.uk

020 3040 8300

[chestertons.co.uk](https://www.chestertons.co.uk)

Tower Street

○ - Ceiling Height

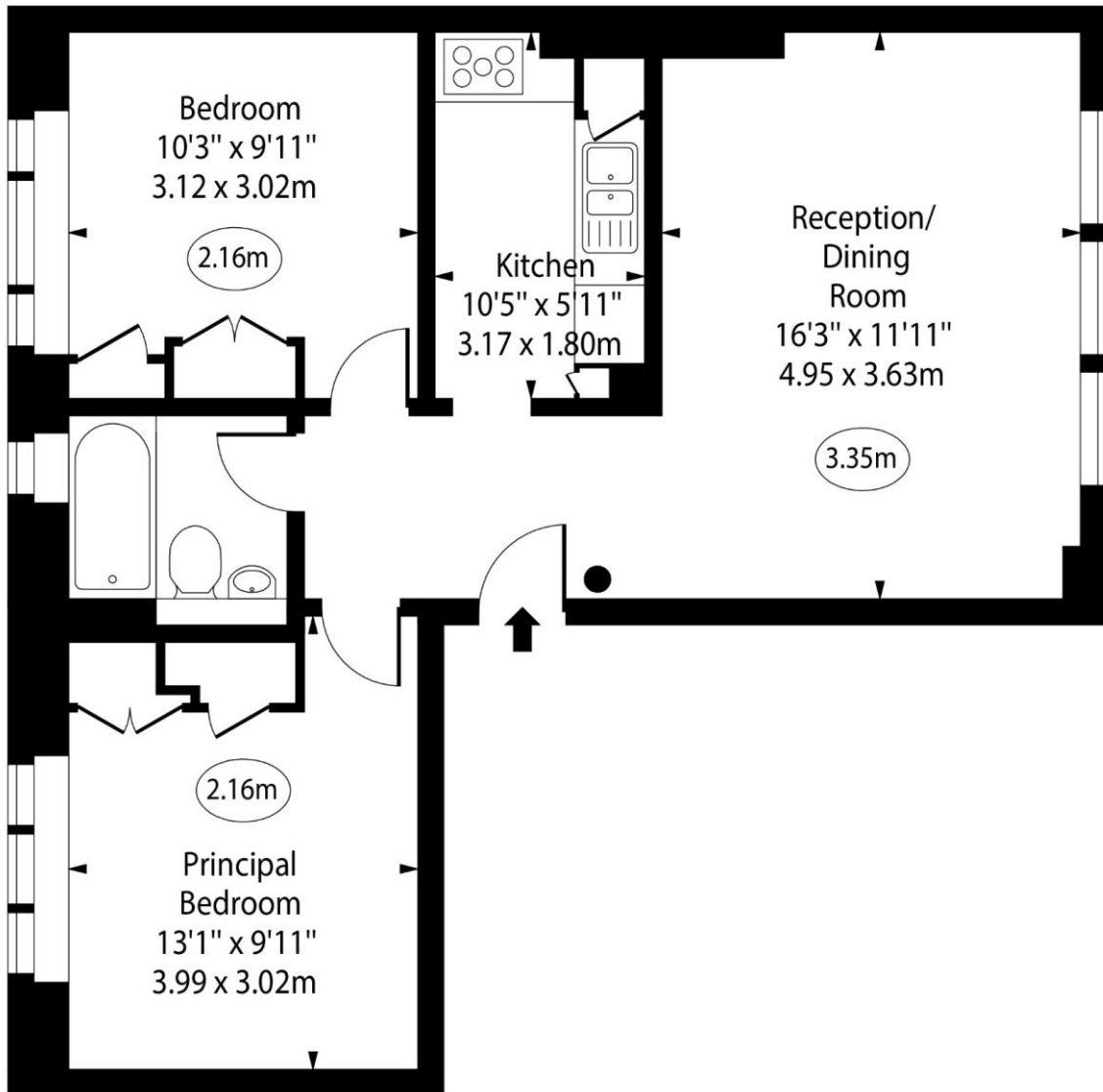

First Floor

Approx Gross Internal Area 606 Sq Ft - 56.30 Sq M

For Illustration Purposes Only - Not To Scale

www.goldlens.co.uk

Ref. No. 021191M

