



Phoenix Street

London, WC2H

Asking Price £1,100,000

Modern two bedroom apartment on Phoenix Street, moments away from the vibrant districts of Soho, Seven Dials and Covent Garden. This bright and spacious property features full width floor to ceiling windows and south facing balcony.



Phoenix Street

London, WC2H

- 2 BEDROOMS
- STATE OF THE ART TECHNOLOGY FLAT
- UNDERFLOOR HEATING
- LONG LEASE



Tucked away on Phoenix Street, discover an entertainer's haven perfectly balanced between London's most vibrant neighbourhoods - the light-filled refinement of our two bedroom apartment with its minimalist interior will inspire and relax.

Upon entering, the clean modern lines and warmth of the resin floors create an airy, uncluttered flow throughout the space. State-of-the-art technology integrates intuitively into each room, ready to respond and assist so you can fully enjoy the spa-like tranquillity.

Floor to ceiling windows perfectly frame Covent Garden's charm, including the neighbouring Phoenix Garden, while also capturing the energy of Theatreland just steps from your private urban retreat.

Tenure: Leasehold 105 years 8 months

Service Charge: £4425

Ground Rent: £0

Local Authority: London Borough Of Camden

Council Tax Band: F

Chestertons Covent Garden Sales

196 Shaftesbury Avenue

London

WC2H 8JF

coventgarden@chestertons.co.uk

020 3040 8300

chestertons.co.uk

Phoenix Street

○ - Ceiling Height

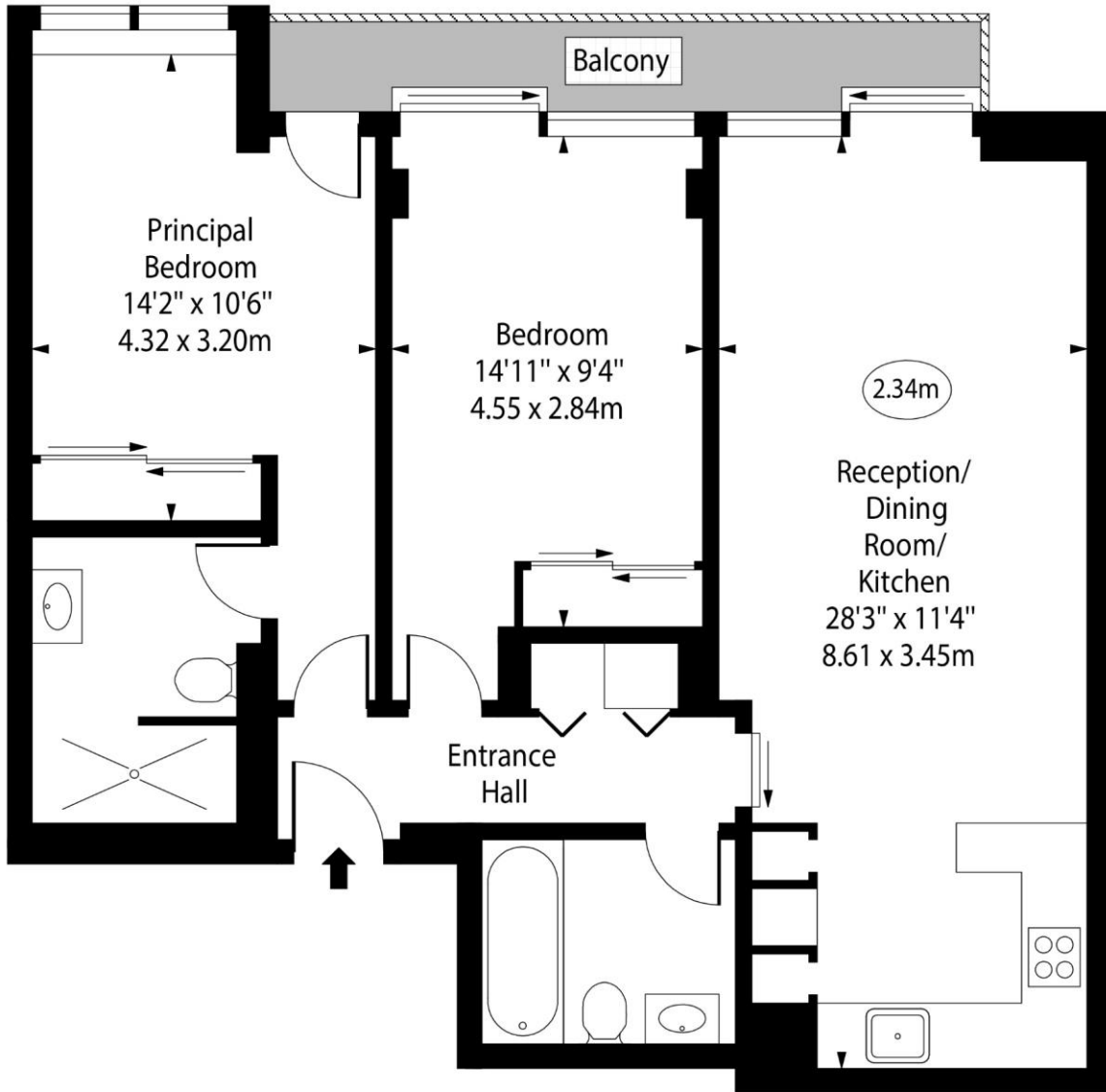

Second Floor

Approx Gross Internal Area 824 Sq Ft - 76.55 Sq M

For Illustration Purposes Only - Not To Scale

www.goldlens.co.uk

Ref. No. 022448K