



Fletcher Buildings

Martlett Court, WC2B

Asking Price £570,000

Contemporarily designed one bedroom flat on the second floor of this highly sought after gated development in Central Covent Garden. Martlett Court enjoys beautifully landscaped gardens and it is a traffic free location.



Fletcher Buildings

Martlett Court, WC2B

- Bright apartment perfectly placed to enjoy all that Central London has to offer.
- Forming part of a well maintained gated red brick building tucked away on a pedestrianised street.



Contemporarily designed one bedroom flat on the second floor of this highly sought after gated development in Central Covent Garden. Martlett Court enjoys beautifully landscaped gardens and it is a traffic free location.

Tenure: Leasehold 89 years 9 months
Service Charge: £1055.53 As advised by the seller.
Ground Rent: £10
Local Authority: City Of Westminster
Council Tax Band: C

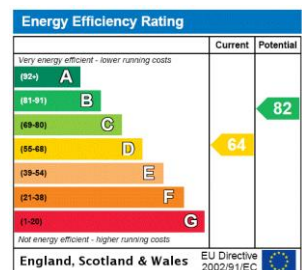

Chestertons Covent Garden Sales

196 Shaftesbury Avenue
 London
 WC2H 8JF
 sales.coventgarden.enquiries@chestertons.com
 020 3040 8300
 chestertons.com

Fletcher Buildings, Martlett Court

○ - Ceiling Height

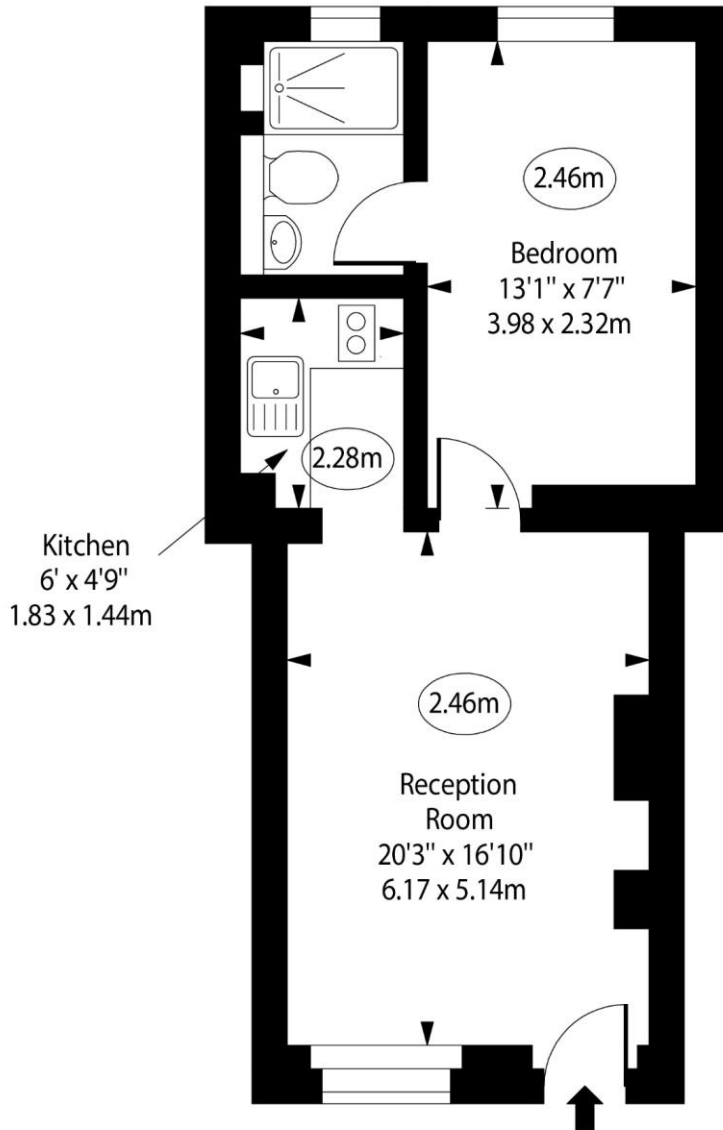

Third Floor

Approx Gross Internal Area 323 Sq Ft - 30.00 Sq M

For Illustration Purposes Only - Not To Scale

www.goldlens.co.uk

Ref. No. 018008R

