



Ingestre Court

Ingestre Place, W1F

Offers in excess of £775,000

Contemporary top floor two bedroom flat with sensational views over the London's skyline. This flat is positioned in central Soho whilst also being within walking distance from Mayfair. The location benefits from the huge variety of amenities.



Ingestre Court

Ingestre Place, W1F

- ** The property is being offered on an extended lease of 175 years remaining **
- Ingestre Court is found on Ingestre Place off Broadwick Street and so is marvellously located for access to the West End.



Contemporary top floor two bedroom flat with sensational views over the London's skyline. This flat is positioned in central Soho whilst also being within walking distance from Mayfair. The location benefits from the huge variety of amenities. The property is being offered on an extended lease of 175 years remaining.

Tenure: Leasehold 84 years 1 months
Service Charge: £2400 approx. as advised by seller (includes heating billing)
Ground Rent: £10
Local Authority: City Of Westminster
Council Tax Band: D

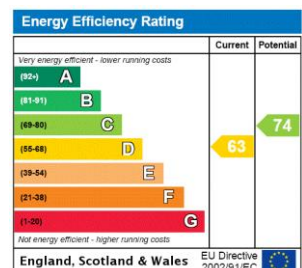

Chestertons Covent Garden Sales

196 Shaftesbury Avenue
 London
 WC2H 8JF
 coventgarden@chestertons.co.uk
 020 3040 8300
 chestertons.co.uk

Ingestre Court

○ - Ceiling Height

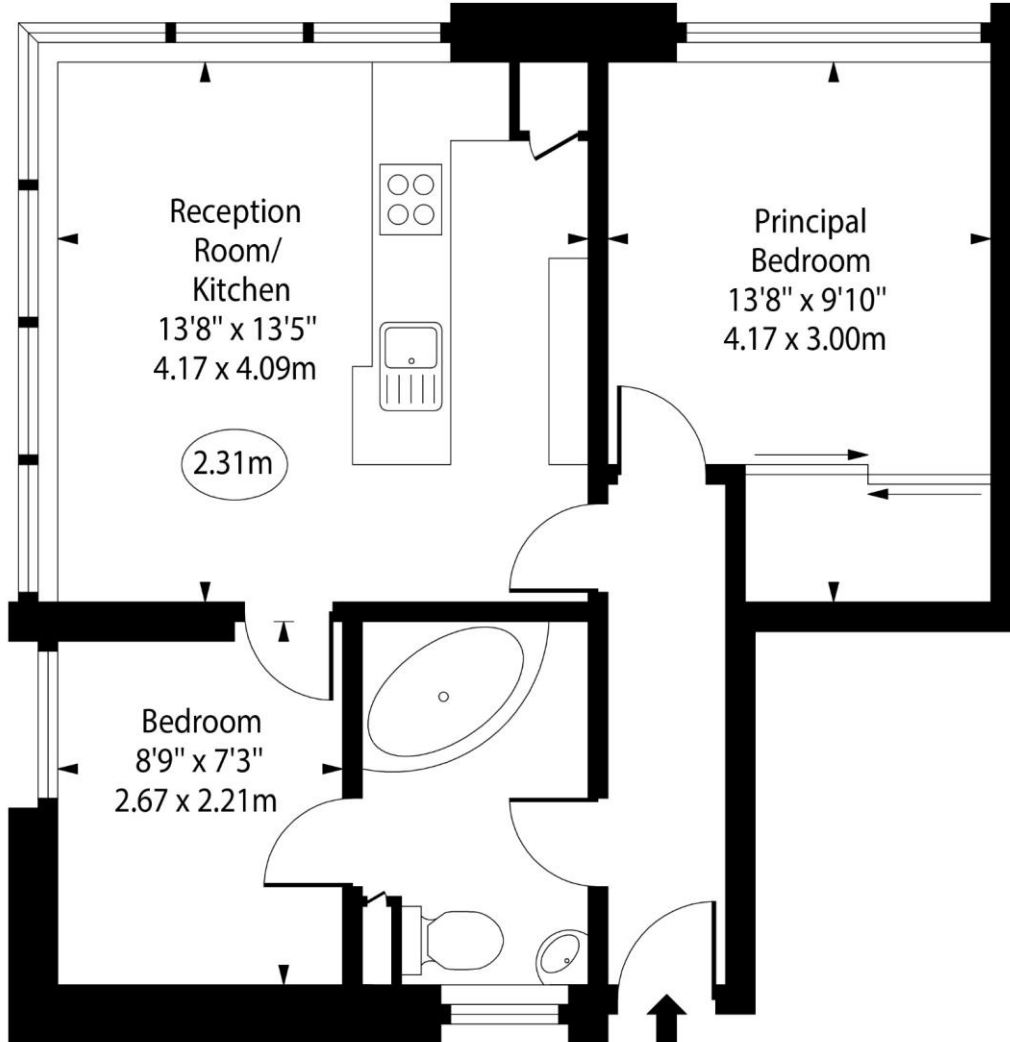

Fifteenth Floor

Approx Gross Internal Area

492 Sq Ft - 45.71 Sq M

For Illustration Purposes Only - Not To Scale

www.goldlens.co.uk

Ref. No. 020567K

