



# New Oxford Street

London, WC1A

Asking Price £915,000

Two bedroom apartment situated on the first floor of a charming period building near the British Museum on New Oxford Street. This property enjoys high ceilings, wooden flooring throughout and large sash windows.



# New Oxford Street

## London, WC1A

- Tottenham Court Road and Holborn tube stations are very close by, as well as the Cross Rail.
- Theatres and restaurants of the West End are also on your doorstep, as well as Kings College, LSE and UCL campuses.





A superb two bedroom apartment located on the first floor of a period building on New Oxford Street. This property enjoys high ceilings and wooden flooring throughout with large sash windows. Boasting a prime location in Bloomsbury, offering a superb selection of amenities with the desirable Covent Garden located just moments away.

**Tenure:** Leasehold 963 years 7 months

**Service Charge:** £0

**Ground Rent:** £0

**Local Authority:** London Borough of Camden

**Council Tax Band:** F

Energy Efficiency Rating		
	Current	Potential
Very energy efficient - lower running costs		
<b>A</b> (94-100)		
<b>B</b> (81-93)		
<b>C</b> (69-80)	74	81
<b>D</b> (55-68)		
<b>E</b> (39-54)		
<b>F</b> (21-38)		
<b>G</b> (1-20)		
Not energy efficient - higher running costs		
England, Scotland & Wales EU Directive 2002/91/EC		

### *Chestertons Covent Garden Sales*

196 Shaftesbury Avenue

London

WC2H 8JF

sales.coventgarden.enquiries@chestertons.co.uk

020 3040 8300

chestertons.co.uk

## New Oxford Street

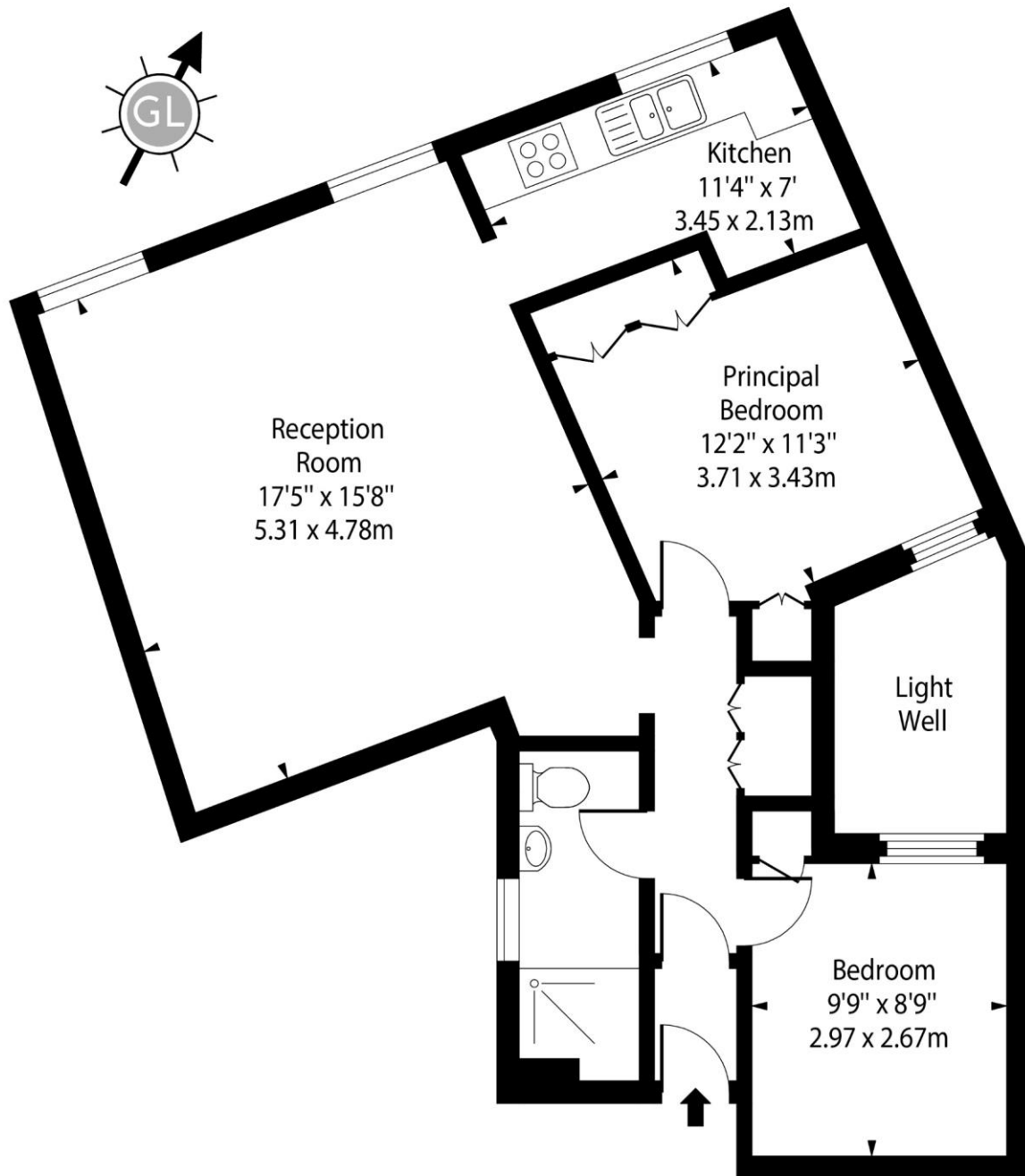

First Floor

Approx Gross Internal Area      686 Sq Ft - 63.73 Sq M

For Illustration Purposes Only - Not To Scale

[www.goldlens.co.uk](http://www.goldlens.co.uk)

Ref. No. 020249AN

