



Theobalds Road

London, WC1X

£850,000 Asking Price

A well-kept three-bedroom apartment within a period Victorian terrace building, located in the extremely popular area of Bloomsbury, near Lamb's Conduit Street and Holborn station.



Theobalds Road

London, WC1X

- Walking distance to Holborn underground tube station (Central and Piccadilly lines), Chancery Lane Station underground tube station (Central line) and Russell Square underground tube station (Piccadilly line).
- Small well-managed building in Theobalds Road Bloomsbury WC1 close to the junction with Red Lion Street.



A well-kept three-bedroom apartment within a period Victorian terrace building, located in the extremely popular area of Bloomsbury, near Lamb's Conduit Street and Holborn station. Nearby to this apartment are a selection of outstanding universities catering to a collection of different courses, BPP University Law School, The City Law School, LSE, UCL, Kings College London, University of the Arts London amongst others. Located on the edge of Bloomsbury, this area is connected within walking distance of the West End as well as The City with excellent public transport links.

Tenure: Leasehold 155 years & 11 months remaining (24.01.2022)

Service Charge: TBC

Ground Rent: TBC

Chestertons Covent Garden Sales

196 Shaftesbury Avenue

London

WC2H 8JF

sales.coventgarden.enquiries@chestertons.com

020 3040 8300

chestertons.com

Theobalds Road

 - Ceiling Height

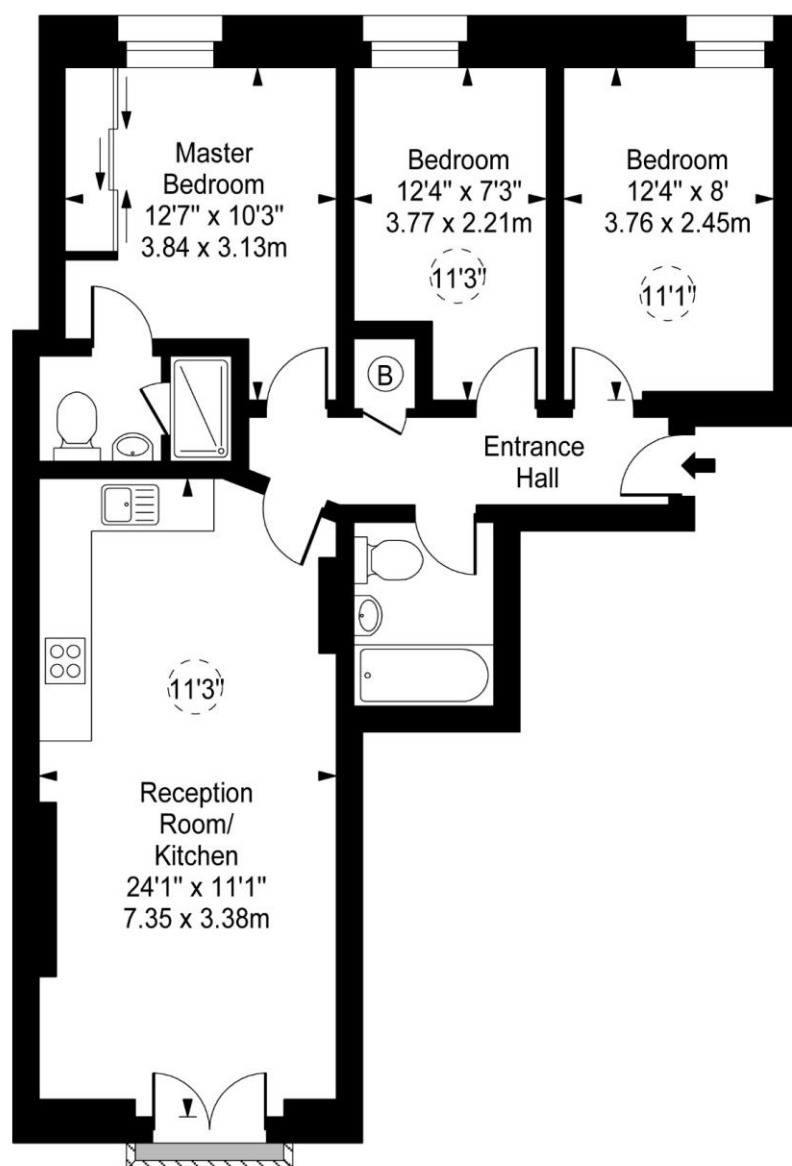
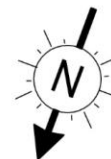

First Floor

Approx Gross Internal Area **722 Sq Ft - 67.07 Sq M**

For Illustration Purposes Only - Not To Scale

www.goldlens.co.uk

Ref. No. 015435R

