



Upper Street

Islington, N1

Guide Price £260,000

Being sold via Secure Sale online bidding. Terms & Conditions apply. A bright 1 bedroom apartment set on the second floor of this mid-terraced property above commercial premises, close to the junction with Barnsbury Street.



Upper Street

Islington, N1

- Central Location
- Immediate 'exchange of contracts' available
- Being sold via 'Secure Sale'
- Contemporary Style
- Within Walking Distance of Highbury & Islington Station
- Close to Shops, Cafes & Restaurants



Being sold via Secure Sale online bidding. Terms & Conditions apply.

A bright and well-proportioned one double bedroom apartment set on the second floor of this mid-terraced property above commercial premises, close to the junction with Barnsbury Street. The property has recently been refurbished to a high standard.

Set within the desired Upper Street conservation area and affords superb proximity to all that Upper Street has to offer, including independent boutiques, restaurants, patisseries, salons, delis, a post office, the most fabulous hardware shop, and the Almeida theatre. The greenery and amenities (including gym, swimming pool and outdoor tennis courts) of Highbury Fields are just a few minutes away, and the gastronomic delights of Trullo and Prawn on the Lawn can be found nearby on St Paul's Road. Transport links are exceptional: Highbury and Islington station as well as Angel Station and buses provide regular access to Central and East London.

Pattinson Auction are working in Partnership with the marketing agent on this online auction sale and are referred to below as 'The Auctioneer'.

Tenure: Leasehold 87 years 11 months

Service Charge: £250 This is the share of the annual buildings insurance, additional costs are at an ad-hoc basis.

Ground Rent: £75

Local Authority: Islington

Council Tax Band: C

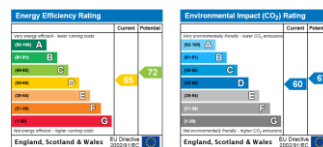

Chestertons Islington Sales

327-329 Upper Street

Islington

London

N1 2XQ

islington@chestertons.co.uk

020 7359 9777

chestertons.co.uk

Upper Street, Islington, N1

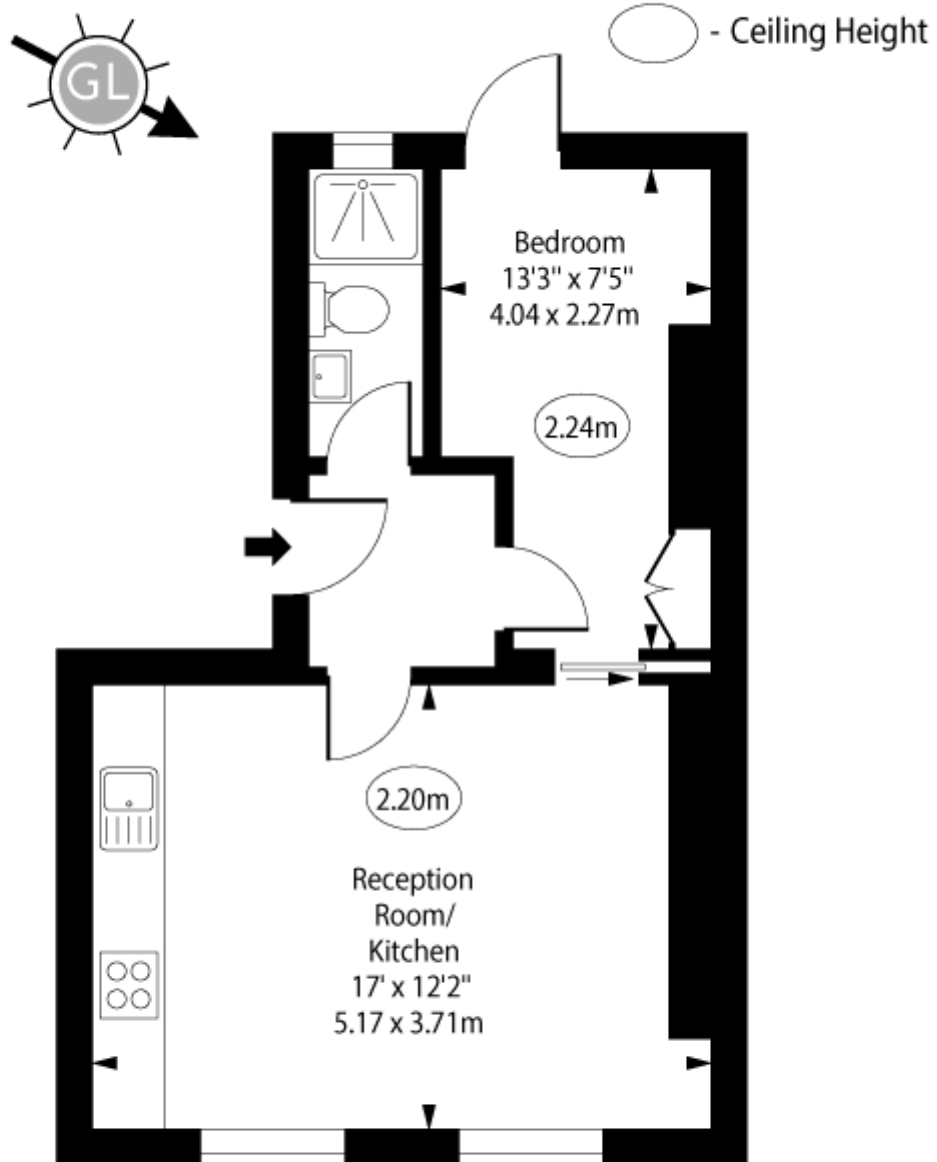

Second Floor

Approx Gross Internal Area 360 Sq Ft - 33.44 Sq M

For Illustration Purposes Only - Not To Scale

www.goldlens.co.uk

Ref. No. 027330J

