



# Listria Park

Stoke Newington, N16

Guide Price £1,875,000

A once in a lifetime opportunity to acquire one of the most unassuming homes in Stoke Newington, available for the first time in c 50 years, having been within the same families ownership since 1974, enjoying one of the borough's most impressive gardens, spanning a staggering c 127" x 52, backing directly on to Abney Park, which has been fully restored having recently been awarded over £5million of Lottery Money.



# Listria Park

## Stoke Newington, N16

- Four/Five bedrooms
- Three bathrooms
- Ornate period details throughout
- Owned within the same family for c 50 years
- Phenomenal South facing private garden spanning c 127 ft
- Well placed for access to Stoke Newington Church Street



Accommodation is substantial, light filled and unique, comprising; a dual reception space set at the front of the ground floor, which fans out to create extra width space, owing to the position of the home on the street. This space retains ornate features which include, ceiling roses, coving and a beautiful marble fireplace. There are French doors, which along with the kitchen/dining space, complete with Aga, provides access to the phenomenal garden, measuring c 127 x 52 ft, with various sections, ideal for entertaining and offering huge scope (STPP) to extend into. It should be noted that the current owners added the Canadian hardwood, "Amdega" conservatory, dubbed the Rolls Royce of conservatories. The first floor houses two large double bedrooms, the front is sun soaked courtesy of the uninterrupted views opposite, again courtesy of the houses position on the street. An additional, large double bedroom (with ensuite) sits behind, retaining an original fireplace and overlooking the greenery of the rear garden. There is another smaller double bedroom on the half landing at the rear, with a family bathroom set next to it. There are two double bedrooms and another family bathroom on the top floor, with the "L" shaped dormer housing the smaller room and the larger double bedroom, with Juliette balcony overlooking the gardens at the front. Listria Park is located moments from Stoke Newington Church Street and within close proximity to the greenery and amenities of Clissold & Abney Park. Stoke Newington Church Street provides superb local shopping and a wide range of eateries. Transport is also superb, with Stoke Newington Station only moments away with direct trains to Liverpool Street which take on average 14 minutes

**Tenure:** Freehold  
**Local Authority:** Hackney  
**Council Tax** Band E

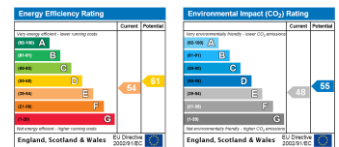

### Chestertons Islington Sales

327-329 Upper Street  
 Islington  
 London  
 N1 2XQ  
 islington@chestertons.co.uk  
 020 7359 9777  
 chestertons.co.uk

# LISTRIA PARK, N16

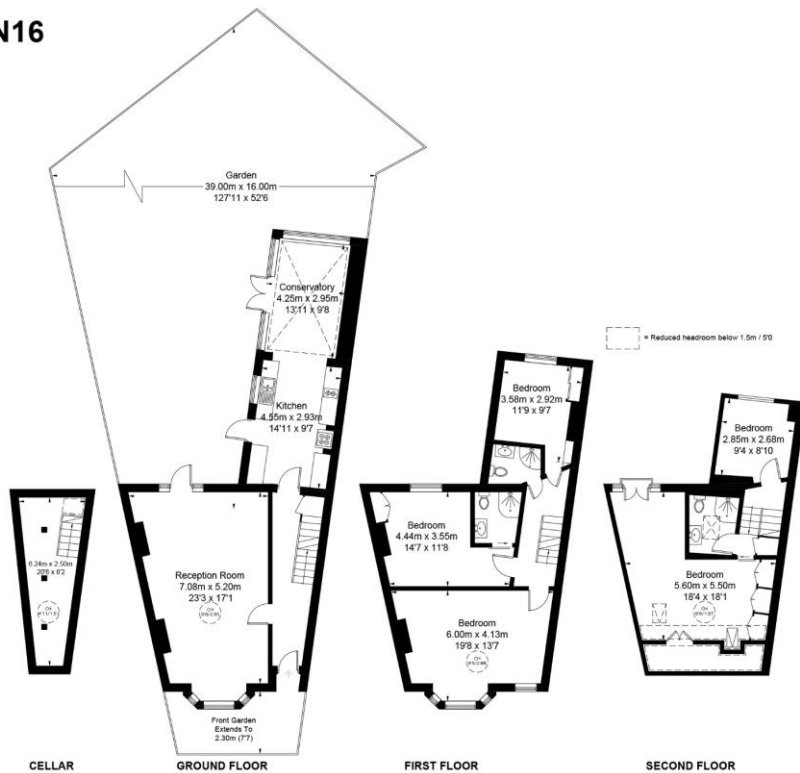
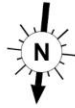

APPROXIMATE GROSS INTERNAL AREA  
 CELLAR = 112 SQ FT / 10.4 SQ M (EXCLUDING REDUCED HEADROOM)  
 GROUND FLOOR = 757 SQ FT / 70.3 SQ M  
 FIRST FLOOR = 630 SQ FT / 58.5 SQ M  
 SECOND FLOOR = 401 SQ FT / 37.3 SQ M (EXCLUDING REDUCED HEADROOM)  
 REDUCED HEADROOM = 87 SQ FT / 8.1 SQ M  
 TOTAL = 1987 SQ FT / 184.6 SQ M

THIS PLAN IS FOR LAYOUT GUIDANCE ONLY. NOT DRAWN TO SCALE UNLESS STATED. WINDOWS AND DOOR OPENINGS ARE APPROXIMATE. WHILST EVERY CARE IS TAKEN IN THE PREPARATION OF THIS PLAN, PLEASE CHECK ALL DIMENSIONS, SHAPES AND COMPASS BEARINGS BEFORE MAKING ANY DECISIONS RELIANT UPON THEM. (ID1113685)

Chesterton UK Services Limited trading as Chestertons for themselves and for the vendor of this property whose agents they are, give notice that (i) these particulars do not constitute any part of an offer or contract, (ii) all statements contained within these particulars are made without responsibility on the part of Chestertons or the vendor, (iii) whilst made in good faith, none of the statements contained within these particulars are to be relied upon as a statement or representation of fact, (iv) any intending purchasers must satisfy themselves by inspection or otherwise as to the correctness of each of the statements contained within these particulars, (v) the vendor does not make or give either Chestertons or any person in their employment any authority to make or give representation or warranty whatsoever in relation to this property. Wide angle lenses may be used. ©Copyright Chestertons | Chesterton UK Services Limited | Registered Office 40 Connaught Street, Hyde Park, London W2 2AB Registered Company Number 05334580.



This paper is 100% recyclable