



Ockendon Mews

Ockendon Road, N1

Asking Price £800,000

A fabulous 2 double bedroom lateral apartment spanning 1,218sq ft across the ground floor of this secure gated conversion of a former umbrella factory.



Ockendon Mews

96 Ockendon Road, N1

- Hugely impressive 1,218sq ft 2 double bedroom apartment
- Vast 27ft X 23ft reception room
- Separate kitchen
- Quiet gated mews
- Conversion of a former umbrella factory
- Superb access to transport & amenities



A fabulous 2 double bedroom lateral apartment spanning 1,218sq ft across the ground floor of this secure gated conversion of a former umbrella factory. Upon entry one is greeted by an immense feeling of space with a wonderfully wide and welcoming entrance hall from which all of the rooms are accessed. The vast 27ft X 23ft reception room is particularly impressive and with the sheer volume of space lends itself as a multi-functional room. There is a separate kitchen, 2 good sized double bedrooms and a main bathroom. Ockendon Mews is a small, quiet gated development nestled neatly in a popular residential location. Transport can be found at Essex Road Station (trains into the city), Canonbury station (London Overground), Highbury & Islington station (National Rail & Victoria Line) and of course Angel Underground (Northern Line) as well as a range of buses on Essex Road giving easy access to the City and West End. The greenery of both New River Walk & St Paul's Shrubbery are close by.

Tenure: Share of Freehold 98 years 9 months

Service Charge: £4350

Ground Rent: £N/A

Local Authority: Islington Council

Council Tax Band: E

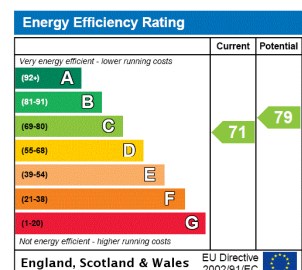

Chestertons Islington Sales

327-329 Upper Street

Islington

London

N1 2XQ

islington@chestertons.co.uk

020 7359 9777

chestertons.co.uk

Ockendon Mews,
Ockendon Road, N1

○ - Ceiling Height

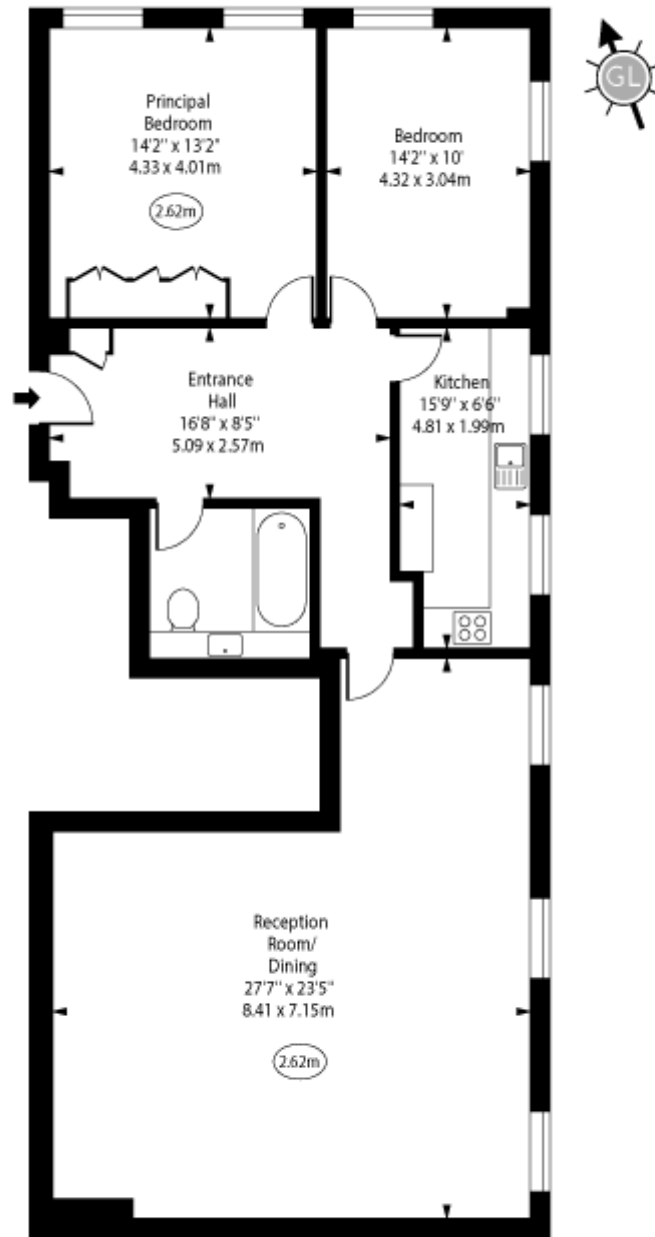

Ground Floor

Approx Gross Internal Area 1218 Sq Ft - 113.15 Sq M

For Illustration Purposes Only - Not To Scale
www.goldlens.co.uk
Ref. No. 024083J