



Brondesbury Park, NW6

TO LET - £2,950 Per Month

AVAILABLE TO LET is this well presented three bedroom duplex apartment, set within a mid-century apartment building in the heart of Brondesbury Park.

Offering 1156 sq ft of accommodation, the Second Floor comprises a bright reception room with access to the private balcony, a separate fitted kitchen, a double bedroom and a three piece bathroom suite. The Third Floor offers two double bedrooms with fitted wardrobes and two bathrooms (one en-suite). The apartment benefits from secure off-street parking, lift service, and well-maintained communal gardens.

The property is a short walk from the varied amenities of Willesden Green, Queen's Park, and Kensal Rise. Local transport links include Willesden Green (Jubilee - Zone 2), Brondesbury Park (Overground), and Queen's Park (Bakerloo - Zone 2).

- Spacious 3 bedroom Duplex Flat
- Offering 1156 sq ft of accommodation
- Spacious reception/dining room with a balcony
- Gated development with off-street parking & a lift
- COUNCIL: Brent (E)
- Deposit: £3,403

020 8450 9377

rentals@cameronsstiff.co.uk

cameronsstiff.co.uk



Brondesbury Park, London, NW6

Approximate Area = 1156 sq ft / 107.4 sq m (excludes restricted head height)

For identification only - Not to scale



Denotes restricted head height

THIRD FLOOR

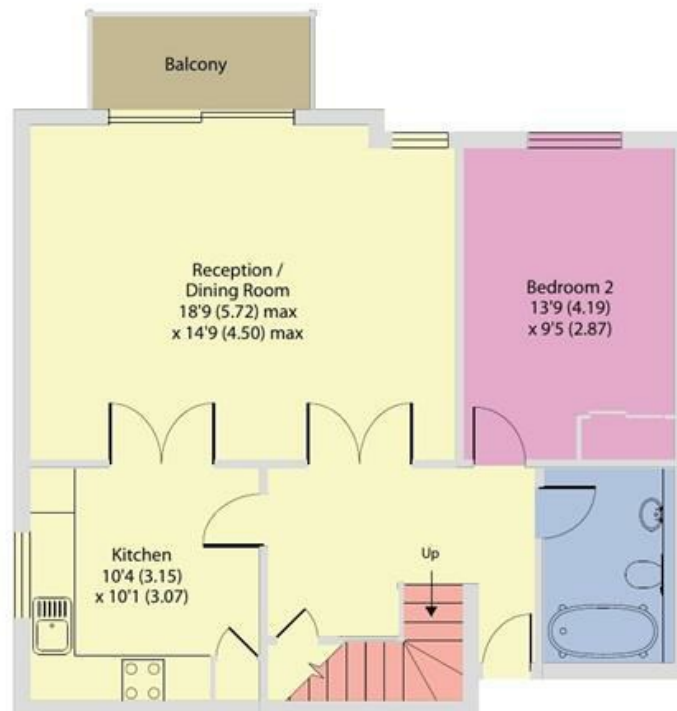

SECOND FLOOR



Floor plan produced in accordance with RICS Property Measurement 2nd Edition, Incorporating International Property Measurement Standards (IPMS2 Residential). Produced for Camerons Stiff & Co. REF: 538231. © nichecom 2025.

EPC: D

Ref: 15083676