



Keyes Road, NW2

£1,650 Per Calendar Month

AVAILABLE TO LET is this beautifully presented one bedroom First Floor Flat, offering 383 sq ft of stylish accommodation, situated within the highly sought after Mapesbury Conservation Area.

- Stylish 1 bedroom, 1 bathroom First Floor Flat
- Offering 383 sq ft of accommodation
- Bay fronted reception room
- Modern kitchen with breakfast bar
- Plenty of natural light throughout
- High ceilings & hard wood floors
- Transport: Willesden Green Station (Jubilee - Zone 2)
- DEPOSIT: £1,903. Council: Brent (C)
- Viewing is highly recommended



020 8450 9377 - 020 8459 1133
rentals@cameronsstiff.co.uk

Keyes Road, NW2

Approx Gross Internal Area = 35.6 sq m / 383 sq ft

For identification only - Not to scale

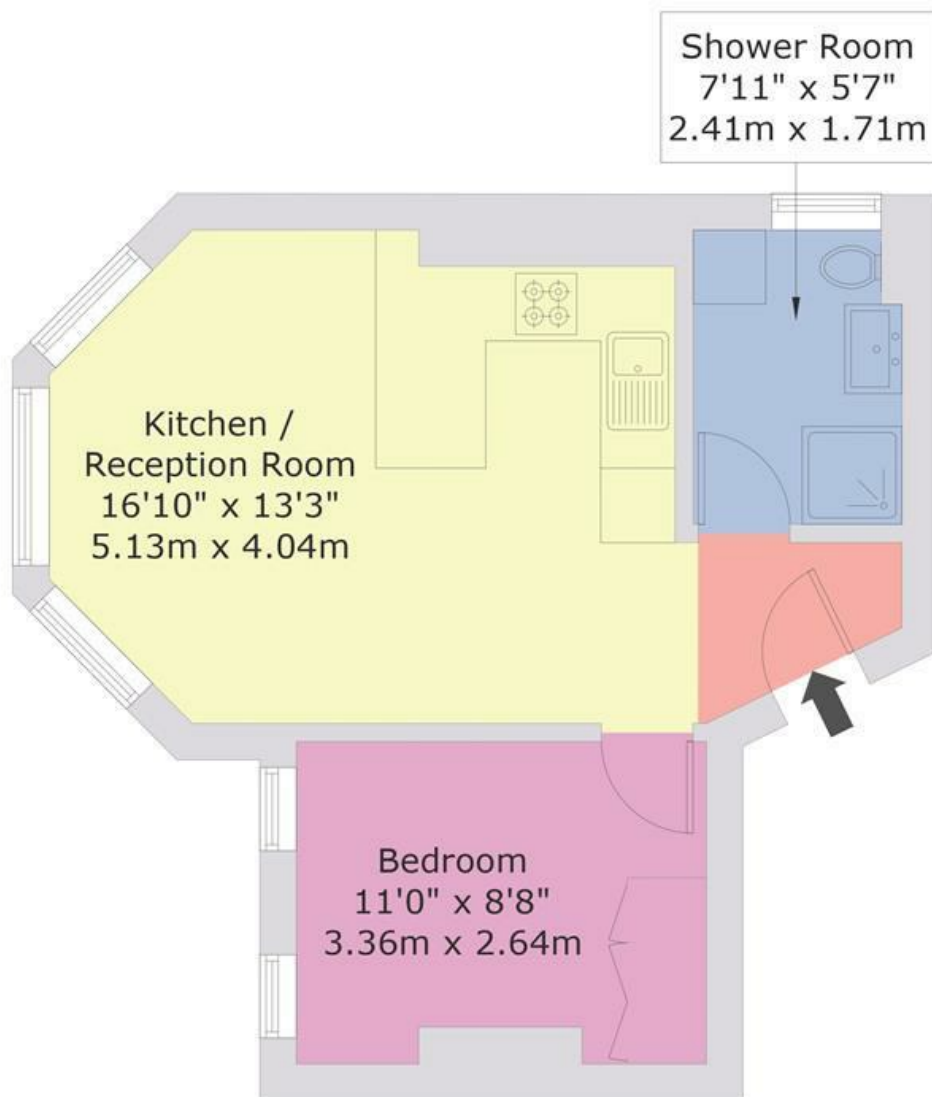

FIRST FLOOR



This floor plan is produced in accordance with RICS Property Measurement Standards incorporating International Property Measurement Standards (IPMS2 Residential). Maximum lengths and widths are represented on the floor plan. Produced for Cameron Stiff & Co. Copyright © BLEUPLAN

EPC: D

Ref: 18684960

