



## Honeyman Close, NW6

£4,700 Per Month

AVAILABLE TO LET is this beautifully presented four bedroom, three storey Townhouse, offering 1866 sq ft of bright and airy accommodation, situated within a purpose built gated development in the heart of Brondesbury Park.

- Stunning 4 bedroom, 4 bathroom townhouse
- 1866 sq ft of stylish accommodation
- Spacious modern fitted kitchen
- Private rear garden & off-street parking
- Hard wooden flooring throughout
- Private residents gym & swimming pool
- Willesden Green (Jubilee - Zone 2)
- Council: Brent (G)
- Deposit: £5,423
- Viewing is highly recommended



020 8450 9377 - 020 8459 1133  
[rentals@cameronsstiff.co.uk](mailto:rentals@cameronsstiff.co.uk)

## Honeyman Close, London, NW6

Approximate Area = 1866 sq ft / 173.4 sq m

For identification only - Not to scale

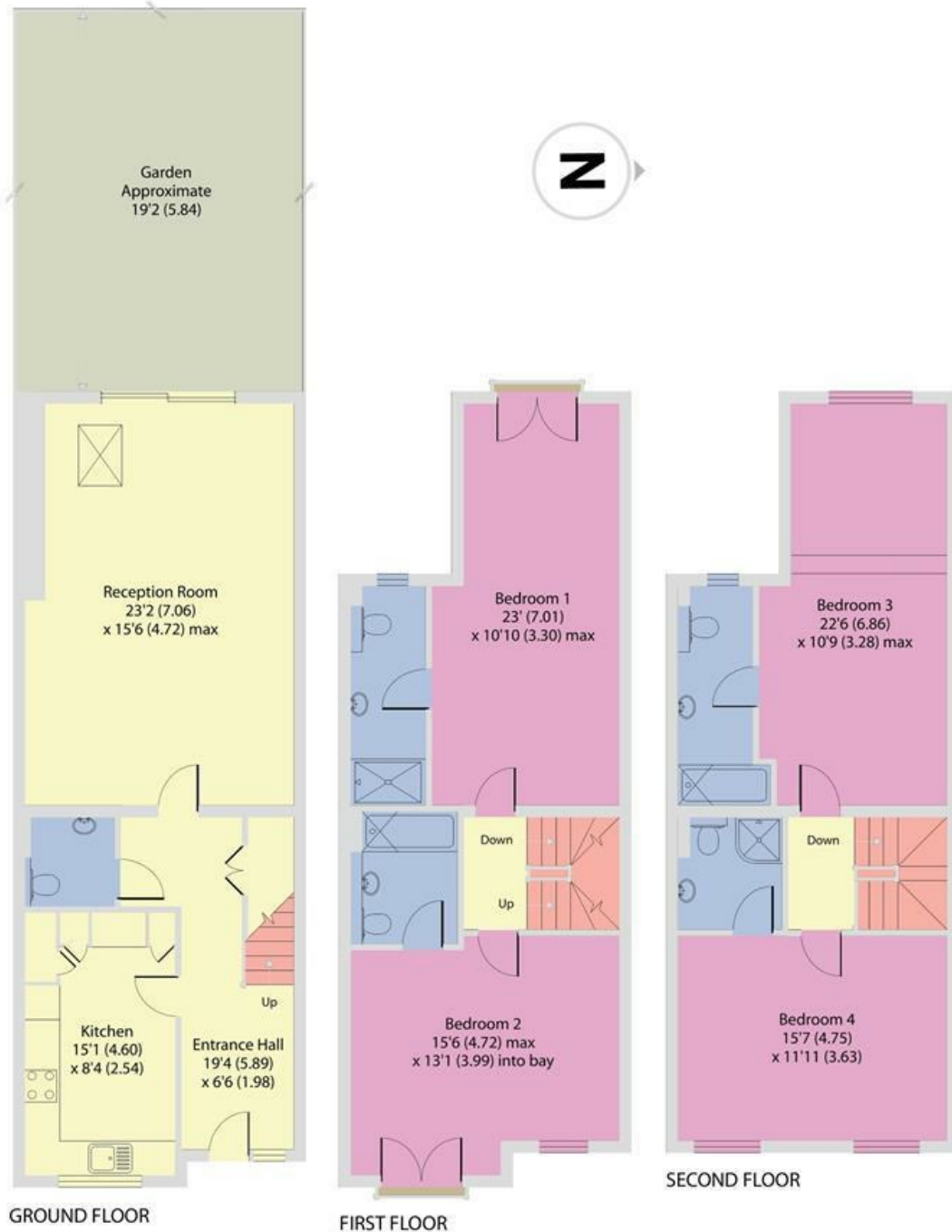

Floor plan produced in accordance with RICS Property Measurement 2nd Edition, Incorporating International Property Measurement Standards (IPMS2 Residential). © nchecom 2025. Produced for Camerons Stiff & Co. REF: 834032

**EPC: D**

Ref: 18026434

