



Woodbridge Close, NW2 TO LET - £2,000 Per Month

AVAILABLE TO RENT is this spacious two bedroom house, situated on a quiet residential cul-de-sac in Dollis Hill.

Offering 907 sq ft of well laid out accommodation, the Ground Floor comprises a separate kitchen with fitted appliances, a bright reception room with double doors leading out to the private 24 ft garden. The First Floor offers two spacious double bedrooms which are serviced by a W/C and bathroom.

Woodbridge Close is well located close to Gladstone Park, with excellent links via newly opened Brent Cross West (Thameslink - Zone 3), Willesden Green, Kilburn (Jubilee - Zone 2), and the nearby North Circular.

- Spacious 2 bedroom house
- Offering 907 sq ft of accommodation
- Private garden
- COUNCIL: Brent (D)
- Deposit: £2,307

020 8450 9377
rentals@cameronsstiff.co.uk
cameronsstiff.co.uk



Woodbridge Close, NW2

Approx Gross Internal Area = 84.24 sq m / 907 sq ft
For identification only - Not to scale

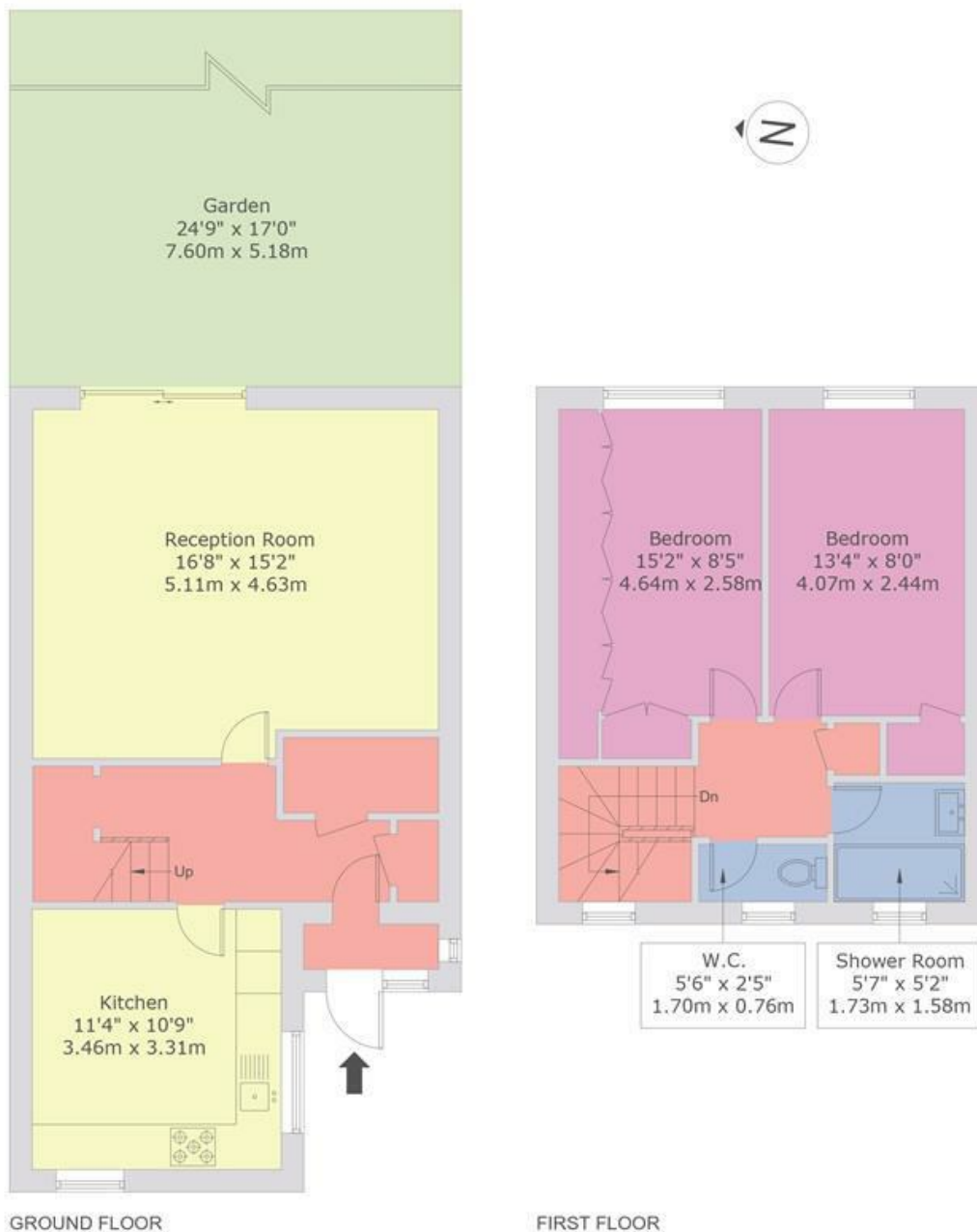

This floor plan is produced in accordance with RICS Property Measurement Standards incorporating International Property Measurement Standards (IPMS2 Residential).
Produced for Cameron Stiff & Co.
Copyright © BLEUPLAN

EPC:

Ref: 19431471