



## Walm Lane, NW2

TO LET - £1,600

AVAILABLE TO LET is this well presented First Floor, one bedroom flat situated within a converted period property situated within walking distance of Willesden Green Station.

Offering 461 sq ft of accommodation, the property comprises a bright reception room with high ceilings and plenty of storage space, the kitchen includes fitted appliances and a spacious bedroom which is serviced by a three piece bathroom.

Walm Lane is a tree-lined street within a short walk to the amenities found on Willesden High Road and Walm Lane. Excellent transport links via Willesden Green & Kilburn (Jubilee - Zone 2) and Cricklewood Thameslink Station .

- First Floor Flat providing 461 sq ft
- Large, bright reception room
- High ceilings, laminated flooring
- Transport: Willesden Green (Jubilee- Zone 2)
- COUNCIL: Brent (C)
- Deposit: £1,846

020 8450 9377

[rentals@cameronsstiff.co.uk](mailto:rentals@cameronsstiff.co.uk)

[cameronsstiff.co.uk](http://cameronsstiff.co.uk)



Walm Lane, London, NW2

Approximate Area = 461 sq ft / 42.8 sq m

For identification only - Not to scale

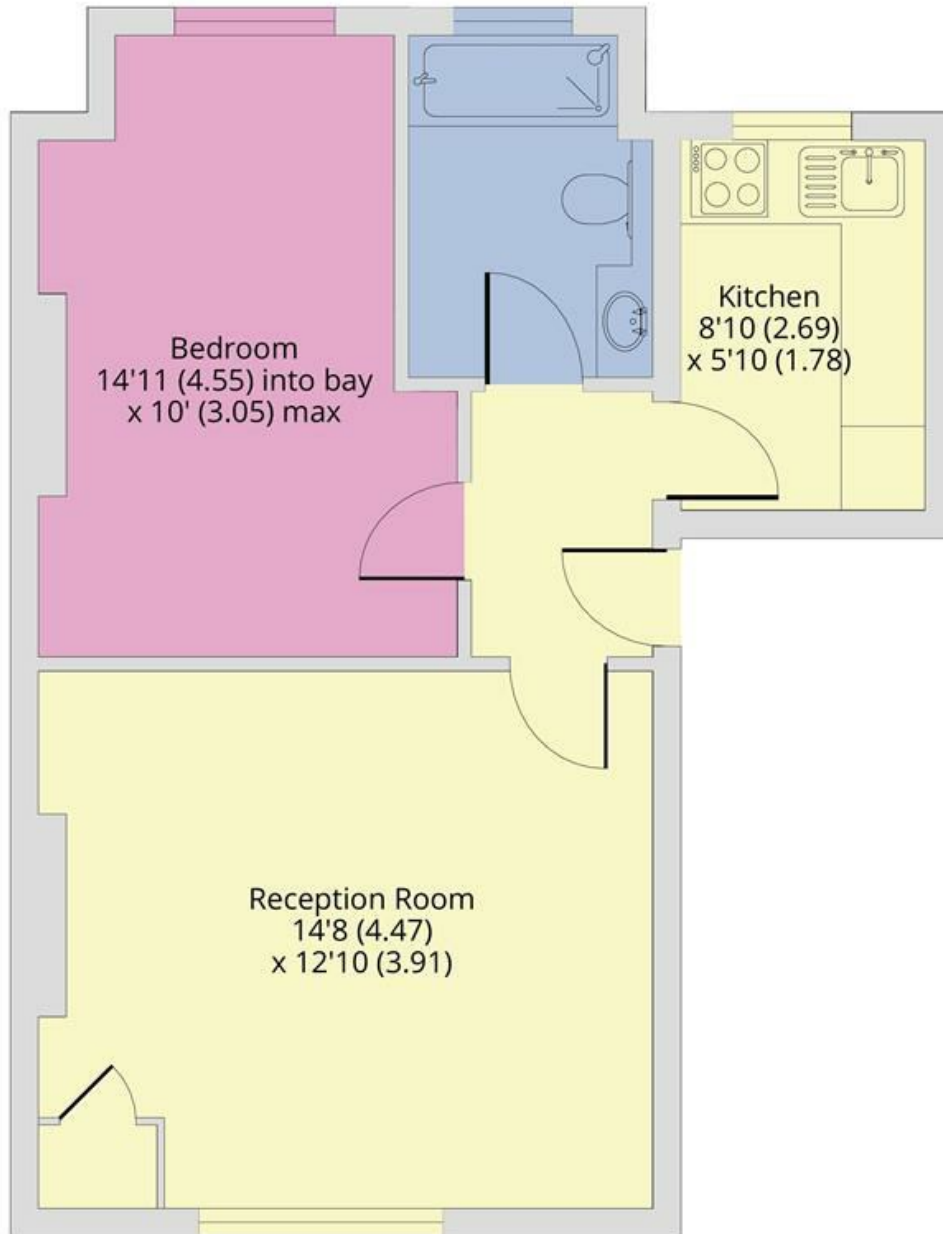

FIRST FLOOR



Floor plan produced in accordance with RICS Property Measurement Standards incorporating International Property Measurement Standards (IPMS2 Residential). © nichecom 2024. Produced for Camerons Stiff & Co. REF: 1075009

EPC: C

Ref: 19370205

