



Wrotesley Road, NW10

TO LET - £2,800 Per Month

AVAILABLE TO LET is this bright and spacious three bedroom First Floor apartment, situated within this period conversion property located in the sought after Kensal Rise.

Offering 859 sq ft of accommodation, the flat comprises of a large open plan kitchen/reception room with bay windows, three generously sized bedrooms which are serviced by a modern three piece bathroom and a private terrace.

Wrotesley Road is close to Kensal Green Station (Bakerloo Line - Zone 2) with direct links to the City & West End. Shopping facilities include Brent Cross Shopping Centre & Westfield Shopping Centre.

- Spacious 3 bedroom First Floor Flat
- Offering 859 sq ft of accommoation
- Private terrace
- Transport: Kensal Green (Bakerloo-Zone 2)
- Deposit: £3,230
- COUNCIL: Brent (D)

020 8450 9377

rentals@cameronsstiff.co.uk

cameronsstiff.co.uk



Wrotesley Road, NW10

Approx Gross Internal Area = 79.8 sq m / 859 sq ft

Terrace = 7.8 sq m / 84 sq ft

Total = 104.5 sq m / 1125 sq ft

For identification only - Not to scale

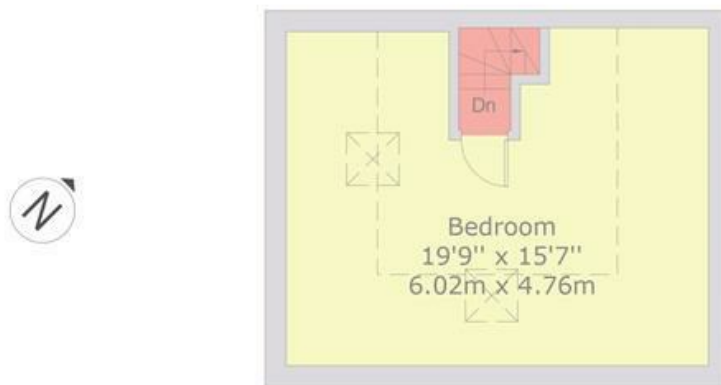

SECOND FLOOR

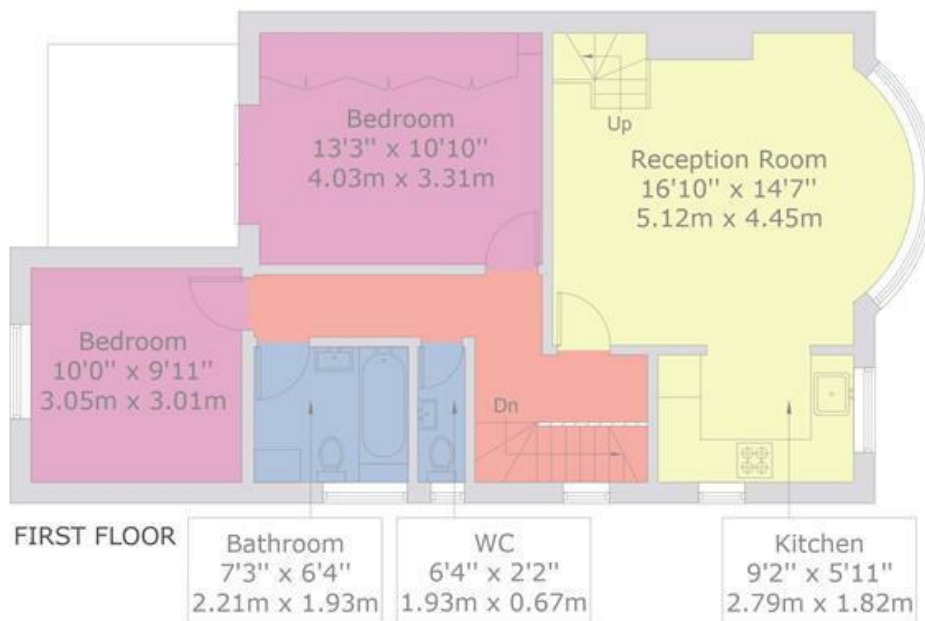

FIRST FLOOR



GROUND FLOOR



This floor plan is produced in accordance with RICS Property Measurement Standards incorporating International Property Measurement Standards (IPMS2 Residential).
Produced for Cameron Stiff & Co.
Copyright © BLEUPLAN

EPC: D

Ref: 18885909

