



Mount Pleasant Road, NW10

TO LET - £3,750 Per Month

AVAILABLE TO RENT NOW is this outstanding semi-detached house located in a convenient position on the borders of Queens Park and within walking distance to Willesden Green.

Arranged over 1506 sq ft, the accommodation has been well maintained throughout and consists of two reception rooms, a kitchen/diner and a cloakroom with access to the rear garden. On the First Floor there are four bedroom (one en-suite) and a family bathroom. Externally, there is a 107 ft southwesterly facing garden and off street parking. The house benefits from wooden flooring throughout, some period features and off-street parking.

Kensal Rise, Brondesbury Park Overground and Willesden Green (Jubilee Line - Zone 2) are the closest stations for quick access to central London. Queens Park is a short walk away where you will find numerous bars, shops and restaurants.

- 4 bedroom semi detached house
- Offering 1506 sq ft of accommodation
- 107 ft south westerly-facing garden
- Council - Brent (F)
- Deposit - £4,326

020 8450 9377

rentals@cameronsstiff.co.uk

cameronsstiff.co.uk



Mount Pleasant Road, London, NW10

Approximate Area = 1506 sq ft / 139.9 sq m

Garage = 133 sq ft / 12.4 sq m

Total = 1639 sq ft / 152.3 sq m

For identification only - Not to scale

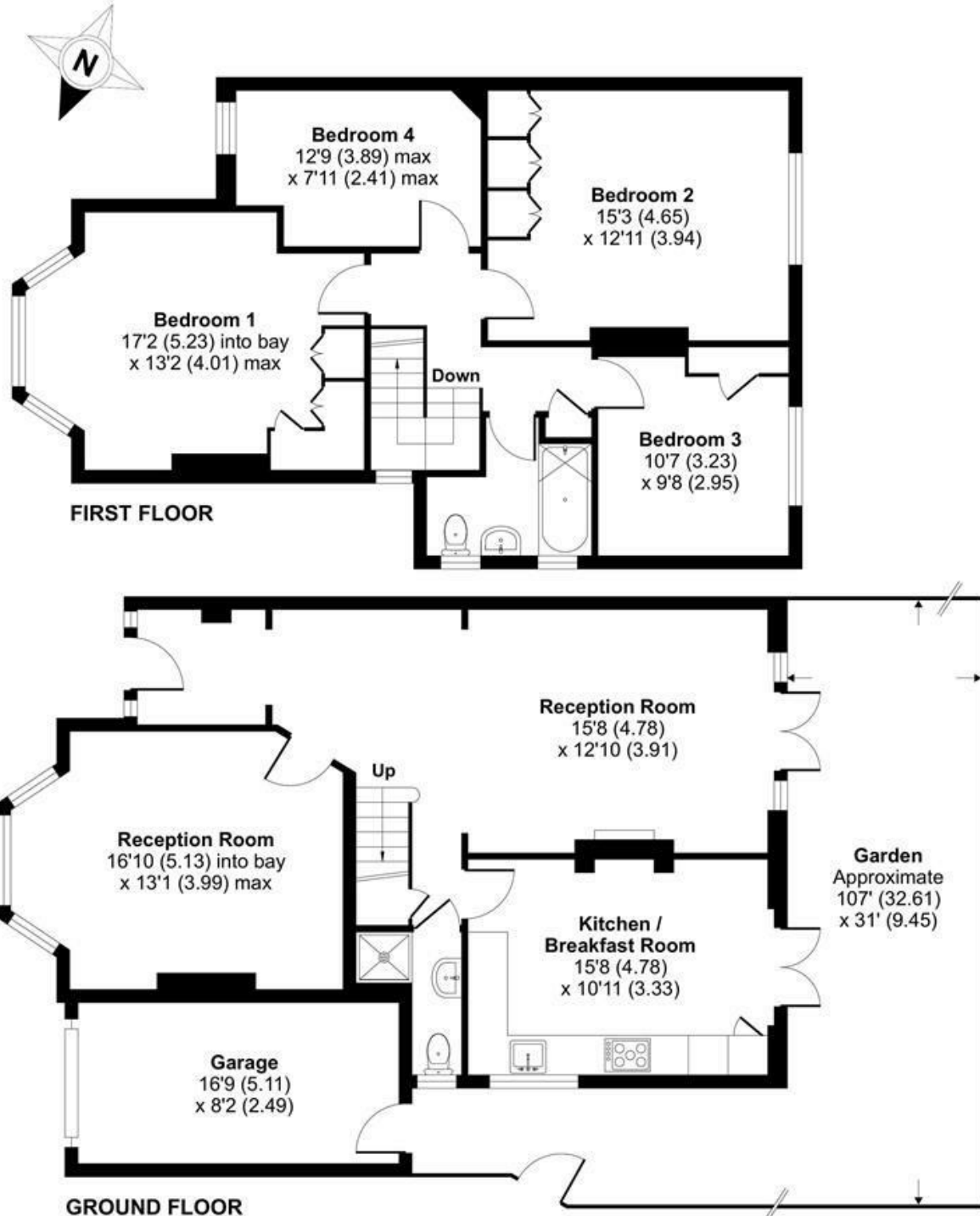

Floor plan produced in accordance with RICS Property Measurement Standards incorporating International Property Measurement Standards (IPMS2 Residential). © nichecom 2023. Produced for Camerons Stiff & Co. REF: 1039811

EPC: D

Ref: 18819104