



## Brondesbury Road, NW6

### TO LET - £1,650

AVAILABLE TO LET is this well presented one bedroom flat, set within a charming Period conversion, situated on a pretty tree lined street in the heart of Queens Park.

Offering 397 sq ft of well laid out accommodation, the property comprises a bright reception room with hard wood flooring, a separate fully fitted kitchen and a spacious bedroom which is serviced by a three piece bathroom suite. The property is offered furnished, with tasteful and practical furnishings that complement the space.

Brondesbury Road is conveniently located near Salusbury Road, offering excellent transport links, including Queens Park Station (Bakerloo & Overground/Lioness line - Zone 2), and vibrant social amenities.



- Charming 1 bedroom Second Floor Flat
- Offering 397 sq ft of accommodation
- Separate fully fitted kitchen
- Queens Park (Bakerloo-Zone 2)
- COUNCIL: Brent (C)
- Deposit: £1,903

020 8450 9377

[rentals@cameronsstiff.co.uk](mailto:rentals@cameronsstiff.co.uk)

[cameronsstiff.co.uk](http://cameronsstiff.co.uk)



## Brondesbury Road, NW6

Approx Gross Internal Area = 36.9 sq m / 397 sq ft

Restricted head height = 2.3 sq m / 25 sq ft

Total = 39.2 sq m / 422 sq ft

For identification only - Not to scale



= Reduced headroom below 1.5m / 5'0"

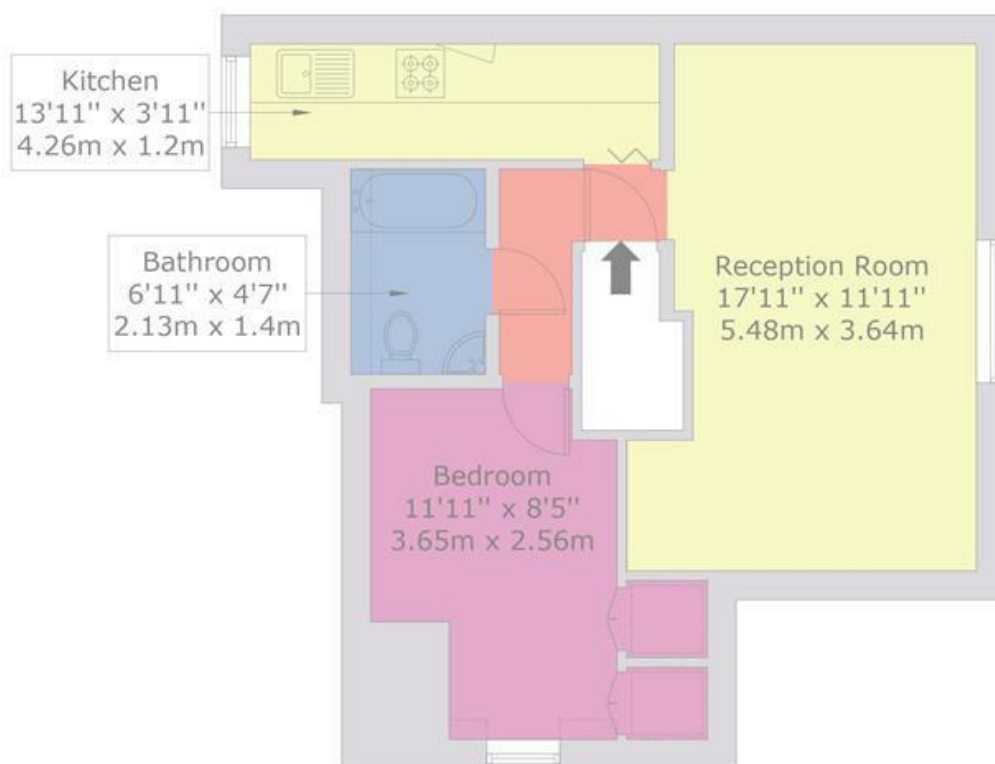

### SECOND FLOOR



This floor plan is produced in accordance with RICS Property Measurement Standards incorporating International Property Measurement Standards (IPMS2 Residential). Maximum lengths and widths are represented on the floor plan.  
Produced for Cameron Stiff & Co.  
Copyright © BLEUPLAN

EPC: D

Ref: 19360174

