



## Grange Road, NW10

### TO LET - £2,250 Per Month

AVAILABLE TO LET is this well presented three bedroom apartment, set within an attractive Edwardian apartment block on the cusp of the Dobree Estate.

Offering 694 sq ft of accommodation, the property comprises a kitchen and generous reception room and three double bedrooms which are serviced by a three piece bathroom suite.

Victoria Mansions is located on Grange Road, which is moments from Roundwood Park and King Edward VII park. The amenities of Kensal Rise, Willesden Green and Queen's Park are close by. Local transport links include Willesden Green (Jubilee; Zone 2) and Kensal Rise (Overground).

- A well presented 3 bedroom apartment.
- Offers 694 sqft of internal living accommodation.
- Access to a spacious communal garden.
- Close to Kensal Rise and Willesden Green.
- Council: Brent (F). Deposit: £2,764

020 8450 9377

[rentals@cameronsstiff.co.uk](mailto:rentals@cameronsstiff.co.uk)

[cameronsstiff.co.uk](http://cameronsstiff.co.uk)



## Grange Road, NW10

Approx Gross Internal Area = 64.5 sq m / 694 sq ft

For identification only - Not to scale

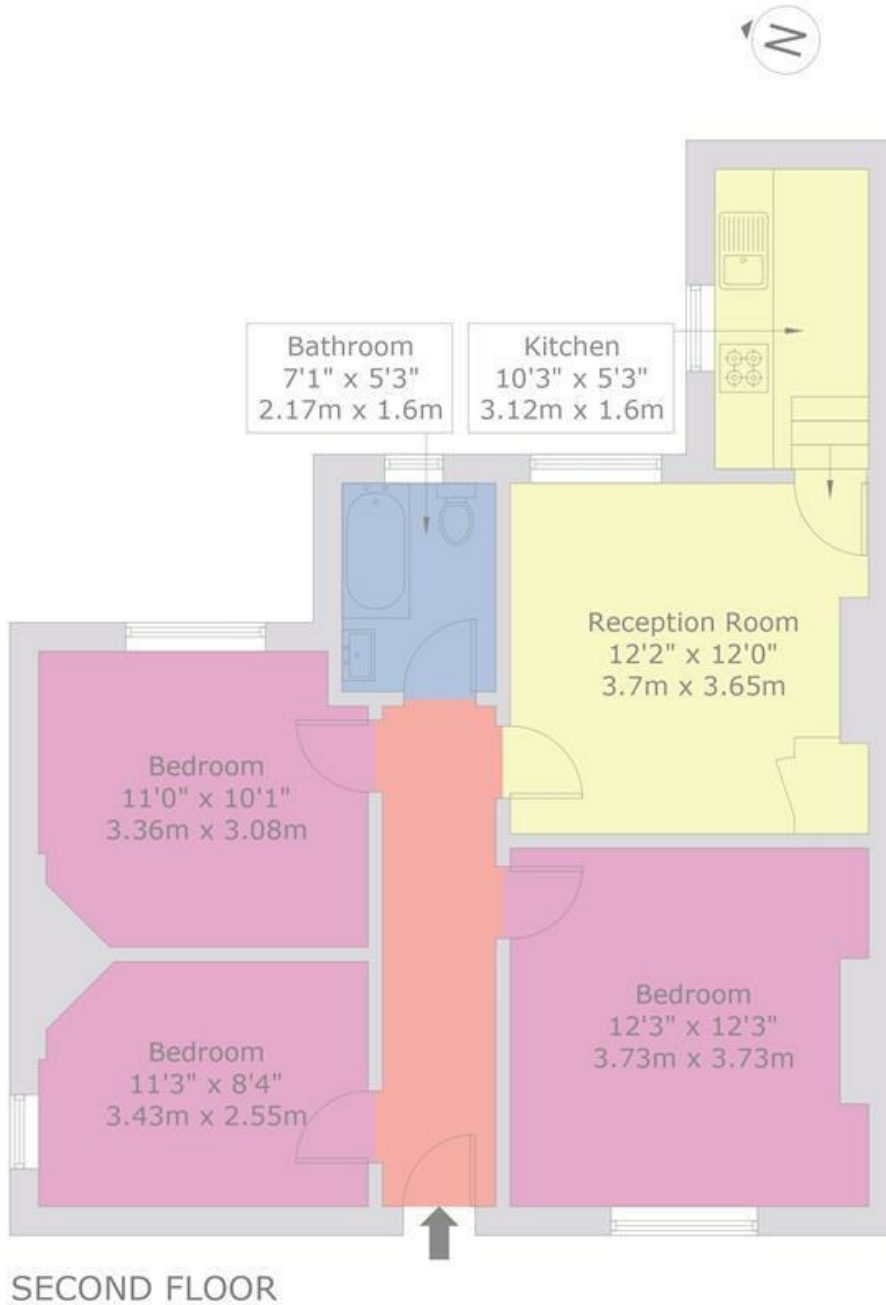

This floor plan is produced in accordance with RICS Property Measurement Standards incorporating International Property Measurement Standards (IPMS2 Residential). Maximum lengths and widths are represented on the floor plan.  
Produced for Cameron Stiff & Co.  
Copyright © BLEUPLAN

**EPC: D**

Ref: 19356102

