



Fordwych Road, NW2

TO LET - £2,500

AVAILABLE TO LET is this bright and spacious two bedroom Garden Flat, situated on a pretty tree lined street, Fordwych Road.

Offering 790 sq ft of well laid out accommodation, the property comprises a bright bay fronted reception room with a feature fireplace and hard wood floors, a separate fitted kitchen and two double bedrooms which are serviced by a three piece bathroom. Further benefits include a beautiful private garden and off-street parking.

Fordwych Road is very conveniently located close to West Hampstead with its superb High Street, West End Lane offers a variety of local independent deli's, bars, and restaurants along with excellent transport links including Kilburn (Jubilee-Zone 2) underground and overground stations.

- 2 bedroom Garden Flat
- Offering 790 sq ft of accommodation
- Private rear garden
- Kilburn (Jubilee-Zone 2)
- COUNCIL: Camden (D)
- Deposit: £3,057

020 8450 9377

rentals@cameronsstiff.co.uk

cameronsstiff.co.uk



Fordwych Road, NW2

Approx Gross Internal Area = 73.4 sq m / 790 sq ft

For identification only - Not to scale

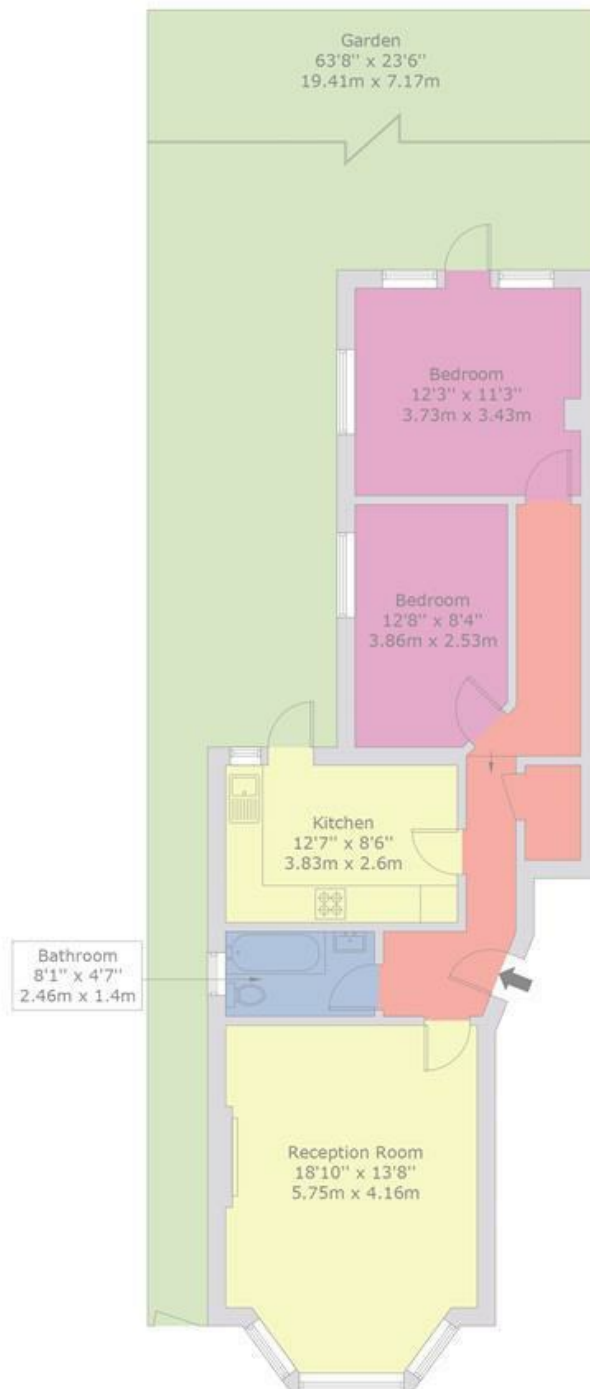

GROUND FLOOR



This floor plan is produced in accordance with RICS Property Measurement Standards incorporating International Property Measurement Standards (IPMS2 Residential). Maximum lengths and widths are represented on the floor plan.
Produced for Cameron Stiff & Co.
Copyright © BLEUPLAN

EPC: D

Ref: 19319349

